



Springwell Avenue, London NW10

£375,000 Leasehold

Welcome to Springwell Avenue – One of Harlesden's Prime Roads. This fully refurbished, split-level apartment is a fantastic opportunity for those seeking modern living in a vibrant area. The property comprises a spacious open-plan kitchen and living area, perfect for entertaining or relaxing, two generously sized double bedrooms, and a contemporary bathroom. Located on the desirable Springwell Avenue, the property is just a short walk from the beautiful open spaces of Roundwood Park, ideal for outdoor activities and relaxation. The location also offers excellent transport links, with Willesden Junction (Bakerloo Line & Overground – Zone 2) only a short distance away, providing quick and easy access to central London. A variety of bus routes are also within reach for added convenience. The property is sold chain-free and benefits from a 125-year lease, offering peace of mind for years to come.

- Period conversion
- Two bedrooms
- Recently renovated to a high standard
- Open plan kitchen living area
- Split level
- Great Location
- Long lease 125 years
- Chain free
- Short walk to open green spaces of Roundwood Park
- Close to shops and transport

SPRINGWELL AVENUE, NW10 4HP

Approximate Gross Internal Area = 62.4 sq.m / 671 sq.ft

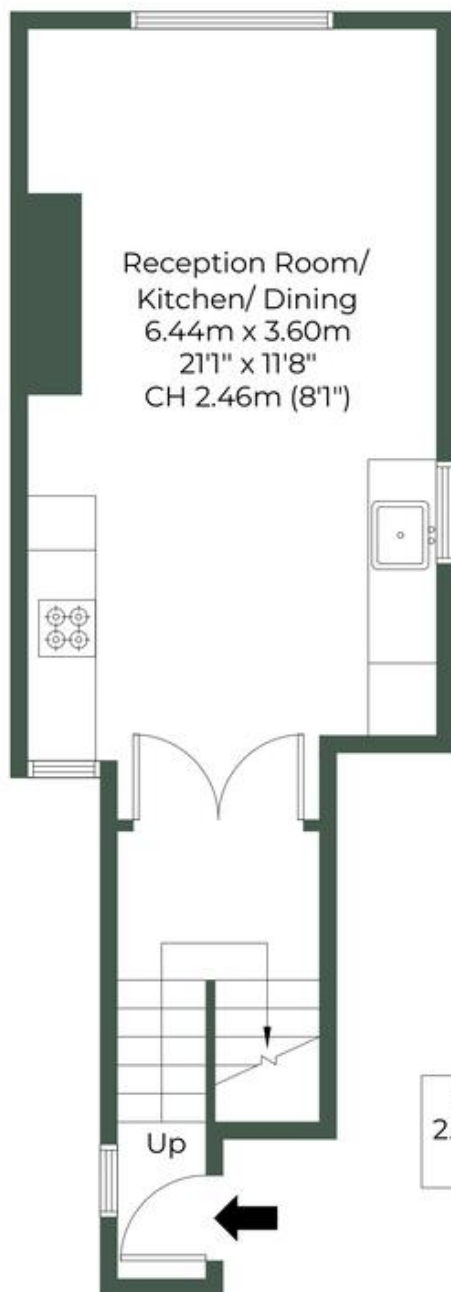

First Floor

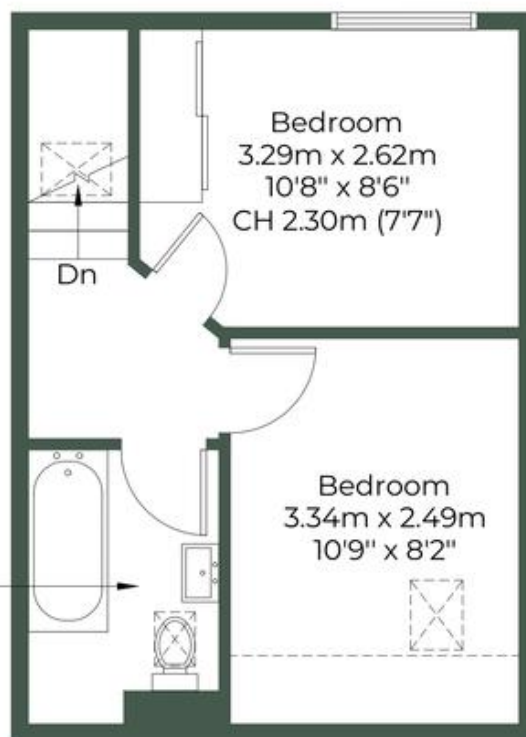

Second Floor



= Reduced headroom below 1.5m / 5'0"

M MILE

MONEY LAUNDERING REGULATIONS 2003: Intending purchasers will be asked to produce identification documentation at a later stage and we would ask for your co-operation in order that there will be no delay in agreeing the sale.

General: While we endeavour to make our sales particulars fair, accurate and reliable, they are only a general guide to the property and, accordingly, if there is any point which is of particular importance to you, please contact the office and we will be pleased to check the position for you, especially if you are contemplating travelling some distance to view the property.

Measurements: These approximate room sizes are only intended as general guidance. You must verify the dimensions carefully before ordering carpets or any built-in furniture.

Services: Please note we have not tested the services or any of the equipment or appliances in this property, accordingly we strongly advise prospective buyers to commission their own survey or service reports before finalising their offer to purchase.