



MILE



MILE



MILE



MILE



MILE

## Odessa Road, London NW10 £550,000 Leasehold

Welcome to Odessa Road. Discover this unique opportunity to own a charming first-floor property on the highly sought-after Odessa Road. This delightful residence offers the perfect blend of comfort and convenience, with its own private entrance and a quiet, tranquil setting. Boasting three generously sized double bedrooms and a further single bedroom, this spacious 912 sq ft home provides ample living space for families and professionals alike. The thoughtful layout ensures a harmonious flow throughout, making it ideal for both relaxation and entertaining. With its own private entrance, you can enjoy the privacy and convenience of your own space, adding to the home's unique charm. Set on a quiet road, this property offers a retreat from the hustle and bustle of city life. Additionally, the property is chain-free, ensuring a smooth and swift transaction. This property presents an exceptional opportunity to reside in a vibrant and well-connected area while enjoying the tranquility of a quiet residential road. Don't miss out on making this wonderful home your own. Contact us today to arrange a viewing and experience all that this remarkable property has to offer.

- Period property
- First floor
- Three bedrooms
- Further single bedroom
- Loft is demised
- Chain free
- Quiet residential road
- 912 sq ft
- Leasehold
- Close to shops and transport

# ODESSA ROAD, NW10 5YH

Approximate Gross Internal Area = 84.7 sq.m / 912 sq.ft

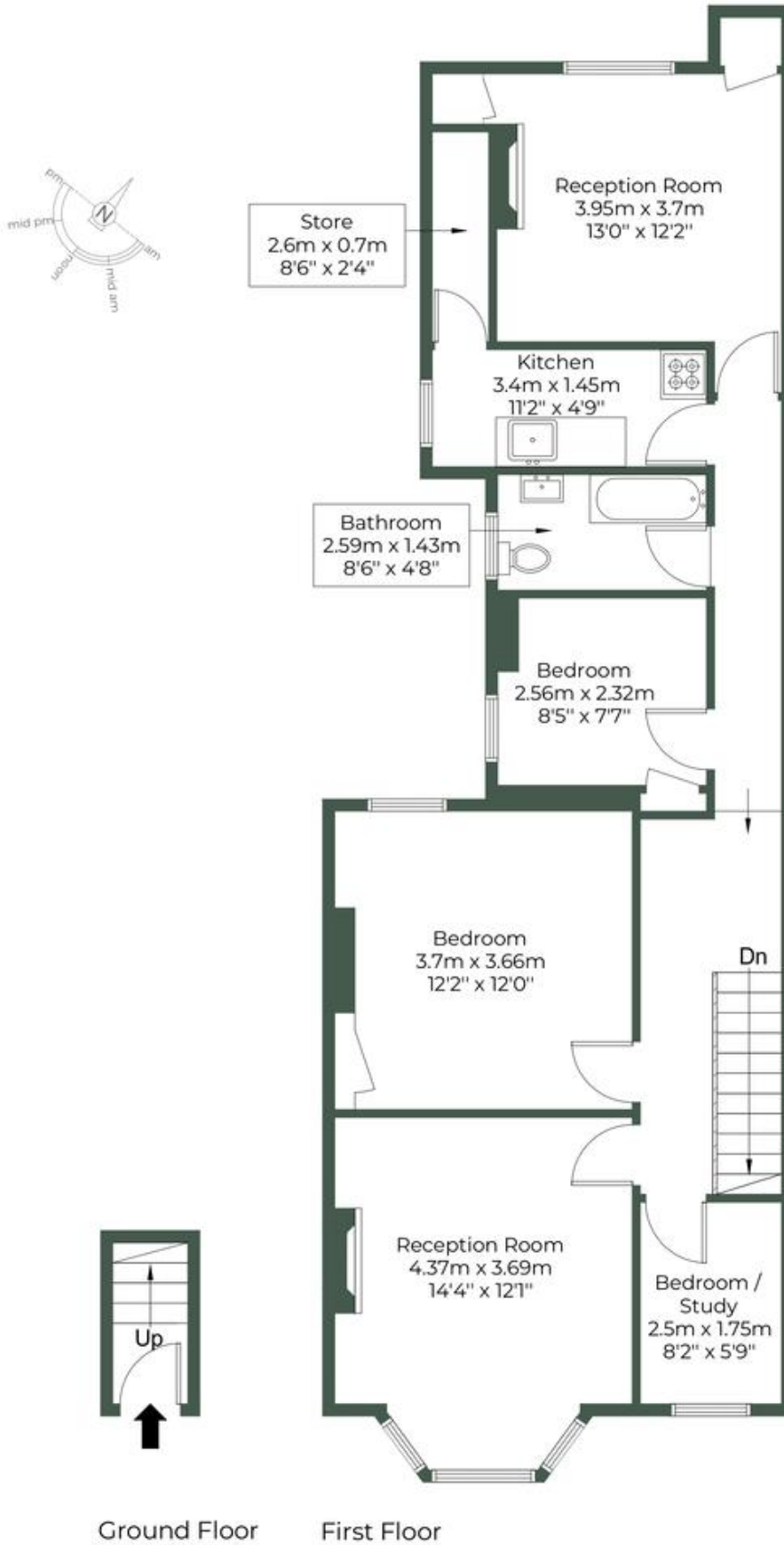

Ground Floor

First Floor



**MONEY LAUNDERING REGULATIONS 2003:** Intending purchasers will be asked to produce identification documentation at a later stage and we would ask for your co-operation in order that there will be no delay in agreeing the sale.

**General:** While we endeavour to make our sales particulars fair, accurate and reliable, they are only a general guide to the property and, accordingly, if there is any point which is of particular importance to you, please contact the office and we will be pleased to check the position for you, especially if you are contemplating travelling some distance to view the property.

**Measurements:** These approximate room sizes are only intended as general guidance. You must verify the dimensions carefully before ordering carpets or any built-in furniture.

**Services:** Please note we have not tested the services or any of the equipment or appliances in this property, accordingly we strongly advise prospective buyers to commission their own survey or service reports before finalising their offer to purchase.