



to let

commercial

Unit 2, The Ropewalk, Ilkeston, DE7 5HX

Light Industrial Unit To Let





ROY PETERS ESTATES

01246 272740 | 01246 236798

enquiries@roypeters.com

roypeters.com

[roypetersstateschesterfield](#) 
[roy-peters-estates-chesterfield](#) 
[roypeterschesterfield](#) 

Unit 2, The Ropewalk, Ilkeston, DE7 5HX

Located within a secure, gated business park, this light industrial unit offers practical workspace with convenient access.

Features include a front-facing roller shutter door, separate pedestrian entrance, WC facilities, and allocated parking.

Rent

£9,770 pa

Accommodation

Ground Floor – 977 ft²

Business Rates

The property is currently listed on the Valuation Office Agency website with a rateable value of £4,900 per annum. (Eligible businesses may benefit from small business rate relief.)

Location

Ilkeston is Derbyshire's third-largest town, positioned under 5 miles from the M1 motorway. This well-connected and sought-after location lies just 9 miles from Derby and 8 miles from Nottingham, offering excellent access to both cities' retail and business hubs.

What 3 Words

Code: ///ends.truly.riding

EPC

Available on request

Legal costs

Each party to bear their own costs.

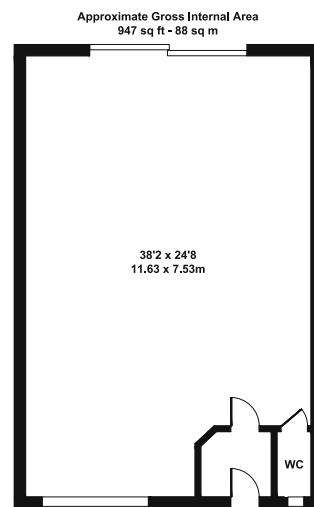

Not to Scale. Produced by The Plan Portal 2025
For Illustrative Purposes Only.

MISREPRESENTATION ACT 1991

Roy Peters Estates (and their Joint Agents where applicable) for themselves and for the vendors or lessors of this property [or whom they act, give notice that:

- (i) these particulars are a general outline, [or the guidance of prospective purchasers or and do not constitute the whole or any part of] an offer or contract;
- (ii) Roy Peters Estates cannot guarantee the accuracy of any description, dimensions, references to condition, necessary permissions [or use and occupation and other details contained herein and prospective purchasers or tenants must not rely on them as statements of fact or representations and must satisfy themselves as to their accuracy;
- (iii) no employee of Roy Peters Estates (and their Joint Agents where applicable) has any authority to make or give any representation or warranty to enter into any contract whatever in relation to the property;
- (iv) prices / rent quoted in these particulars may be subject to VAT in addition; and
- (v) Roy Peters Estates will not be liable, in negligence or otherwise, [or any loss arising from the use of the particulars.



Viewing

Strictly by prior appointment with the sole agent Roy Peters Estates

ROY PETERS ESTATES
01246 272740 | 01246 236798
enquiries@roypeters.com

