



Cureton Street, Westminster
London SW1P

GARTONJONES.COM

Cureton Street, Westminster London, SW1P

GARTON JONES.COM

49 Marsham Street Lettings:
London +44 (0) 20 7340 0480
SW1P 3DP westminster@gartonjones.com
www.gartonjones.com

£425 Per Week

A well presented studio apartment available to rent in this pretty red brick period building in the sought after, Millbank Estate. This furnished property comprises a reception room with a feature fireplace, a good size separate eat-in kitchen, contemporary bathroom with shower over bath and gas central heating. Wilkie House is located on Cureton Street and was named after the distinguished painter Sir David Wilkie. The development is situated behind The Tate Gallery and is only moments from the River Thames and other London attractions such as the Houses of Parliament, Big Ben and The London Eye. The transport links of St James's Park, Pimlico, Westminster and Victoria are all within walking distance. The area has an abundance of amenities including Sainsbury's, Tesco, Waitrose, Marks & Spencer's and a Curzon Cinema plus following on from the extensive regeneration of Victoria street a selection of many new restaurants to compliment existing ones such as The Cinnamon Club and many more.

**Please note that the furniture may differ to that shown in the current photos

Council Tax Band C (London Borough of Westminster)
Minimum Term 12 months
5 weeks deposit
EPC Rating: C (74)

- Well Presented Studio Apartment
- Red Brick Development
- 329 Square Feet (30.6 Sq.M)
- 1st Floor
- Modern Separate Eat In Kitchen
- Contemporary Bathroom
- Furnished
- Available: 7th August 2024
- Moments From Pimlico, Westminster and Victoria Transport Links
- Close To Many Amenities



Wilkie House

Approximate Gross Internal Area = 329 sq ft / 30.6 sq m

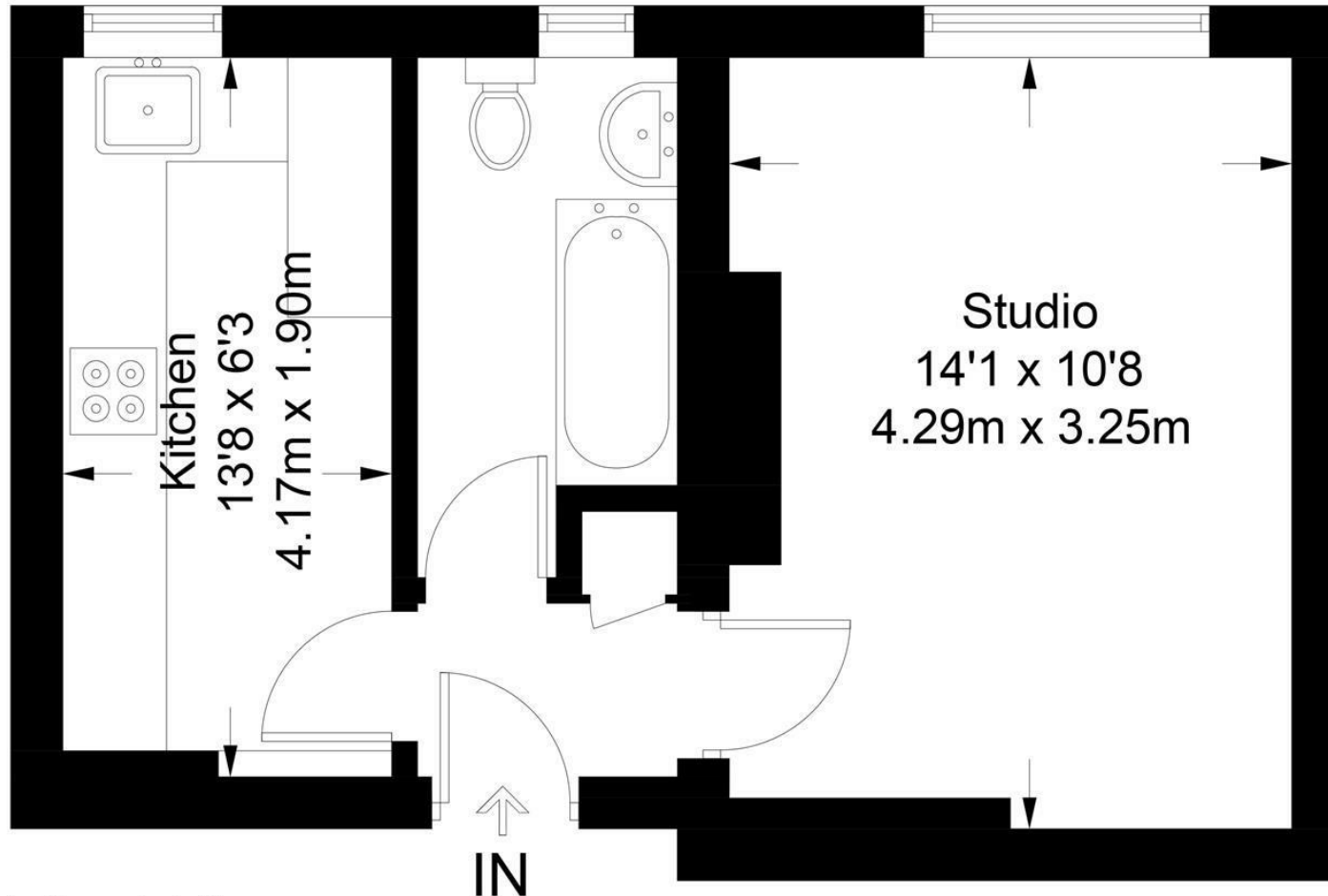

First Floor

Not to scale, for guidance only and must not be relied upon as a statement of fact.
All measurements and areas are approximate only and have been prepared in accordance with the current edition of the RICS Code of Measuring Practice.

