



Central Buildings, Westminster
London SW1H

GARTON JONES.COM



Central Buildings, Westminster London, SW1H

GARTON JONES.COM

49 Marsham Street Sales +44 (0) 20 7340 0480
London westminster@gartonjones.com
SW1P 3DP www.gartonjones.com

£795,000 Leasehold

We are delighted to offer this exceptional one bedroom apartment nestled in one of London's most prestigious neighbourhoods just a stones throw from the historic Parliament buildings. The accommodation offers generous proportions measuring at 768 square feet (71 Sq.M) which comprises of an open plan reception room with a smart integrated kitchen with integrated appliances, large bedroom with ample fitted wardrobes and a modern full bathroom with a separate walk in shower. The local area of Victoria and Westminster offers a selection of exquisite restaurants like Tom Kerridges Bar and Grill, The Ivy, Yaatra at Westminster Fire Station and an array of cafes at Cardinal Place and Nova. Matthew Parker Street is close to a range of historic and cultural amenities ranging from the Tate Britain Gallery, Curzon Cinema and Andrew Lloyd Webber's 'The Other Palace'. The underground transport links of Westminster, St James Park and Victoria Station also provides mainline services to Gatwick. This property would make an ideal property to be used as a city home, pied-a-terre or investment property.

EPC Rating C (74)

Service Charges: £6955 Per Annum

Ground Rent: £250 Per Annum

Long Leasehold: 978 Years Remaining

Council Tax Band G (London Borough of Westminster)

- Extremely Spacious One Bedroom Apartment
- 768 Square Feet (71 Sq.M)
- 4th Floor With Lift
- Reception Room
- Modern Open Plan Kitchen
- Full Bathroom with Separate Shower
- Within The Division Bell for the Houses of Parliament
- 24 Hour Concierge Service
- Minutes From Westminster & St James's Park Transport Links
- Close By, A Selection of Many of Amenities, Bars And Restaurants



EPC certificate available on request.

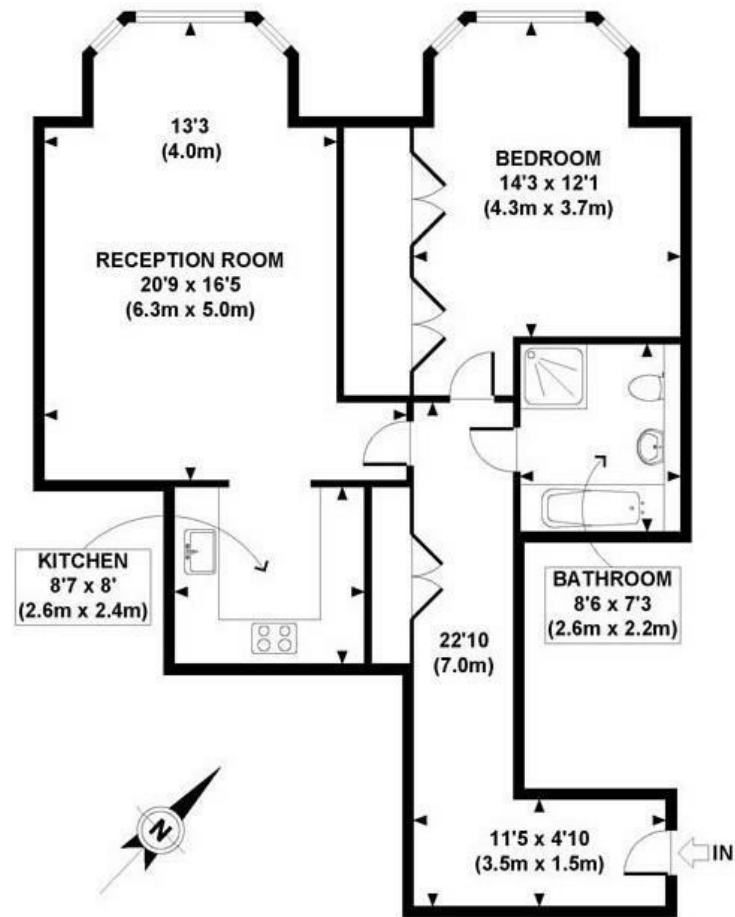

GROSS INTERNAL
FLOOR AREA 768 SQ FT

APPROX. GROSS INTERNAL FLOOR AREA 768 SQ FT / 71 SQ M

