



**LABURNUM ROAD**  
WIMBLEDON

**JACKSON-STOPS** 

---

## LABURNUM ROAD WIMBLEDON, SW19

ASKING PRICE: £3,300 PCM

A beautifully presented four bedroom family home conveniently located in South Wimbledon. Spread over three floors with ample living and storage space, large private garden and close to transport links.

Laburnum Road is located close to many amenities, restaurants and cafes, as well as Sainsbury's Superstore, Aldi and The Gym Group.



### KEY FEATURES

- Four Double Bedrooms
- Study
- Separate Kitchen
- Pretty Private Garden
- High Ceilings
- Feature Fireplaces





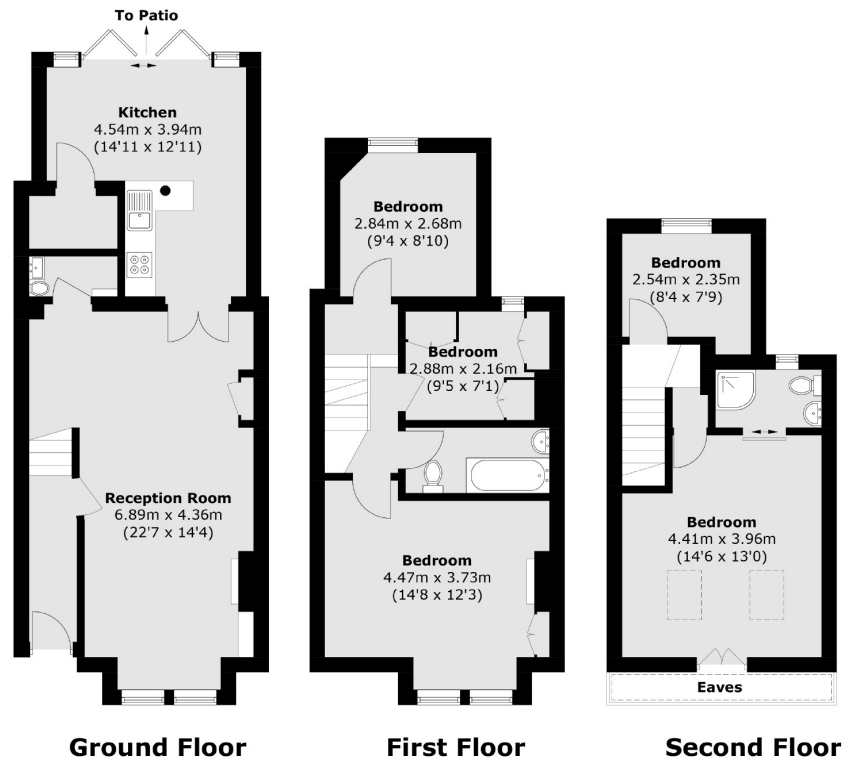

Total area (approx.): 121.9 sq. m (1,312.1 sq. ft)

Energy Rating: D. We aim to make our particulars both accurate and reliable. However they are not guaranteed; nor do they form part of an offer or contract. If you require clarification on any points then please contact us, especially if you are travelling some distance to view. Please note that appliances and heating systems have not been tested and therefore no warranties can be given as to their good working order.

**ASKING PRICE: £3,300 PCM**

WIMBLEDON

020 8879 0099

wimbledon@jackson-stops.co.uk

jackson-stops.co.uk

**JACKSON-STOPS** 