



Whorlesley Road, London, NW10

Guide Price £475,000 Share of
Freehold

harris &
company

Situated on a sought-after residential street in the heart of NW10, Harris and Company are pleased to present this two-bedroom ground floor garden flat.

Occupying the entire ground floor of a handsome Victorian conversion, the property features a spacious reception room with high ceilings and a large bay window, flooding the space with natural light. The separate modern kitchen is well-appointed with ample storage and leads directly out to a private garden — ideal for summer entertaining or a peaceful morning coffee.

Both bedrooms are well-proportioned, with the principal bedroom offering views over the garden and the second bedroom providing flexible space for guests, a home office, or nursery. The family bathroom is finished with contemporary fittings and a clean, neutral palette.

Located just a short walk from Kensal Green Station (Bakerloo Line & Overground) and the green open spaces of Queen's Park, this property offers excellent transport links and access to vibrant local amenities, independent cafés, and boutique shops.

This charming flat is ideal for buyers looking for a home in one of North West London's most desirable pockets.

Share of Freehold. Sole Agent.



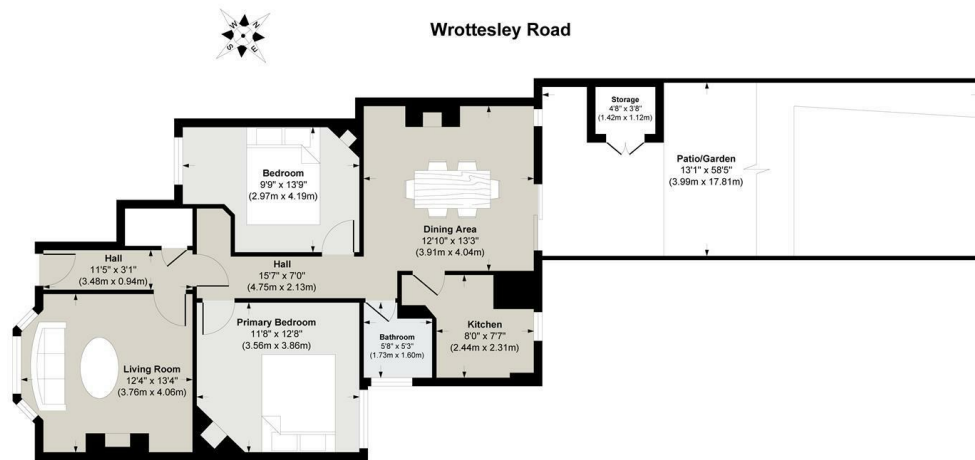

Floor Plan
Approximate Floor Area
806 sq. ft
(75.00 sq. m)

This floor plan was produced for Harris & Company by Visual Imagery. Website:
www.visualimagery.co.uk

While we strive for accuracy in all our floor plans, please note that measurements of doors, windows, and rooms are approximate. Visual Imagery accepts no liability for any errors, omissions, or inaccuracies presented. These plans are intended for illustrative purposes only and should be used as such by any prospective purchaser or lessee. No guarantee is given regarding the gross internal floor area quoted on this plan, and any figures provided should be considered initial estimates only



Disclaimer: These particulars, whilst believed to be accurate are set out as a general outline only for guidance and do not constitute any part of an offer or contract. Intending purchasers should not rely on them as statements of representation of fact, but must satisfy themselves by inspection or otherwise as to their accuracy. No Harris and Company employee has the authority to make or give any representation or warranty in respect of the property. Money laundering regulations 2003: Intending purchasers will be asked to provide identification documentation and we would ask for your co-operation to prevent delays in agreeing the sale.

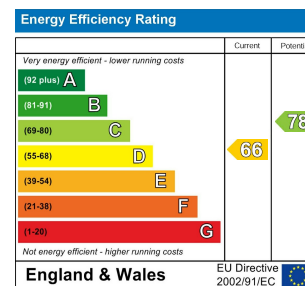

**harris &
company**

106 Chamberlayne Road, Kensal Rise
London NW10 3JN

info@harrisandcompany.co.uk

www.harrisandcompany.co.uk

020 8969 1333