



CONIFERS CLOSE
TEDDINGTON

JACKSON-STOPS

CONIFERS CLOSE, TEDDINGTON, TW11

ASKING PRICE: £375,000

A well presented two double bedroom ground floor apartment. The property offers fantastic living space in the heart of Teddington, there is direct access to a lovely communal garden as well as private parking for residents.

Conifers Close is located just off Kingston Road in close proximity to Hampton Wick and Teddington High Streets with their array of shops, cafes and restaurants. Teddington Mainline Station and Hampton Wick Mainline Stations are also close by as well as plenty of bus routes into Kingston and the surrounding.

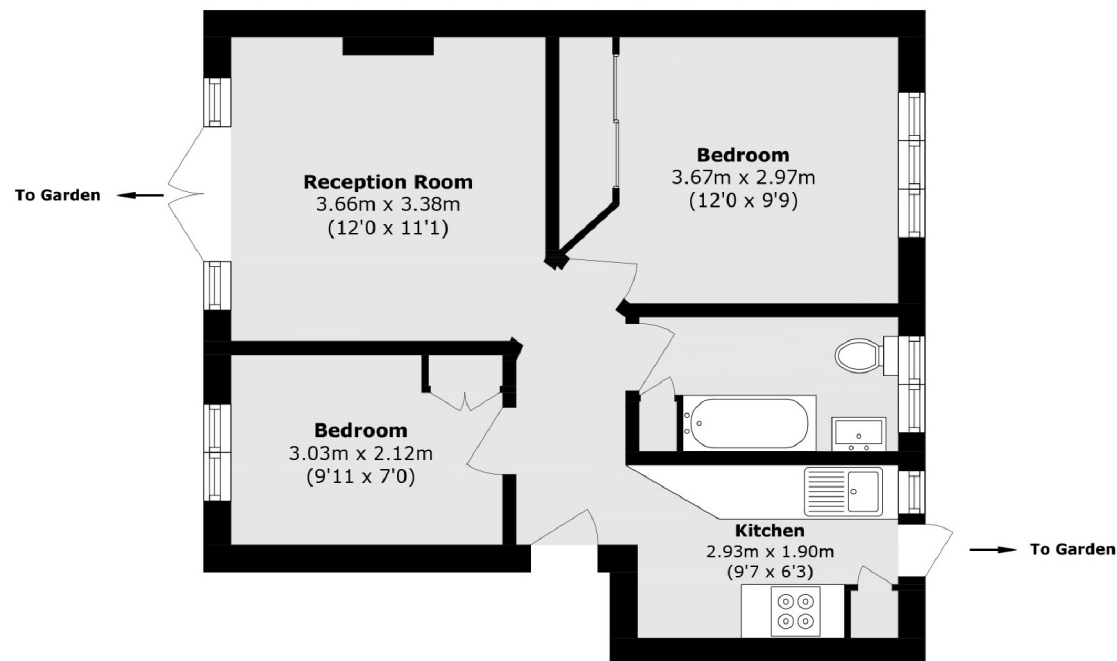

Total area (approx.): 45.1 sq. m (485.4 sq. ft)

KEY FEATURES

- Ground Floor
- Two Bedrooms
- Private Parking
- Communal Gardens
- Great Location
- Chain Free

Energy Rating: C. We aim to make our particulars both accurate and reliable. However they are not guaranteed; nor do they form part of an offer or contract. If you require clarification on any points then please contact us, especially if you are travelling some distance to view. Please note that appliances and heating systems have not been tested and therefore no warranties can be given as to their good working order.

ASKING PRICE: £375,000

TEDDINGTON

020 8943 9777

teddingtonsales@jackson-stops.com

jackson-stops.co.uk

JACKSON-STOPS

