



**TEDDINGTON PARK ROAD**  
TEDDINGTON

**JACKSON-STOPS** 



## TEDDINGTON PARK ROAD, TEDDINGTON, TW11

ASKING PRICE: £1,400 PCM

A well-presented apartment with a contemporary interior and excellent storage. Consisting of one double bedroom, bathroom, open plan kitchen and reception and communal gardens.

Teddington Park Road is a pretty tree lined road, ideally located 0.6 miles from Teddington Station and Teddington High Street with it's shops, bars and restaurants.

### KEY FEATURES

- One Bedroom
- Communal Gardens
- Open Plan Living
- Storage
- Ground Floor
- Modern Kitchen

Energy Rating: . We aim to make our particulars both accurate and reliable. However they are not guaranteed; nor do they form part of an offer or contract. If you require clarification on any points then please contact us, especially if you are travelling some distance to view. Please note that appliances and heating systems have not been tested and therefore no warranties can be given as to their good working order.

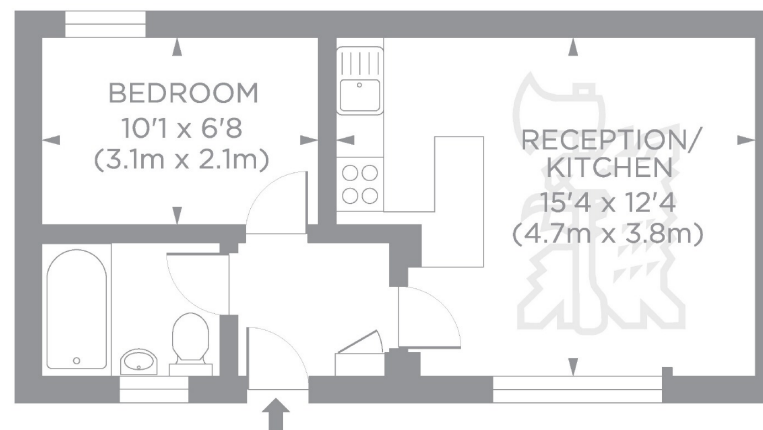

### GROUND FLOOR

Teddington Park Road TW11  
Gross internal area 322sq ft/30sq metres

©photosandfloorplans.com

ASKING PRICE: £1,400 PCM

TEDDINGTON

020 8943 9955

teddingtonlettings@jackson-stops.com

jackson-stops.co.uk

JACKSON-STOPS