



QUEENS ROAD
TEDDINGTON

JACKSON-STOPS 

QUEENS ROAD TEDDINGTON, TW11

ASKING PRICE: £450,000

This characterful & well-presented 1930's period apartment offers excellent accommodation with two well-proportioned double bedrooms, a large character living room and large modern double-glazed windows on each side of the property. It is in a very quiet position with a very private feel to and features very attractive views to the communal gardens, both to the rear on to a central lawn.

This is a most charming setting and is also within 100 yards of Bushy Park and 1/3 mile of Teddington Train Station. It features gorgeous landscaped gardens on all sides of the property and each property includes an allocated parking space within this intimate period development.

KEY FEATURES

- No Onward Chain
- Two Double Bedrooms
- Ground Floor
- Private Off Street Parking
- Communal Gardens
- Sought After Location





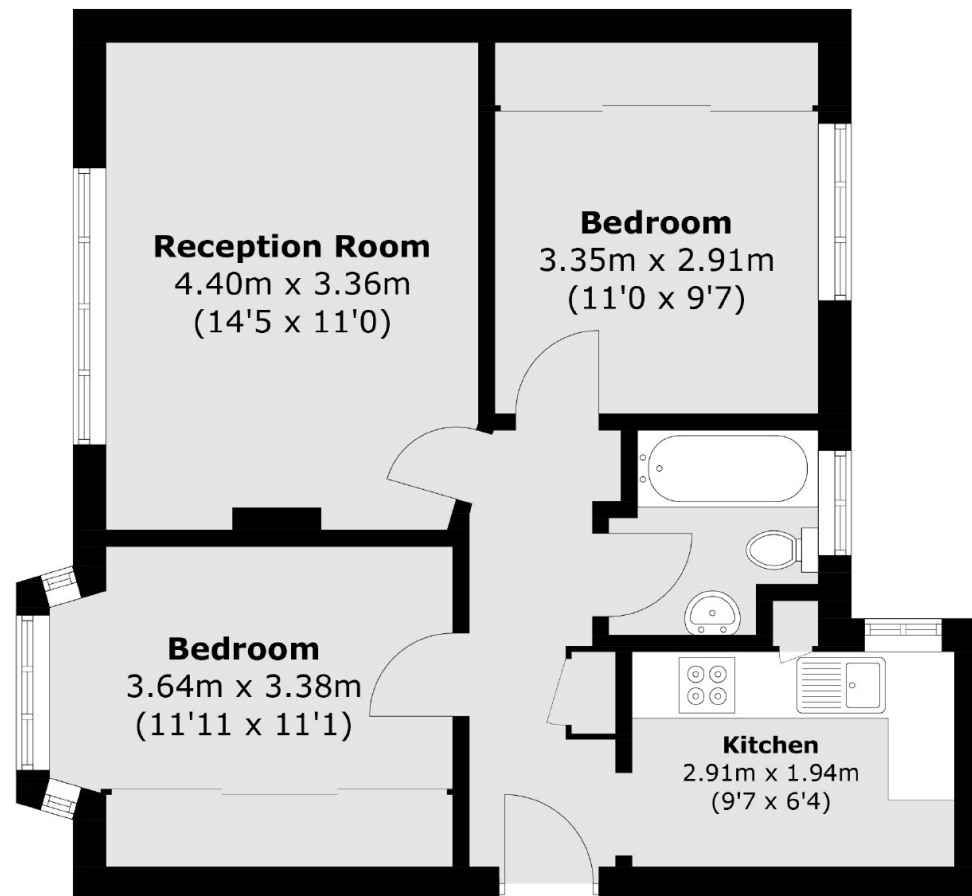

Total area (approx.): 51.2 sq. m (551.1 sq. ft)

Energy Rating: D. We aim to make our particulars both accurate and reliable. However they are not guaranteed; nor do they form part of an offer or contract. If you require clarification on any points then please contact us, especially if you are travelling some distance to view. Please note that appliances and heating systems have not been tested and therefore no warranties can be given as to their good working order.

ASKING PRICE: £450,000

TEDDINGTON

020 8943 9777

teddingtonsales@jackson-stops.com

jackson-stops.co.uk

JACKSON-STOPS 