

**WALDEGRAVE ROAD**  
TEDDINGTON

**JACKSON-STOPS** 

## WALDEGRAVE ROAD, TEDDINGTON, TW11

ASKING PRICE: £340,000

This modern one bedroom period conversion flat is offered to the market with no onward chain. The property is set on the first floor and is in great condition throughout with a modern bathroom and kitchen. The kitchen is open to the living room with a south aspect which offers a lot of light. Further benefits are off street parking and a share of the freehold.

Located on Waldegrave Road, you are a short walk to the shops, cafés and pubs on Teddington High Street. Teddington Station is within 15 minutes walk from the property as well offering train services to Twickenham, Kingston, Richmond, Waterloo and many more.

### KEY FEATURES

- First Floor
- Modern Throughout
- Share Of Freehold
- Off Street Parking
- Low Service Charge
- Great Investment

Energy Rating: C. We aim to make our particulars both accurate and reliable. However they are not guaranteed; nor do they form part of an offer or contract. If you require clarification on any points then please contact us, especially if you are travelling some distance to view. Please note that appliances and heating systems have not been tested and therefore no warranties can be given as to their good working order.

### First Floor

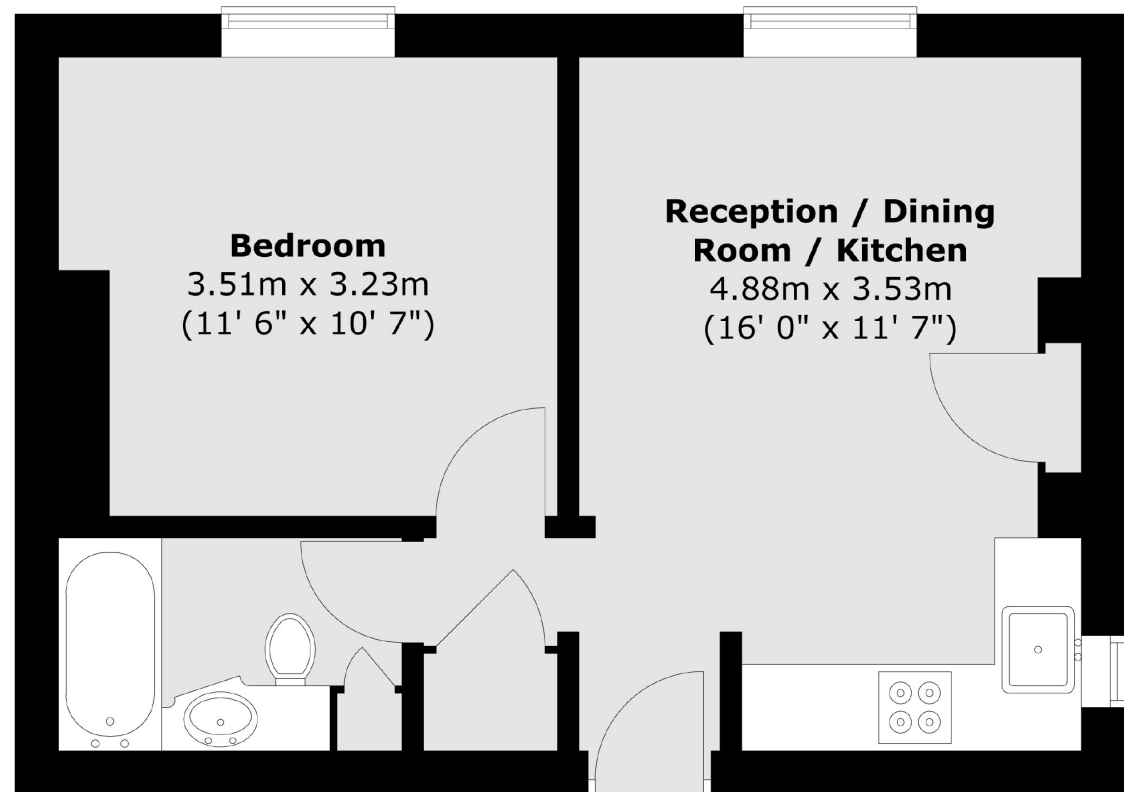

Total area (approx.) : 35.2 sq. m (379 sq. ft)

ASKING PRICE: £340,000

TEDDINGTON

020 8943 9777

teddingtonsales@jackson-stops.com

jackson-stops.co.uk

JACKSON-STOPS 