



**DERBY ROAD**  
EAST SHEEN

**JACKSON-STOPS** 



## DERBY ROAD, EAST SHEEN, SW14

ASKING PRICE: £3,500 PCM

A four bedroom terraced house located just 0.2 miles from Sheen Mount Primary School. Benefitting from two double bedrooms, two single bedrooms and large open plan reception/dining space. Private garden and separate kitchen.

### KEY FEATURES

- Three Bedrooms
- Study
- 
- Private Garden
- Close to Schools
- Two En-suite Bathroom

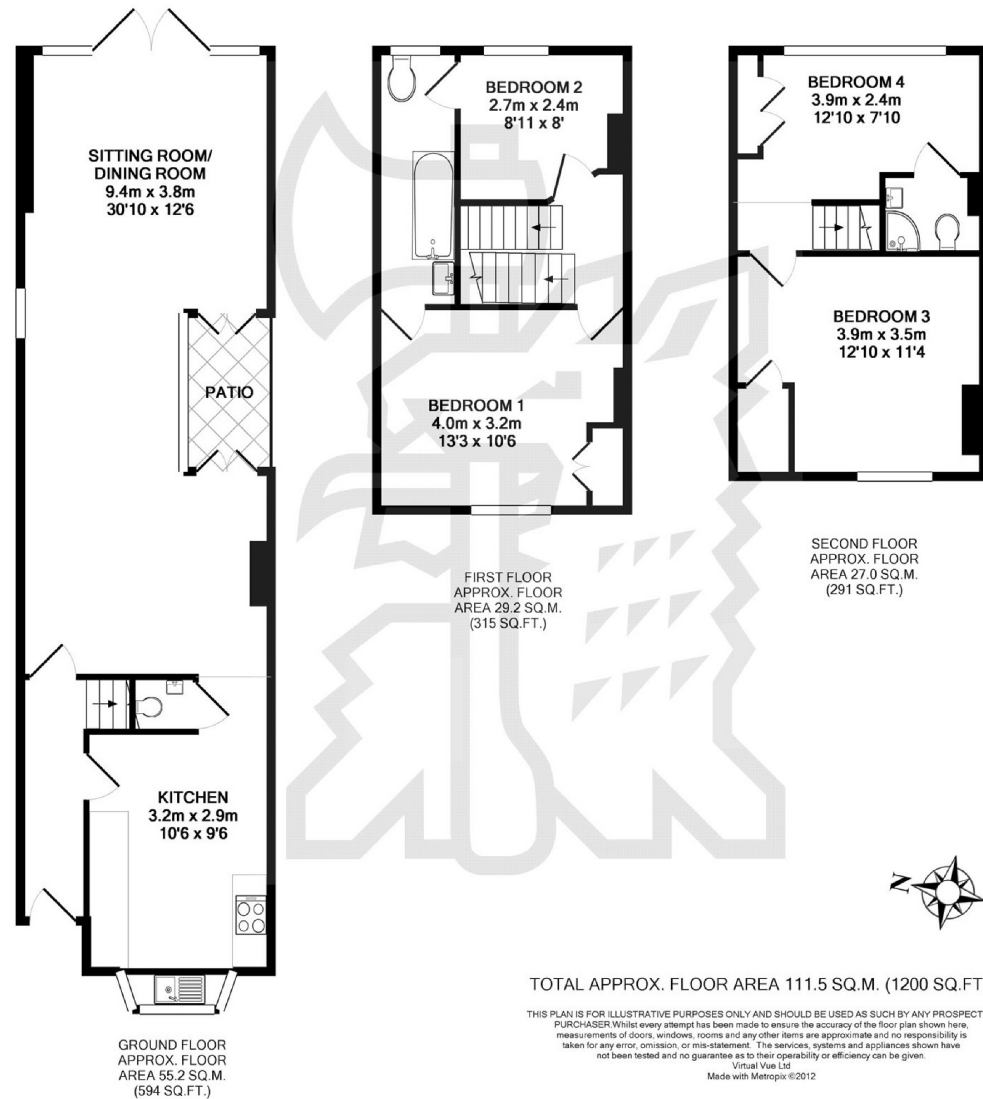

Energy Rating: D. We aim to make our particulars both accurate and reliable. However they are not guaranteed; nor do they form part of an offer or contract. If you require clarification on any points then please contact us, especially if you are travelling some distance to view. Please note that appliances and heating systems have not been tested and therefore no warranties can be given as to their good working order.

ASKING PRICE: £3,500 PCM

RICHMOND

020 8940 0066

richmond@jackson-stops.co.uk

jackson-stops.co.uk

**JACKSON-STOPS**

