



Flat 25 Commodore Court, 1 Bar Lane,
Nottingham, NG8 5DH

Flat 25 Commodore Court, 1 Bar Lane, Nottingham, NG8 5DH

This modern apartment occupies a second floor position, and provides accommodation including; an entrance hall, an open plan kitchen dining/living area with patio doors opening to a Juliette style balcony, plus two bedrooms and a fitted bathroom.

Benefiting from double glazing, electric storage heating, and a security intercom entry system, the property also has one allocated car parking space.

Situated in a popular location, the property is within easy reach nearby facilities including a number shops. There are excellent local transport links to the City Hospital, Queens Medical Centre and Nottingham city centre.

Currently tenanted, the property will make an ideal investment purchase.

Viewing is highly recommended.

Guide Price £117,500





ACCOMMODATION

The COMMUNAL ENTRANCE HALL has stairs rising to the floors above.

On reaching the second floor, the PRIVATE ENTRANCE DOOR opens to the entrance hall. The entrance hall has two storage cupboards, doors into both bedrooms and the bathroom, and access to the open plan kitchen dining/living space.

The kitchen area is fitted with wall and base units, tiled splash backs and square edge work surfaces, and has a stainless steel sink and drainer unit with a mixer tap over, space and plumbing for a washing machine, space for a tall fridge/freezer, plus a built in oven, and a four ring gas hob with an extractor hood over. There is a breakfast bar area, a cluster ceiling light, and open access to the dining/living area.

The dining/living area has an electric storage heater, and sliding patio doors opening to a Juliette style balcony.

Both bedrooms have a window to the rear, a ceiling light point, and an electric storage heater.

Completing the accommodation, the bathroom is fitted with a panelled bath with a shower and glazed screen over, a low flush wc, and a pedestal wash hand basin. There is half height tiling to the walls, tiled flooring, a ceiling light point, and a heated towel rail.

OUTSIDE

The property has one allocated car parking space.

Leasehold & Service Details

We are advised that the property is leasehold and has approximately 110 Year remaining.

The service charge is paid annually at £1079 and ground rent is also paid annually at £250

For further information, contact Thomas James Estate Agents.

Currently Let

We understand that the property is currently let at £750 per calendar month.

For further information, contact Thomas James Estate Agents.

Council Tax Band

Council Tax Band A. Nottingham City Council.

Amount Payable 2024/2025 £1,686.46.

Referral Arrangement Note

Thomas James Estate Agents always refer sellers (and will offer to refer buyers) to Premier Property Lawyers, Ives & Co, and Curtis & Parkinson for conveyancing services (as above). It is your decision as to whether or not you choose to deal with these conveyancers. Should you decide to use the conveyancers named above, you should know that Thomas James Estate Agents would receive a referral fee of between £120 and £240 including VAT from them, for recommending you to them.

DISCLAIMER NOTES

These sales particulars have been prepared by Thomas James Estate Agents on the instruction of the vendor. Services, equipment and fittings mentioned in these particulars have NOT been tested, and as such, no warranties can be given. Prospective purchasers are advised to make their own enquiries regarding such matters. These sales particulars are produced in good faith and are not intended to form part of a contract. Whilst Thomas James Estate Agents have taken care in obtaining internal measurements, they should only be regarded as approximate.

MONEY LAUNDERING

Under the Protecting Against Money Laundering and the Proceeds of Crime Act 2002, Thomas James require any successful purchasers proceeding with a purchase to provide two forms of identification i.e passport or photocard driving license and a recent utility bill. This evidence will be required prior to Thomas James instructing solicitors in the purchase or the sale of a property.

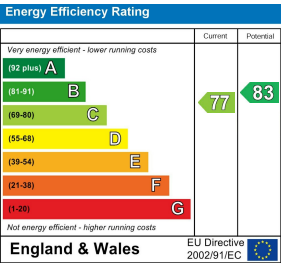

GROUND FLOOR
616 sq.ft. (57.2 sq.m.) approx.

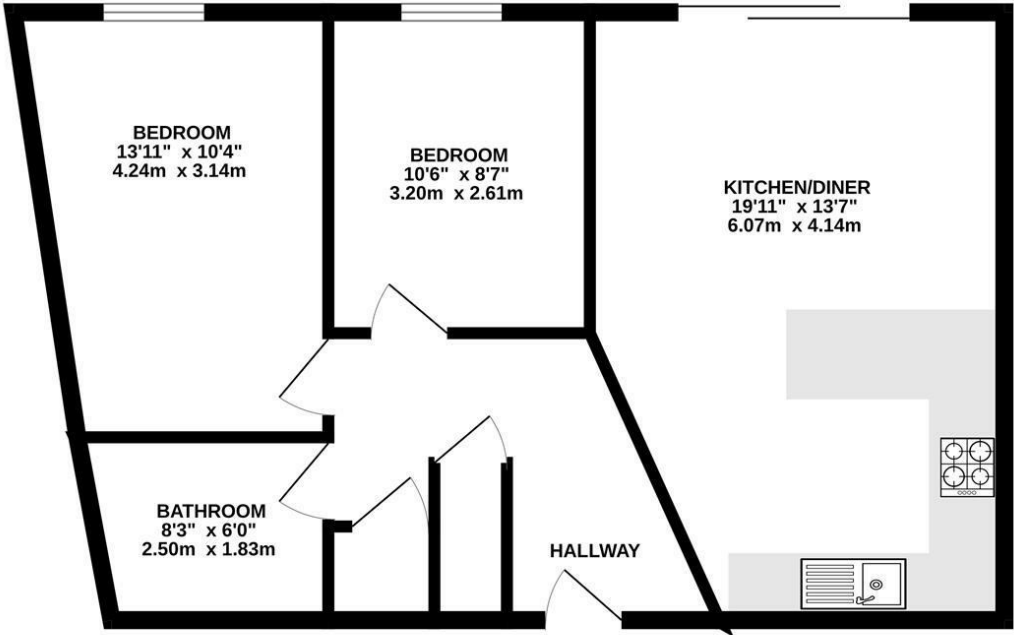

TOTAL FLOOR AREA : 616 sq.ft. (57.2 sq.m.) approx.
Whilst every attempt has been made to ensure the accuracy of the floorplan contained here, measurements of doors, windows, rooms and any other items are approximate and no responsibility is taken for any error, omission or mis-statement. This plan is for illustrative purposes only and should be used as such by any prospective purchaser. The services, systems and appliances shown have not been tested and no guarantee as to their operability or efficiency can be given.
Made with Metropix ©2024



Thomas James Estate Agents, 20 High Street, Ruddington, Nottinghamshire, NG11 6EH

Tel: 0115 9844660 | Email: ruddington@tjea.com | Web: www.tjea.com

These particulars, whilst believed to be accurate are set out as a general outline only for guidance and do not constitute any part of an offer or contract. Intending purchasers should not rely on them as statements of representation of fact, but must satisfy themselves by inspection or otherwise as to their accuracy. No person in this firm's employment has the authority to make or give any representation or warranty in respect of the property.

