



21 Wibberley Drive,  
Ruddington, NG11 6AL



# 21 Wibberley Drive, Ruddington, NG11 6AL

Situated in the sought after south Nottinghamshire village of Ruddington, this end town house is a comfortable home in a highly regarded area.

The property provides accommodation arranged over two floors including: an entrance hall, a dual aspect living/dining room with patio doors opening to the rear garden, a kitchen, and a cloakroom/wc on the ground floor, with the first floor landing giving access to three bedrooms and the family shower room.

Benefiting from double glazing, and gas central heating, the property has an enclosed garden to the rear, and a low maintenance garden to the front. A garage provides off road parking.

Ruddington enjoys a wealth of excellent local facilities including shops, schools, churches, a doctors surgery, golf club and country park. Main road routes and local transport links provide access to Nottingham, West Bridgford, and neighbouring villages.

Viewing is recommended.

Guide Price £265,000







## ACCOMMODATION

The canopied composite entrance door at the front, opens to the entrance hall. From here, stairs rise to the first floor, and doors give access to the ground floor cloakroom/wc, and the living/dining room.

The dual aspect living/dining room has a window to the front, an electric fire set in a feature fireplace, a door into the kitchen, and sliding patio doors opening to the rear garden.

Fitted with a range of wall, drawer and base units, with laminate work surface over, the kitchen has an inset one and a half bowl stainless steel sink and drainer with a mixer tap over, space and plumbing for a washing machine, space for a fridge/freezer, plus a built in electric oven, and a gas hob with an extractor hood over. There is a window to the side, and a door opening to the rear garden.

On reaching the first floor, the landing has a loft access hatch, and doors into three bedrooms (one with built in wardrobes, and one with an over stairs storage cupboard), and the family shower room, which is fitted with a double walk in shower enclosure, a low flush wc, and a wash hand basin.

## OUTSIDE

At the front of the property there is a low maintenance garden, laid to gravelled beds. A pathway leads to the canopied entrance door.

To the rear of the property, the fully enclosed garden includes; a patio seating area, a lawned area, and mature shrub borders. The garden has an external tap, and external lighting.

A pathway leads to the SINGLE GARAGE (with an up and over door, power and light connected, and a pedestrian door to the side), along with an additional parking space for one further vehicle.

## Council Tax Band

Council Tax Band B. Rushcliffe Borough Council.

Amount Payable 2024/2025 £1,915.71.

## Referral Arrangement Note

Thomas James Estate Agents always refer sellers (and will offer to refer buyers) to Premier Property Lawyers, Ives & Co, and Curtis & Parkinson for conveyancing services (as above). It is your decision as to whether or not you choose to deal with these conveyancers. Should you decide to use the conveyancers named above, you should know that Thomas James Estate Agents would receive a referral fee of between £120 and £240 including VAT from them, for recommending you to them.

DISCLAIMER NOTES

These sales particulars have been prepared by Thomas James Estate Agents on the instruction of the vendor. Services, equipment and fittings mentioned in these particulars have NOT been tested, and as such, no warranties can be given. Prospective purchasers are advised to make their own enquiries regarding such matters. These sales particulars are produced in good faith and are not intended to form part of a contract. Whilst Thomas James Estate Agents have taken care in obtaining internal measurements, they should only be regarded as approximate.

MONEY LAUNDERING

Under the Protecting Against Money Laundering and the Proceeds of Crime Act 2002, Thomas James require any successful purchasers proceeding with a purchase to provide two forms of identification i.e passport or photocard driving license and a recent utility bill. This evidence will be required prior to Thomas James instructing solicitors in the purchase or the sale of a property.

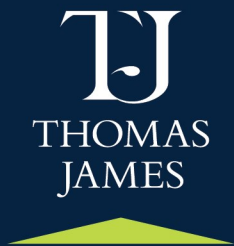
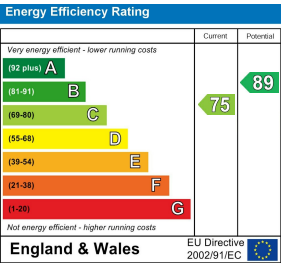

Thomas James Estate Agents, 20 High Street, Ruddington, Nottinghamshire, NG11 6EH

Tel: 0115 9844660 | Email: ruddington@tjea.com | Web: www.tjea.com

These particulars, whilst believed to be accurate are set out as a general outline only for guidance and do not constitute any part of an offer or contract. Intending purchasers should not rely on them as statements of representation of fact, but must satisfy themselves by inspection or otherwise as to their accuracy. No person in this firm's employment has the authority to make or give any representation or warranty in respect of the property.



Ground Floor  
Approx. 48.2 sq. metres (518.6 sq. feet)

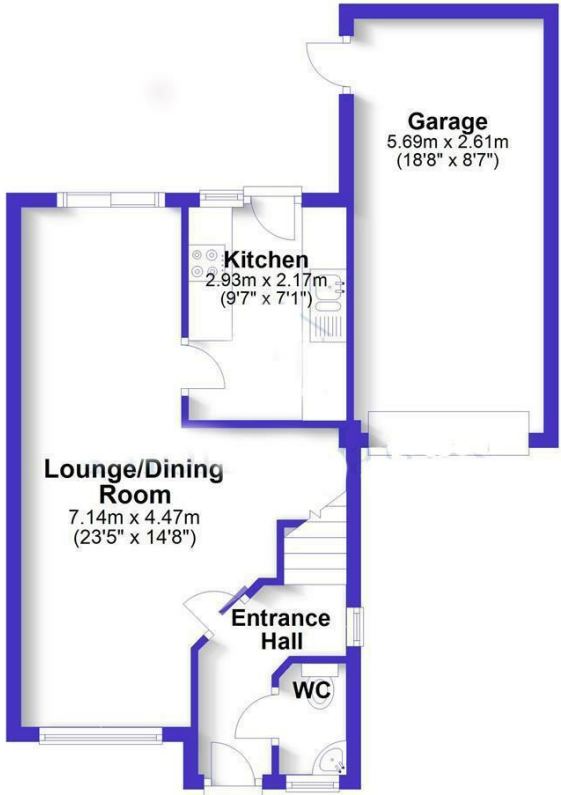

First Floor  
Approx. 33.8 sq. metres (363.3 sq. feet)

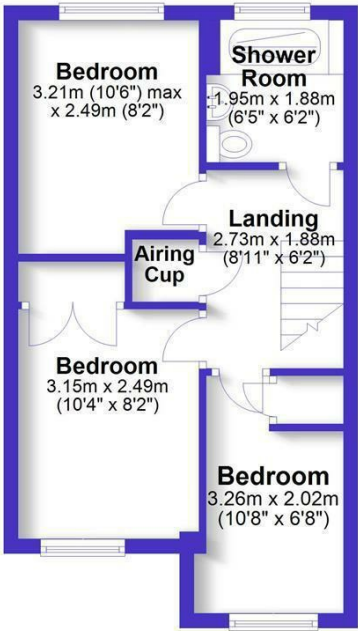

Total area: approx. 81.9 sq. metres (882.0 sq. feet)