



Apartment 27, Manor Lodge,
Ruddington, NG11 6DU

Apartment 27, Manor Lodge, Ruddington, NG11 6DU

Welcome to Manor Lodge - 'Churchill Living' in the picturesque Manor Park, Ruddington!

This stunning apartment is in immaculate condition, perfect for those looking for a modern and stylish living space.

Occupying a first floor position, the apartment provides approximately 809.66 sq ft of accommodation which includes an entrance hall, a fitted kitchen, a lounge/diner with a balcony overlooking the communal gardens, a bathroom, and two large bedrooms (the master bedroom also having an en-suite shower room).

The apartment benefits from electric heating and double glazing, and boasts a neutral decor throughout.

Don't miss the opportunity to make this apartment your new home. With its prime location and access to amenities, Manor Lodge is the perfect place to create new memories and enjoy a comfortable lifestyle.

Guide Price £380,000





ACCOMMODATION

As you step inside, you'll be greeted by the bright airy hallway. Here there is ample storage, and doors into two bedrooms, the bathroom, and the lounge/diner.

The two spacious double bedrooms, both feature mirrored sliding door wardrobes, providing ample storage space while adding a touch of elegance to the rooms. The master bedroom is complete with its own en-suite shower room.

The lounge/diner is a cozy haven, with access to a private balcony which enjoys views of the well maintained communal gardens. From the lounge/diner, a glazed door opens to the modern and light kitchen, which is fitted with base and wall units, square edged worktops, a sink, an electric hob, an oven, an integrated washing machine, and a fridge freezer.

The main bathroom includes a panelled bath with shower and glazed screen over, plus a toilet, and a vanity unit with inset sink.

Manor Lodge

Manor Lodge comprises just 43 self contained, one and two bedroom apartments.

The development also features communal gardens and parking areas, a Coffee Bar and Owners' Lounge.

The communal areas within the development, both inside and outside, are immaculately presented and maintained.

Leasehold

We understand that the annual service charge for the property is £3,545.11, and that ground rent will be charged at £625.00 per annum.

Please contact Thomas James for further information.

Council Tax Band

Council Tax Band C. Rushcliffe Borough Council.

Amount Payable 2024/2025 £2,189.36.

Referral Arrangement Note

Thomas James Estate Agents always refer sellers (and will offer to refer buyers) to Knights PLC, Premier Property Lawyers, Ives & Co, Curtis & Parkinson, Bryan & Armstrong, and Marchants for conveyancing services (as above). It is your decision as to whether or not you choose to deal with these conveyancers. Should you decide to use the conveyancers named above, you should know that Thomas James Estate Agents would receive a referral fee of between £120 and £240 including VAT from them, for recommending you to them.

DISCLAIMER NOTES

These sales particulars have been prepared by Thomas James Estate Agents on the instruction of the vendor. Services, equipment and fittings mentioned in these particulars have NOT been tested, and as such, no warranties can be given. Prospective purchasers are advised to make their own enquiries regarding such matters. These sales particulars are produced in good faith and are not intended to form part of a contract. Whilst Thomas James Estate Agents have taken care in obtaining internal measurements, they should only be regarded as approximate.

MONEY LAUNDERING

Under the Protecting Against Money Laundering and the Proceeds of Crime Act 2002, Thomas James require any successful purchasers proceeding with a purchase to provide two forms of identification i.e passport or photocard driving license and a recent utility bill. This evidence will be required prior to Thomas James instructing solicitors in the purchase or the sale of a property.

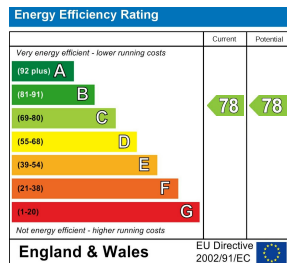

GROUND FLOOR

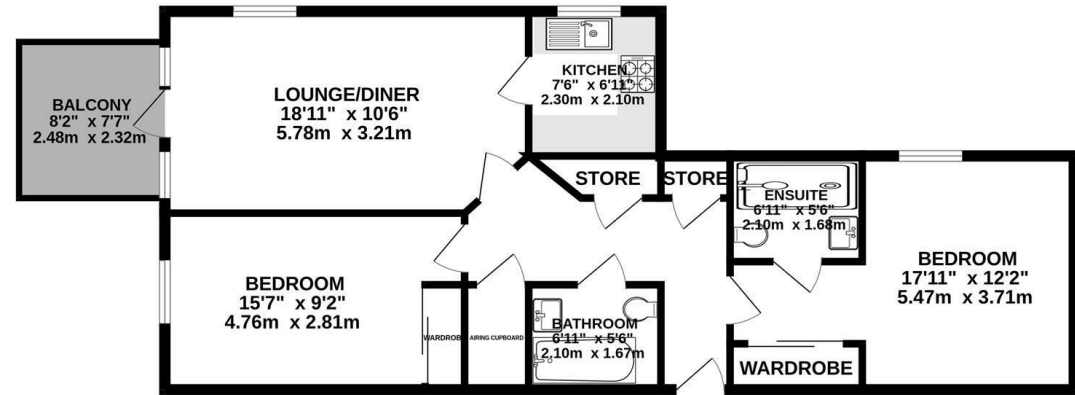

Whilst every attempt has been made to ensure the accuracy of the floorplan contained here, measurements of doors, windows, rooms and any other items are approximate and no responsibility is taken for any error, omission or mis-statement. This plan is for illustrative purposes only and should be used as such by any prospective purchaser. The services, systems and appliances shown have not been tested and no guarantee as to their operability or efficiency can be given.
Made with Metropix ©2024

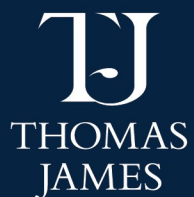

Thomas James Estate Agents, 20 High Street, Ruddington, Nottinghamshire, NG11 6EH

Tel: 0115 9844660 | Email: ruddington@tjea.com | Web: www.tjea.com

These particulars, whilst believed to be accurate are set out as a general outline only for guidance and do not constitute any part of an offer or contract. Intending purchasers should not rely on them as statements of representation of fact, but must satisfy themselves by inspection or otherwise as to their accuracy. No person in this firm's employment has the authority to make or give any representation or warranty in respect of the property.

