

...Your proactive estate agent



Kimberley Street, Featherstone, Pontefract, WF7 6EJ
Offers In Excess Of £125,000



**** OFF STREET PARKING ** GOOD TRANSPORT LINKS ** TWO DOUBLE BEDROOMS **** Situated in Featherstone this mid-terrace property briefly comprises: entrance hallway, ground floor w,c, lounge and kitchen to the ground floor. To the first floor are two bedrooms and bathroom. **VIEWING IS HIGHLY RECOMMENDED TO FULLY APPRECIATE THE PROPERTY ON OFFER. RING US 7 DAYS TO BOOK A VIEWING. 'WE OPEN UNTIL 8PM MONDAY TO THURSDAY, 5.30 FRIDAYS, 5.00 SATURDAYS AND 11.00 - 3.00 SUNDAYS'**



Property Summary

Presenting a charming mid-terrace property with no upward chain, featuring desirable off-street parking at the front and an enclosed garden at the rear. The lounge boasts access to a West-facing garden, perfect for enjoying evening sunsets. This home includes two double bedrooms, each complemented by fitted wardrobes, offering ample storage space. Ideal for those seeking convenience and comfort in a well-connected location.

GROUND FLOOR ACCOMMODATION

Entrance Hallway

3.68m x 1.10m (12'0" x 3'7")

Ground Floor W.C

1.52m x 0.96m (4'11" x 3'1")

Lounge

4.57m x 3.74m (14'11" x 12'3")

Kitchen

3.33m x 1.68m (10'11" x 5'6")

FIRST FLOOR ACCOMMODATION

LANDING

Bedroom One

3.73m x 3.02m (12'2" x 9'10")

Bedroom Two

3.74m x 2.74m (12'3" x 8'11")

Bathroom

2.00m x 1.67m (6'6" x 5'5")

EXTERIOR

Front

Off street parking.

Rear

Fully enclosed and predominately laid to lawn with decorative patio area.

HEATING AND APPLIANCES.

The heating system and any appliances (including Burglar Alarms where fitted) mentioned in this brochure have not been tested by Park Row Properties. If you are interested in purchasing the property we advise that you have all services and appliances tested before entering a legal commitment to purchase.

MAKING AN OFFER.

In order to comply with the Estate Agents (Undesirable Practises) Order 1991, Park Row Properties are required to verify "the status of any prospective purchaser... This includes the financial standing of that purchaser and his ability to exchange contracts". To allow us to comply with this order and before recommending acceptance of any offers, and subsequently making the property 'SOLD' each prospective purchaser will be required to demonstrate to 'Park Row Properties' that they are financially able to proceed with the purchase of the property.

We provide truly Independent Mortgage Advice. Unlike many companies we are not tied, and more importantly not targeted to any Lender. We have instant on-line access to over 1000 mortgage deals provided by over 100 Lenders ensuring we are unbeatable when identifying and recommending your new mortgage or re-mortgage requirements.

Your home is at risk if you do not keep up repayments on a mortgage or other loan secured on it. Written quotations available on request. Life assurance is usually required.

To arrange a no obligation appointment please contact your local office.

MEASUREMENTS.

These approximate room sizes are only intended as general guidance. You must verify the dimensions carefully before ordering carpets or any built-in furniture.

OPENING HOURS.

CALLS ANSWERED :

Mon, Tues, Wed & Thurs - 9.00am to 8.00pm

Friday - 9.00am to 5.30pm

Saturday - 9.00am to 5.00pm

Sunday - 11.00am to 3.00pm

TO CHECK OFFICE OPENING HOURS PLEASE CONTACT THE RELEVANT BRANCHES ON:

SELBY - 01757 241124

GOOLE - 01405 761199

SHERBURN IN ELMET - 01977 681122

PONTEFRACT - 01977 791133

CASTLEFORD - 01977 558480

TENURE, LOCAL AUTHORITY AND TAX BANDING

Tenure: Freehold

Local Authority: Wakefield Council

Tax Banding: A

Please note: The Tenure, Local Authority and Tax Banding for the property have been advised by the Vendor or obtained from online sources. We strive to ensure these details are accurate and reliable, however, we advise any potential buyer to carry out their own enquiries before proceeding.

UTILITIES, BROADBAND AND MOBILE COVERAGE

Electricity: Mains

Gas: Mains

Sewerage: Mains

Water: Mains

Broadband:Ultrafast
Mobile: 4G

Please note: The Utilities, Broadband and Mobile Coverage for the property have been advised by the Vendor or obtained from online sources. We strive to ensure these details are accurate and reliable, however, we advise any potential buyer to carry out their own enquiries before proceeding.

VIEWINGS.

Strictly by appointment with the sole agents.

If there is any point of particular importance to you we will be pleased to provide additional information or to make any further enquiries. We will also confirm that the property remains available. This is particularly important if you are travelling some distance to view the property.

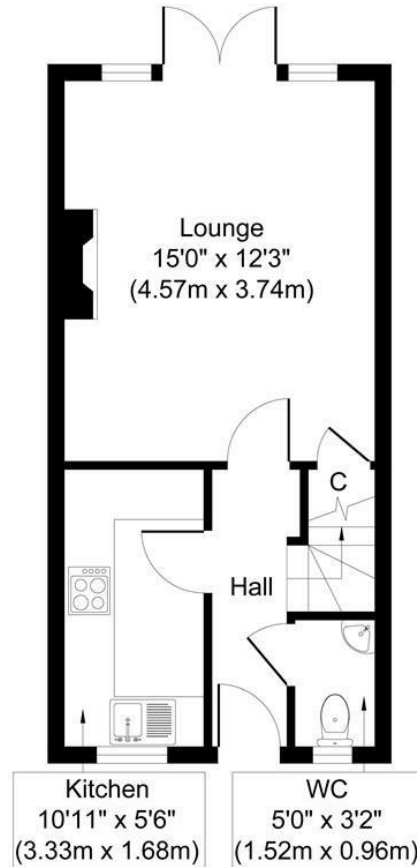

Ground Floor
Approximate Floor Area
322 sq. ft
(29.92 sq. m)

Whilst every attempt has been made to ensure the accuracy of the floor plan contained here, measurements of doors, windows, rooms and any other items are approximate and no responsibility is taken for any error, omission, or mis-statement. The measurements should not be relied upon for valuation, transaction and/or funding purposes. This plan is for illustrative purposes only and should be used as such by any prospective purchaser or tenant. The services, systems and appliances shown have not been tested and no guarantee as to their operability or efficiency can be given.
 Copyright V360 Ltd 2024 | www.houseviz.com

T 01977 791133

W www.parkrow.co.uk

18 Cornmarket, Pontefract, West Yorkshire, WF8 1BJ

pontefract@parkrow.co.uk



Bathroom
6'7" x 5'6"
(2.00m x 1.67m)

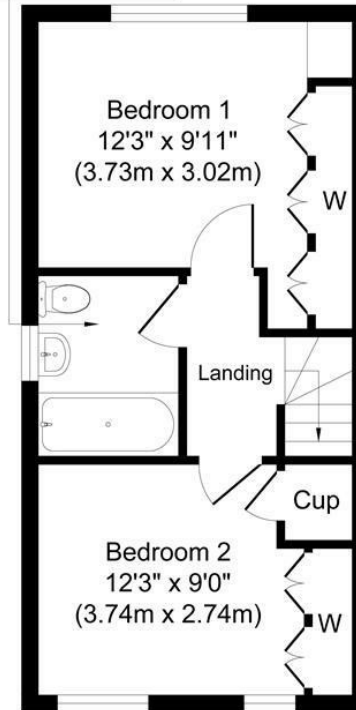

First Floor
Approximate Floor Area
322 sq. ft
(29.92 sq. m)

Whilst every attempt has been made to ensure the accuracy of the floor plan contained here, measurements of doors, windows, rooms and any other items are approximate and no responsibility is taken for any error, omission, or mis-statement. The measurements should not be relied upon for valuation, transaction and/or funding purposes. This plan is for illustrative purposes only and should be used as such by any prospective purchaser or tenant. The services, systems and appliances shown have not been tested and no guarantee as to their operability or efficiency can be given.
Copyright V360 Ltd 2024 | www.houseviz.com

T 01977 791133

W www.parkrow.co.uk

18 Cornmarket, Pontefract, West Yorkshire, WF8 1BJ

pontefract@parkrow.co.uk

