



MEXFIELD ROAD, SW15

£1,500,000

- Edwardian terraced house
- Four bedrooms
- Three bathrooms
- Home office in the garden
- High specification finish
- Energy rating: C





ABOUT THE HOME

An exquisite, four bedroom, Edwardian family home located on a beautiful, tree-lined street. Upon entrance you'll find a spacious reception room boasting tall ceilings and a wood burning stove. The kitchen/dining room is a true centrepiece, with herringbone wooden floors, underfloor heating, Smeg range cooker, hot/sparkling Quooker tap, electric Velux windows that flood the space with natural light, useful pantry and Crittall style, double doors which open onto a well kept garden with home office. There is ample storage and a W/C on the ground floor. This home offers four bedrooms; the principle bedroom including a dressing room and en-suite bathroom with bespoke vanity units and underfloor heating. There is a storage room/fifth bedroom and further bathrooms on the first and second floors. The property offers the perfect balance of style and functionality, making it ideal for modern family living.

Mexfield Road is highly sought after for being within walking distance to East Putney tube and Putney and Wandsworth Town mainline stations. An array of trendy coffee shops, boutique stores, bars and restaurants are just a stone's throw away for a vibrant lifestyle.





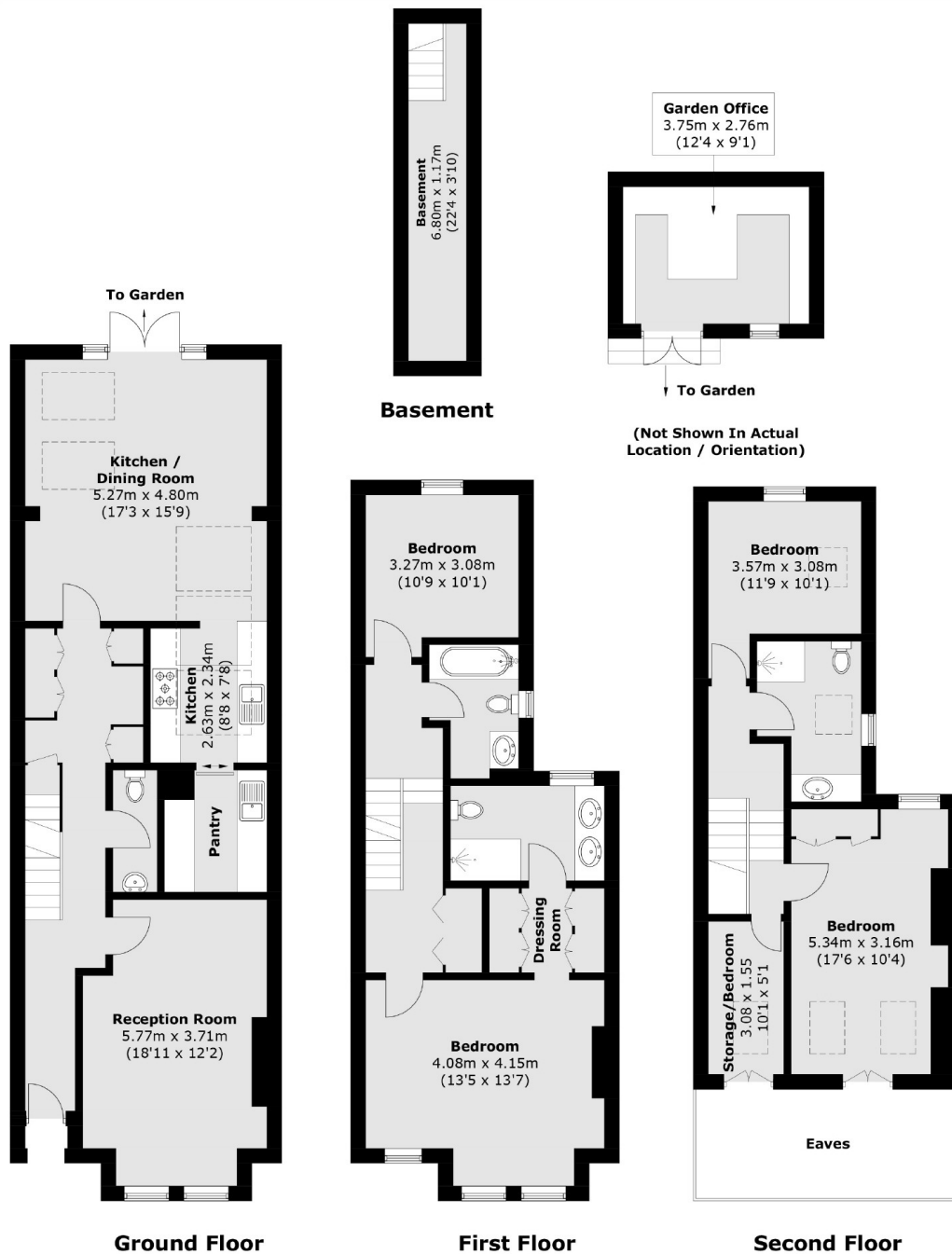

Total area (approx.): 186.8 sq. m (2,010.6 sq. ft)
(Including Basement / Excluding Eaves)
Garden Office: 10.5 sq. m (113.0 sq. ft)

JACKSONS WANDSWORTH

507 Old York Road, London,
SW18 1TF
Sales: 020 8875 8890
Lettings: 020 8875 8899

Energy Rating: C We aim to make our particulars both accurate and reliable. However they are not guaranteed; nor do they form part of an offer or contract. If you require clarification on any points then please contact us, especially if you're traveling some distance to view. Please note that appliances and heating systems have not been tested and therefore no warranties can be given as to their good working order.