



SUDLOW ROAD, SW18

£950,000

- Four double bedrooms
- Two bathrooms
- Courtyard style garden
- Excellent condition
- Sought after location
- Energy rating: C





ABOUT THE HOME

Set in the heart of Wandsworth, this charming four-bedroom Victorian terraced house is perfectly positioned for effortless access to the area's best amenities.

Moments from Wandsworth Park and the river, the property enjoys easy access to East Putney and Wandsworth Town stations, as well as the popular Southside Shopping Centre. The local Old York Road is renowned for its trendy cafes, restaurants, and bars, and is just a stone's throw away.

This beautifully extended family home offers elegant accommodation, including a spacious double reception room and a bright kitchen dining room that opens onto a small paved outdoor area. Additional features include a family bathroom and four generous double bedrooms, with the master suite benefiting from an en-suite bathroom.

Located on the quiet and picturesque Sudlow Road, this property is ideal for those seeking a vibrant Wandsworth lifestyle with all the benefits of local shops, parks, and transport links at your doorstep.





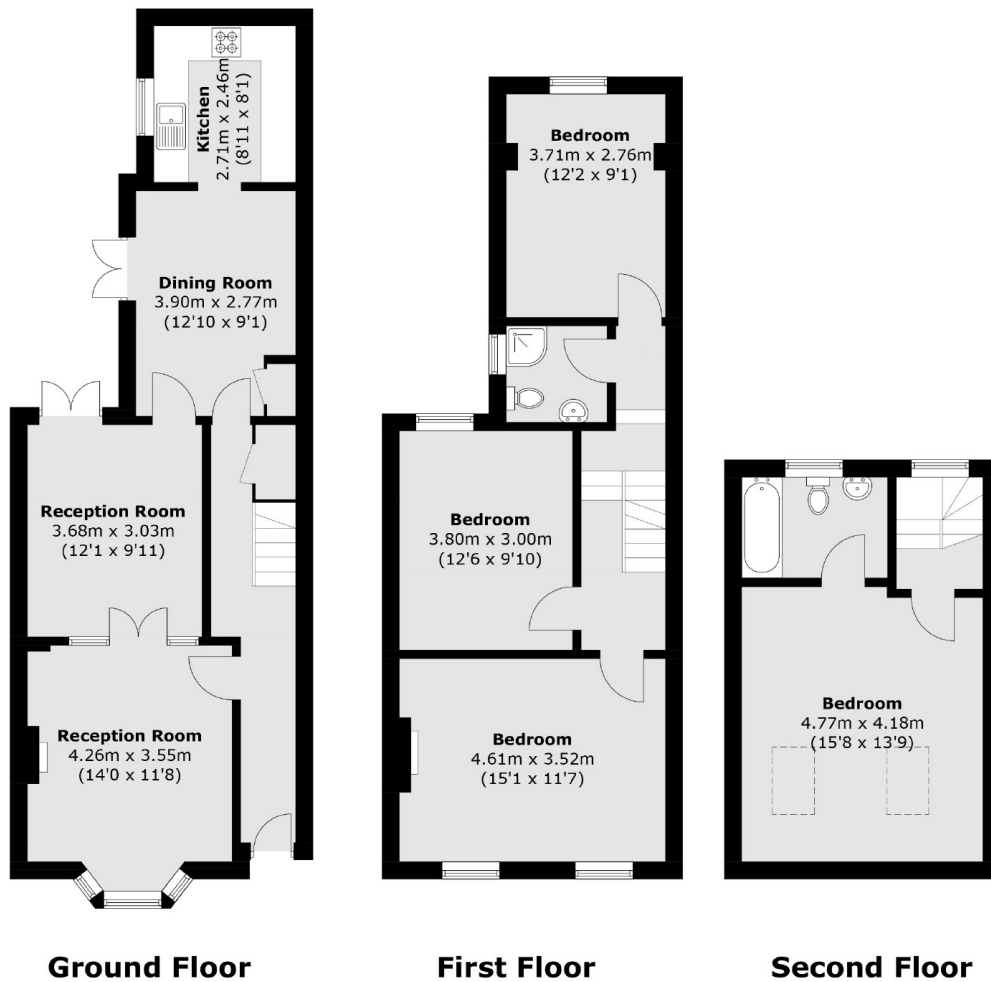

Total area (approx.): 132.4 sq. m (1425.1 sq. ft)

JACKSONS WANDSWORTH

507 Old York Road, London,
SW18 1TF
Sales: 020 8875 8890
Lettings: 020 8875 8899

Energy Rating: C We aim to make our particulars both accurate and reliable. However they are not guaranteed; nor do they form part of an offer or contract. If you require clarification on any points then please contact us, especially if you're traveling some distance to view. Please note that appliances and heating systems have not been tested and therefore no warranties can be given as to their good working order.