



NORTH SIDE WANDSWORTH COMMON, SW18

£550,000

- Victorian Conversion Flat
- Two Double Bedrooms
- Two Bathrooms
- Share of Freehold
- Sought After Location
- Energy rating: D





ABOUT THE HOME

A spacious and bright two double bedroom, two bathroom apartment located moments from the many amenities of St. John's Hill and the green spaces of Wandsworth Common.

The property is situated on the first floor of an exceptional former Victorian house. Accommodation comprises; useful entrance hall, shower room, double bedroom with built in wardrobes, there is a spacious and bright lounge with a feature fireplace which is semi open plan to a kitchen which boasts an array of integrated appliances, the main bedroom benefits from an en suite bathroom and an abundance of natural light. The property also benefits from a share of the freehold.

This property lies 0.6 miles from Clapham Junction station and 0.7 miles from Wandsworth Town station offering excellent links into central London. Located only a short distance from the property are the many restaurants, shops and cafes that St. Johns Hill have to offer.





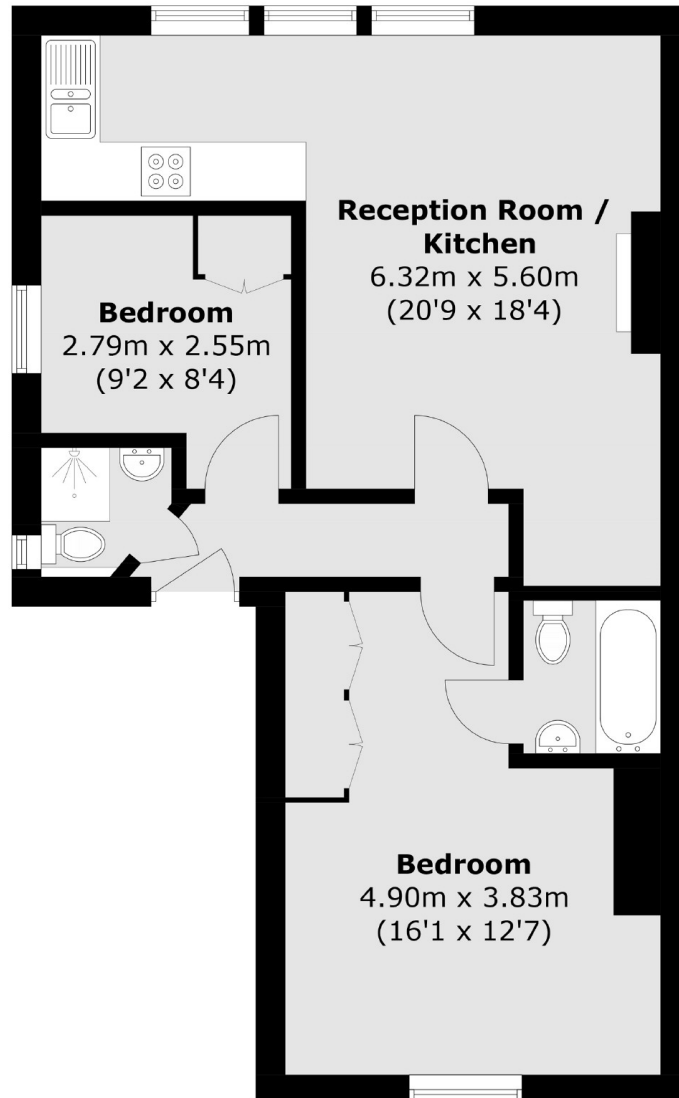

First Floor

Total area (approx.): 54.5 sq. m (586.6 sq. ft)

JACKSONS EARLSFIELD

372-374 Garratt Lane,
Earlsfield, London, SW18 4ES
Sales: 020 8971 7979
Lettings: 020 8971 7070

Energy Rating: Appraisal We aim to make our particulars both accurate and reliable. However they are not guaranteed; nor do they form part of an offer or contract. If you require clarification on any points then please contact us, especially if you're traveling some distance to view. Please note that appliances and heating systems have not been tested and therefore no warranties can be given as to their good working order.