



ST. ANN'S PARK ROAD, SW18

£550,000

- Victorian Conversation
- Two Double bedrooms
- High Ceilings
- Share of Freehold
- Own Front Garden
- Energy rating: C





ABOUT THE HOME

Positioned on the raised ground floor of this stunning Victorian building is this well presented, two double bedroom apartment, benefiting from a share of freehold and it's own front garden.

Situated on one of the area's most desirable roads, this stunning Victorian home comprises; front reception room with high ceilings and large windows allowing excellent natural light to flood in, there is ample space for a dining table with double doors that open to the kitchen. To the rear there are two double bedrooms, again, flooded with natural light from the large windows and a generous bathroom. The property further benefits from a share of freehold and it's own front garden.

St Ann's Park Road is a popular residential road in Wandsworth, close to a number of schools, with a good reputation locally, and located moments from numerous parks, Old York Road, Southside Centre and Sainsburys on Garratt Lane. There is ample amounts of green space nearby, with Wandsworth Common, Wandsworth Park and St Georges Park a short distance away.

Transport links are excellent; Wandsworth Town Station is easily accessible as is Clapham Junction Station.





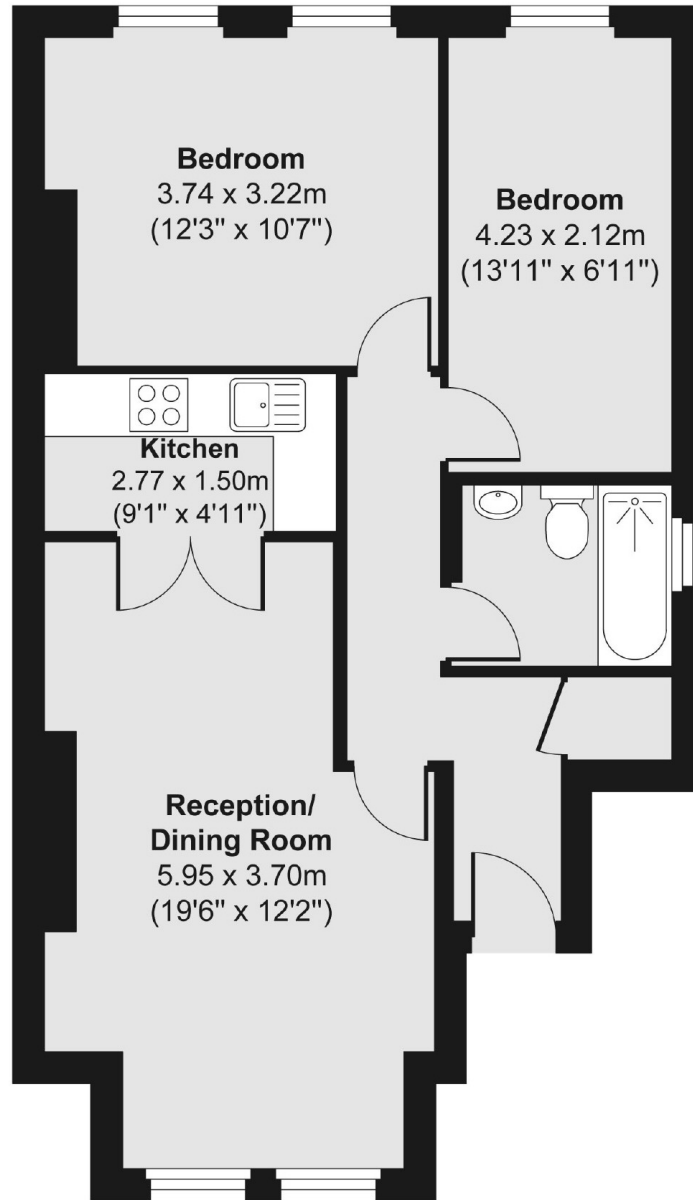

Total area (approx.) 56.18 sq. m (605 sq. ft)

JACKSONS WANDSWORTH

507 Old York Road, London,
SW18 1TF
Sales: 020 8875 8890
Lettings: 020 8875 8899

Energy Rating: D We aim to make our particulars both accurate and reliable. However they are not guaranteed; nor do they form part of an offer or contract. If you require clarification on any points then please contact us, especially if you're traveling some distance to view. Please note that appliances and heating systems have not been tested and therefore no warranties can be given as to their good working order.