



COURTHOUSE WAY, SW18

£550,000

- Two Double Bedrooms
- Modern Apartment
- Excellent Condition
- Private Balcony
- Sought After Location
- Energy rating: B





ABOUT THE HOME

A wonderfully presented and bright, two double bedroom, modern apartment with large private balcony in central Wandsworth.

The apartment is beautifully presented and comprises of; a large hallway with ample storage, modern separate contemporary family bathroom, a generous double bedroom. The main double bedroom has built in wardrobes and is flooded with natural light, as are all the other rooms with floor to ceiling windows. There is a modern kitchen finished to a high standard, leading to an open plan reception/dining room offering a fantastic entertaining space with large private balcony. The development also provides a large communal roof terrace and concierge service.

This apartment is located in a prime location amongst the shops, restaurants and amenities of Southside Shopping Centre. King George's Park is within walking distance as are Wandsworth Town and Earlsfield mainline stations providing direct links to the City, the West End and outer London.





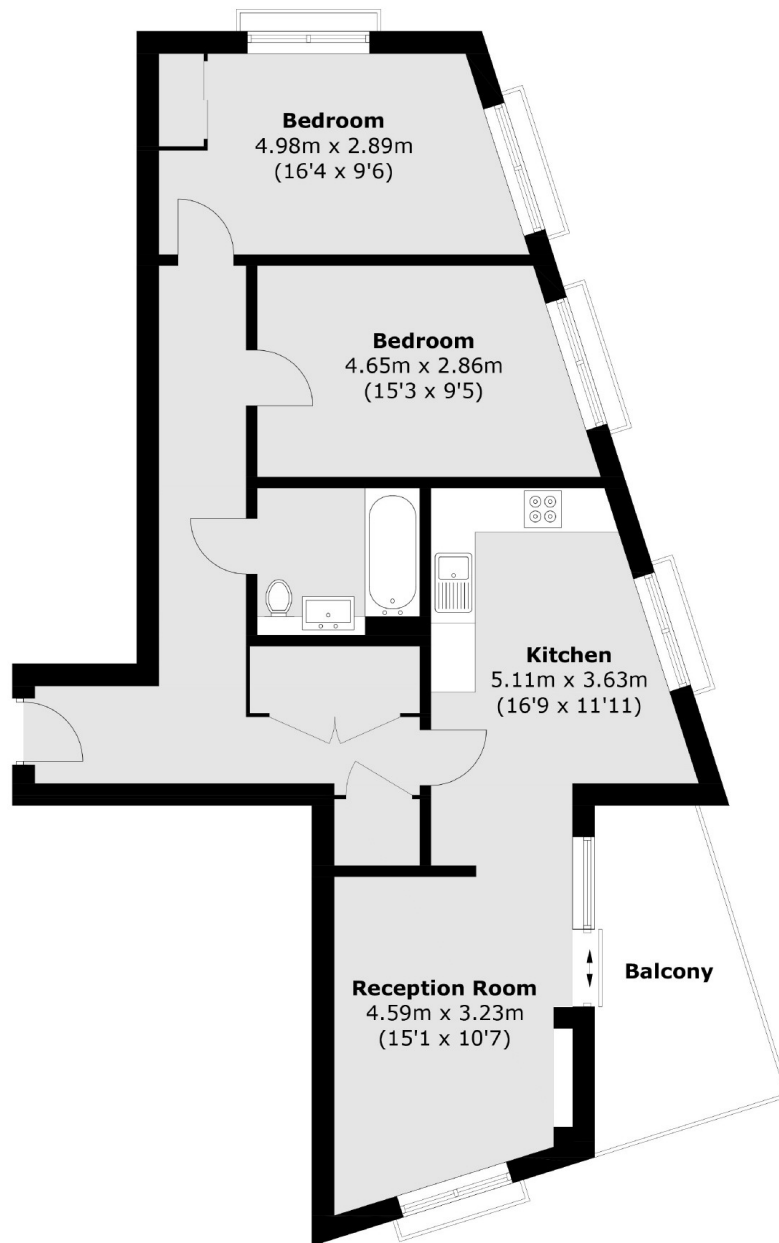

Total area (approx.): 76.2 sq. m (820.2 sq. ft)
Balcony: 8.7 sq. m (93.6 sq. ft)

JACKSONS WANDSWORTH

507 Old York Road, London,
SW18 1TF
Sales: 020 8875 8890
Lettings: 020 8875 8899

Energy Rating: We aim to make our particulars both accurate and reliable. However they are not guaranteed; nor do they form part of an offer or contract. If you require clarification on any points then please contact us, especially if you're traveling some distance to view. Please note that appliances and heating systems have not been tested and therefore no warranties can be given as to their good working order.