



Marcus Terrace, SW18

£500,000

A well presented ground floor Victorian apartment with a modern eat-in kitchen and a generous private garden.

- Two Bedrooms
- Eat-In Modern Kitchen
- Excellent Condition
- Ground Floor
- Private Garden
- Sought After Location



The apartment is in very good condition with a contemporary finish throughout whilst retaining a wealth of character and period features. Accommodation comprises; an entrance hall, stylish and superbly presented reception room, large double bedroom with built in wardrobes, very useful second bedroom/study, a refitted kitchen with space for dining, modern bathroom and a well maintained and generous private rear garden.

Marcus Terrace is part of a grid of quiet residential roads of similar Victorian purpose built apartments, which are consistently sought after being within close proximity of Wandsworth Town. This location is very well served by excellent transport links, restaurants, bars, leisure and shopping facilities. The green open spaces of Wandsworth Common and King George's Park are also close by.



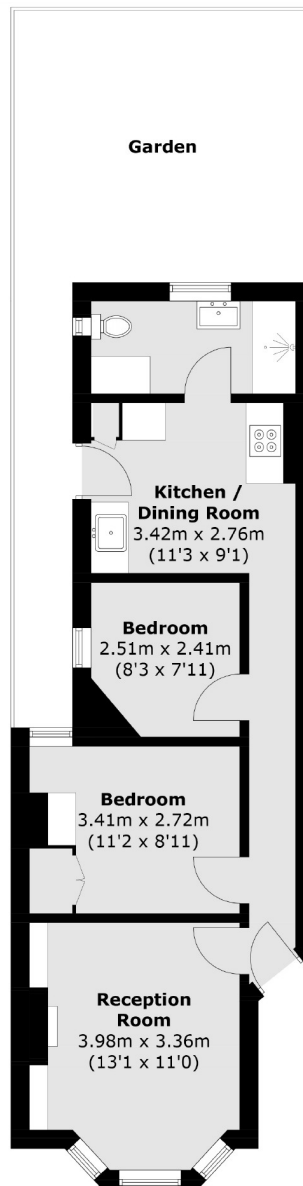

Total area (approx.): 49.4 sq. m (531.7 sq. ft)
Terrace : 28.0 sq. m (301.4 sq. ft)

Jacksons Wandsworth
507 Old York Road
London
SW18 1TF
020 8875 8890
wandsworth.sales@jacksonsestateagents.com

Energy Rating: We aim to make our particulars both accurate and reliable. However they are not guaranteed; nor do they form part of an offer or contract. If you require clarification on any points then please contact us, especially if you're traveling some distance to view. Please note that appliances and heating systems have not been tested and therefore no warranties can be given as to their good working order.