



Lancaster Mews, SW18

£525,000

A two bedroom ground floor garden flat located in a gated private development in the heart of Wandsworth. The property further benefits from allocated off street parking.

- Two Double Bedrooms
- Ground Floor
- Private Garden
- Allocated Parking
- Modern Kitchen
- Sought After Location



The property comprises; own front door leading to a bright and spacious reception room with space for a dining table, adjoining the reception room is a kitchen with modern units and integrated kitchen appliances, to the rear is a double bedroom with sash windows, a hallway with a useful storage cupboard leads onto the generous master bedroom and a contemporary bathroom suite. The flat benefits from a private garden and a private allotted parking space.

Lancaster Mews is situated close to Old York Road providing many restaurants and bars, and a variety of local shops. Southside shopping centre is also close hosting a Waitrose, a cinema complex and the high street shops within it. Wandsworth Town mainline station is near by with its services to Clapham Junction and to Waterloo and there are also numerous good bus services.





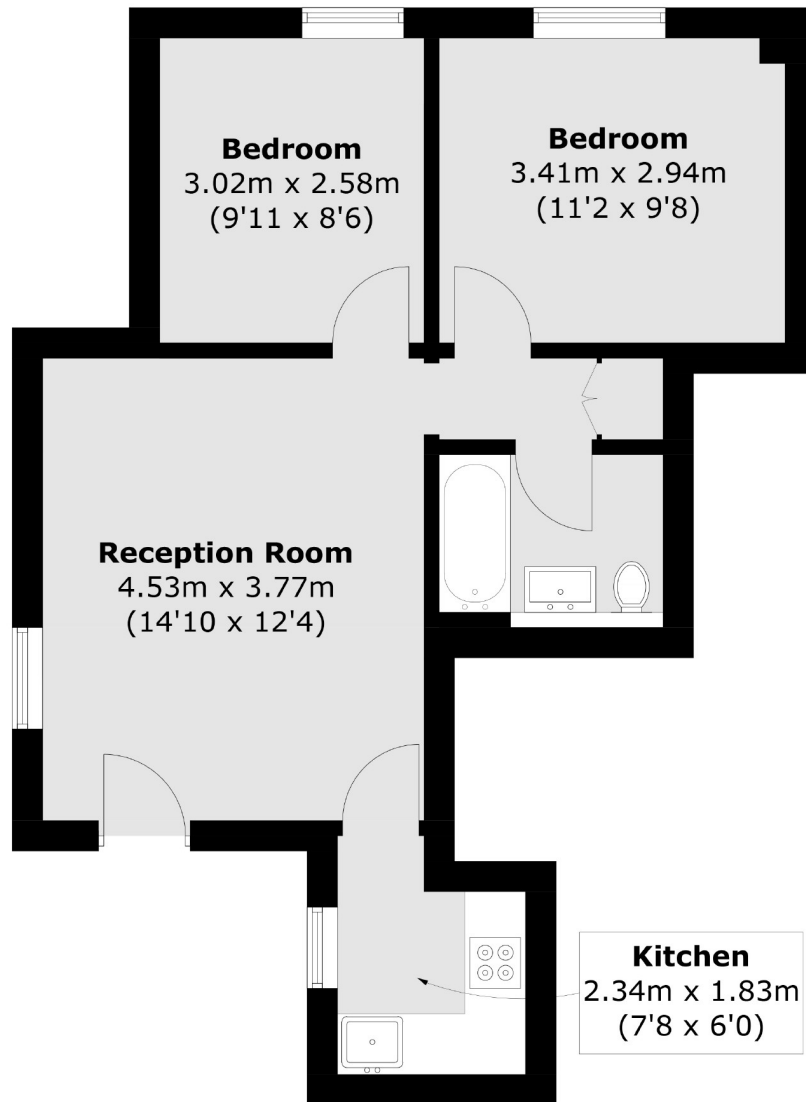

Total area (approx.): 46.5 sq. m (500.5 sq. ft)

Jacksons Wandsworth
507 Old York Road
London
SW18 1TF
020 8875 8890
wandsworth.sales@jacksonsestateagents.com

Energy Rating: We aim to make our particulars both accurate and reliable. However they are not guaranteed; nor do they form part of an offer or contract. If you require clarification on any points then please contact us, especially if you're traveling some distance to view. Please note that appliances and heating systems have not been tested and therefore no warranties can be given as to their good working order.