



AMESBURY AVENUE, SW2

£895,000

- Victorian property
- Four bedrooms
- Two bathrooms
- Extension potential
- Central location
- Energy rating: C





ABOUT THE HOME

A well-presented four bedroom Victorian family home on a sought after road in the heart of Streatham Hill.

Amesbury Avenue is within close proximity of numerous local bars, coffee shops, restaurants and both independent and high street retailers. Transport links are very flexible with railway services to Victoria via Clapham Junction at Streatham Hill station and the Victoria Line at Brixton easily accessible with a short bus journey.





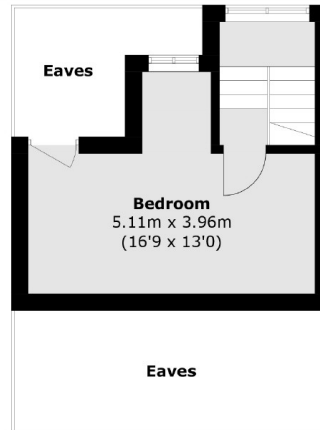

Second Floor

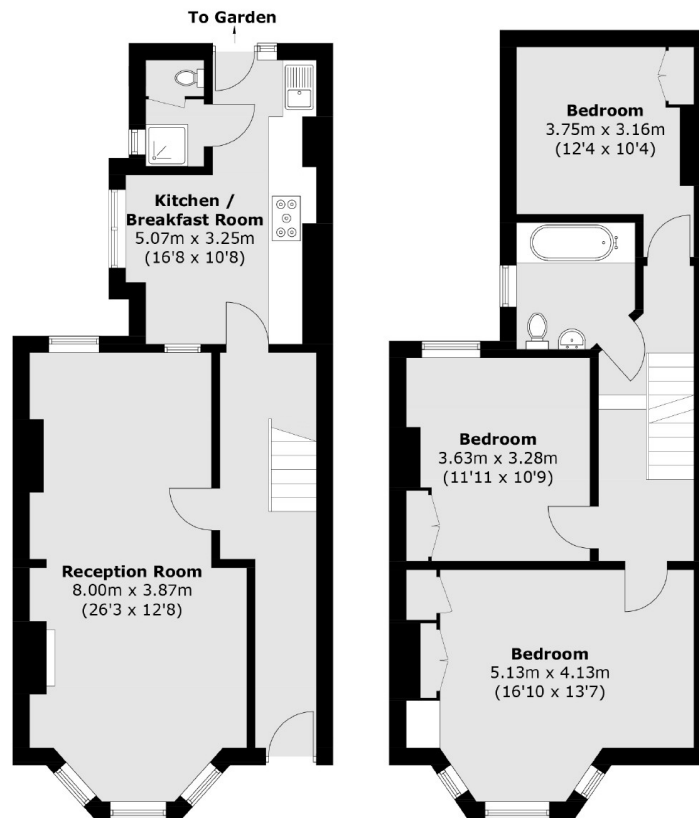

Ground Floor

First Floor

Total area (approx.): 129.1 sq. m (1,389.5 sq. ft)
(Excluding Eaves)

JACKSONS STREATHAM

1-3 De Montfort Parade,
Streatham High Road,
Sales: 020 8487 3179
Lettings: 020 8487 3180

Energy Rating: C We aim to make our particulars both accurate and reliable. However they are not guaranteed; nor do they form part of an offer or contract. If you require clarification on any points then please contact us, especially if you're traveling some distance to view. Please note that appliances and heating systems have not been tested and therefore no warranties can be given as to their good working order.