



HOPTON ROAD, SW16

£395,000

- Two bedroom flat
- Leasehold
- Quiet Residential Road

- Moments from Streatham Station
- Walking Distance to Streatham
- Energy rating: E



2



1



1





## ABOUT THE HOME

A beautifully presented flat in a historical conversion on a peaceful residential road in Streatham. The property boasts a superb geographical location, only a short distance from any essential amenities including retailers, fitness and leisure centres, and transport links including the Thameslink and Southern service.

The flat is located near the centre of Hopton Road, a short walk from a range of local amenities including Streatham Station, Streatham Common, and a host of retailers and leisure facilities. Transport links to London Bridge and Blackfriars is made easy with the Thameslink and Southern service from Streatham.







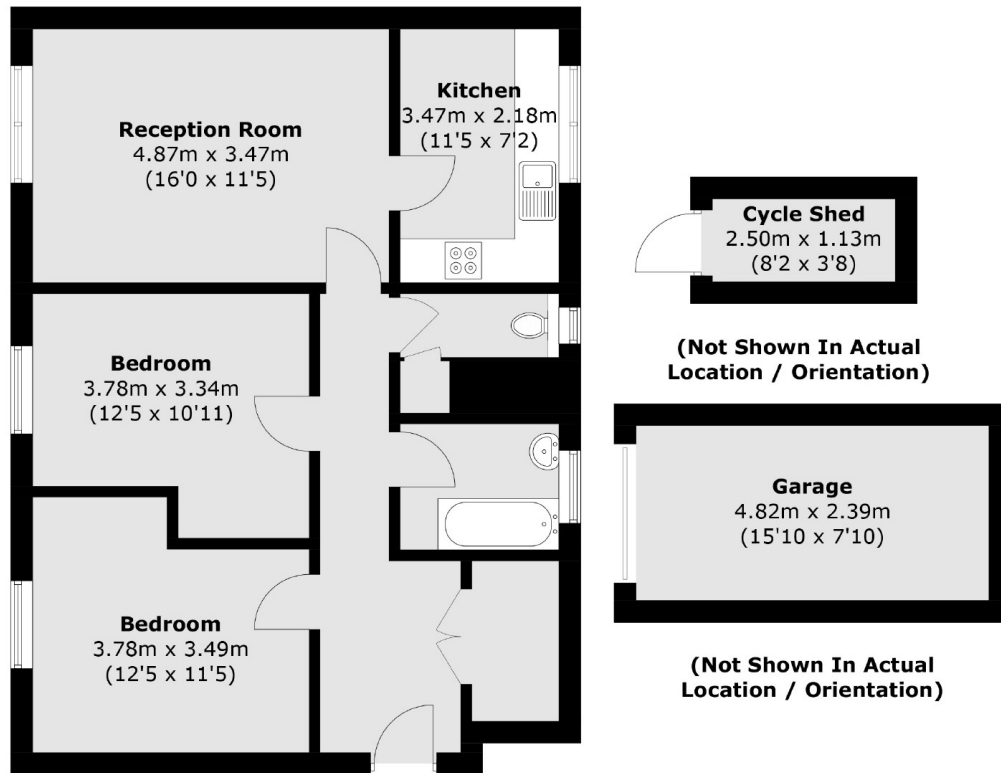

Total area (approx.): 70.7 sq. m (761.0 sq. ft)  
 Garage (approx.): 11.5 sq. m (123.8 sq. ft)  
 External Storage (approx.): 3.0 sq. m (32.3 sq. ft)

#### JACKSONS STREATHAM

1-3 De Montfort Parade,  
 Streatham High Road,  
 Sales: 020 8487 3179  
 Lettings: 020 8487 3180

Energy Rating: E We aim to make our particulars both accurate and reliable. However they are not guaranteed; nor do they form part of an offer or contract. If you require clarification on any points then please contact us, especially if you're traveling some distance to view. Please note that appliances and heating systems have not been tested and therefore no warranties can be given as to their good working order.