



Buckleigh Road, SW16

£5,200 PCM

A six bedroom detached Victorian family home with a very large garden and an exceptional amount of space. The property is presented in excellent condition and is very conveniently located.

- Six Bedrooms
- Two Bathrooms
- Large Garden
- Close to Streatham Common Station

For further information on the costs associated with renting a property, please pop into our office or visit our website.



Located moments away from Streatham Common and Streatham station, this property is ideally positioned for commuters, offering quick services to the City via Southern Rail & City Thameslink lines. There are several independent pubs, cafés, restaurants and a number of outstanding schools within striking distance, as well as gyms, a leisure centre and supermarkets, including an M&S food hall.

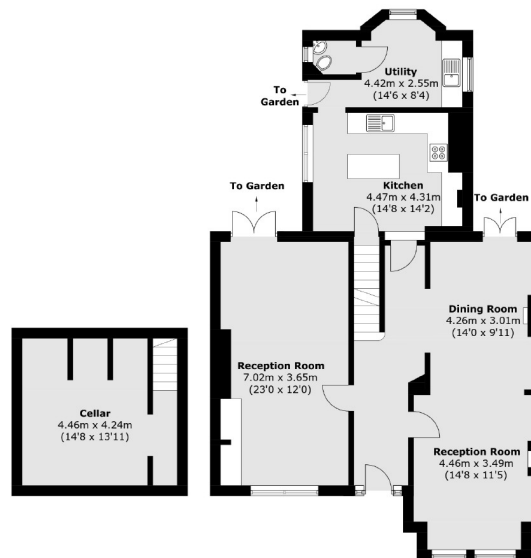

First Floor
Second Floor

Lower Ground Floor
Ground Floor

Total area (approx.): 248.4 sq. m (2,673.6 sq. ft)
(Including Cellar / Excluding Storage)

Jacksons Streatham
1-3 De Montfort Parade
Streatham High Road
Streatham
London
SW16 1BU

Energy Rating: We aim to make our particulars both accurate and reliable. However they are not guaranteed; nor do they form part of an offer or contract. If you require clarification on any points then please contact us, especially if you're traveling some distance to view. Please note that appliances and heating systems have not been tested and therefore no warranties can be given as to their good working order.