



Valley Road, SW16

£2,700 PCM

This three bedroom house would make an ideal home for three professionals, with vast reception spaces and a private rear garden.

- 1930's House
- Three Bedrooms
- Part Furnished
- Garden
- Separate Dining Room
- Storage

For further information on the costs associated with renting a property, please pop into our office or visit our website.



Valley Road is located close to Streatham Hill mainline station which offers an array of restaurants and bars as well as regular bus services to Brixton tube.



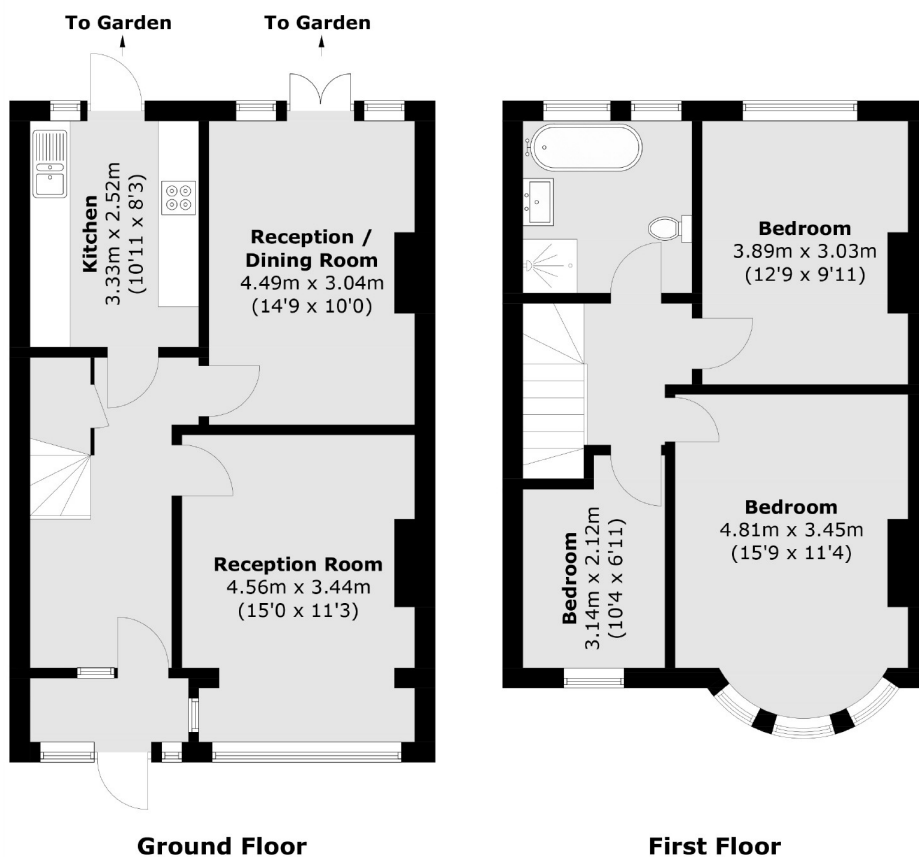

Total area (approx.): 100.3 sq. m (1,079.5 sq. ft)

Jacksons Streatham
1-3 De Montfort Parade
Streatham High Road
Streatham
London
SW16 1BU

Energy Rating: C We aim to make our particulars both accurate and reliable. However they are not guaranteed; nor do they form part of an offer or contract. If you require clarification on any points then please contact us, especially if you're traveling some distance to view. Please note that appliances and heating systems have not been tested and therefore no warranties can be given as to their good working order.