



Tierney Road, SW2

£1,500 PCM

A well presented split level flat located on the first floor of a Victorian conversion, located between Streatham Hill station and Brixton.

- Two Bedrooms
- Split Level
- Modern Kitchen
- Spacious Reception
- Modern Bathroom
- Communal Garden



Tierney Road is located within easy reach of Streatham Hill Station and Brixton.



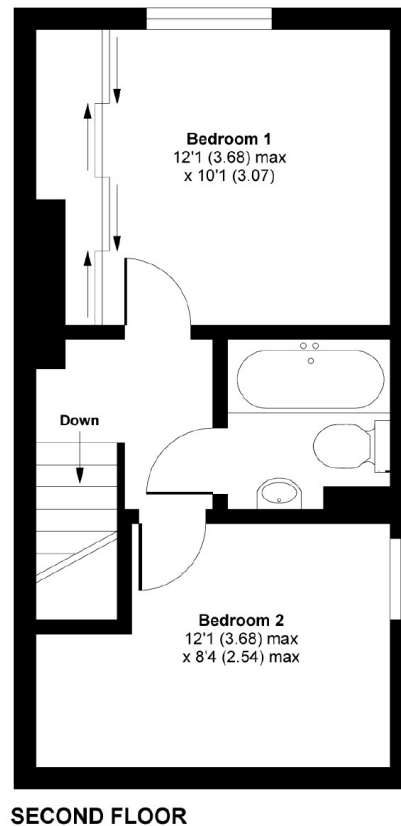
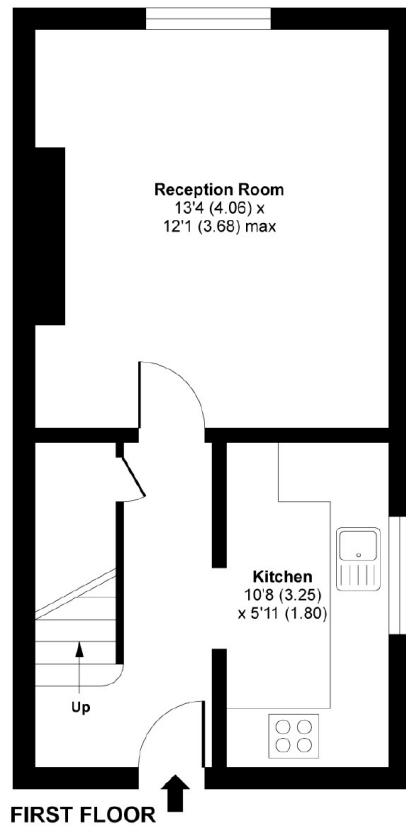

APPROX. GROSS INTERNAL FLOOR AREA 600 SQ FT 55.7 SQ METRES

Tierney Road, London, SW2

Copyright nichecom.co.uk 2013 Produced for Jacksons the Independent Estate Agents REF : 421483

Jacksons Streatham
1-3 De Montfort Parade
Streatham High Road
Streatham
London
SW16 1BU

Energy Rating: D We aim to make our particulars both accurate and reliable. However they are not guaranteed; nor do they form part of an offer or contract. If you require clarification on any points then please contact us, especially if you're traveling some distance to view. Please note that appliances and heating systems have not been tested and therefore no warranties can be given as to their good working order.