



STREATHAM HIGH ROAD, SW16

£495,000

- Four bedrooms
- Streatham Hill
- Great connections
- Good condition
- Large reception
- Energy rating: D





ABOUT THE HOME

A very spacious four bedroom mansion flat positioned close to Streatham Hill train station and Tooting Bec Common.

Leigham Hall is a well known mansion building on Streatham High Road, located moments from many of Streatham's vast array of amenities. Transport is plentiful from this location with many bus routes leading to Brixton and beyond and the local station of Streatham Hill providing swift links to Victoria via Clapham Junction.





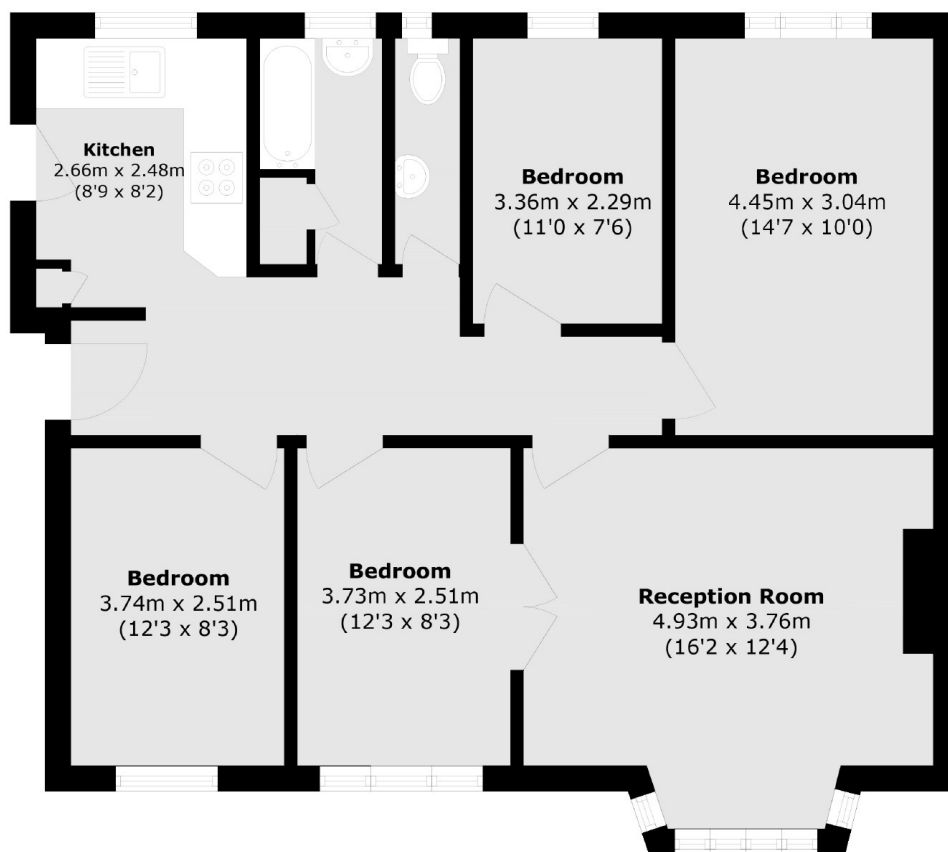

Total area (approx.): 77.9 sq. m (838.5 sq. ft)

JACKSONS STREATHAM

1-3 De Montfort Parade,
Streatham High Road,
Sales: 020 8487 3179
Lettings: 020 8487 3180

Energy Rating: D We aim to make our particulars both accurate and reliable. However they are not guaranteed; nor do they form part of an offer or contract. If you require clarification on any points then please contact us, especially if you're traveling some distance to view. Please note that appliances and heating systems have not been tested and therefore no warranties can be given as to their good working order.