



MARYLAND ROAD, CR7

£750,000

- Five Bedrooms with Study Room
- Good Condition
- Garage
- Freehold
- Large South Facing Garden
- Potential To Extend



6



2



3





## ABOUT THE HOME

A well-maintained five bedroom house situated on a quiet residential road . This property has potential to extend and boasts a very large south facing garden.

Maryland Road is situated just off Green Lane with access to numerous bus routes to the City and Norbury Station. Residents have easy access to a number of local amenities and direct access to Biggin Wood through the rear garden, and with close proximity to the Rookery.









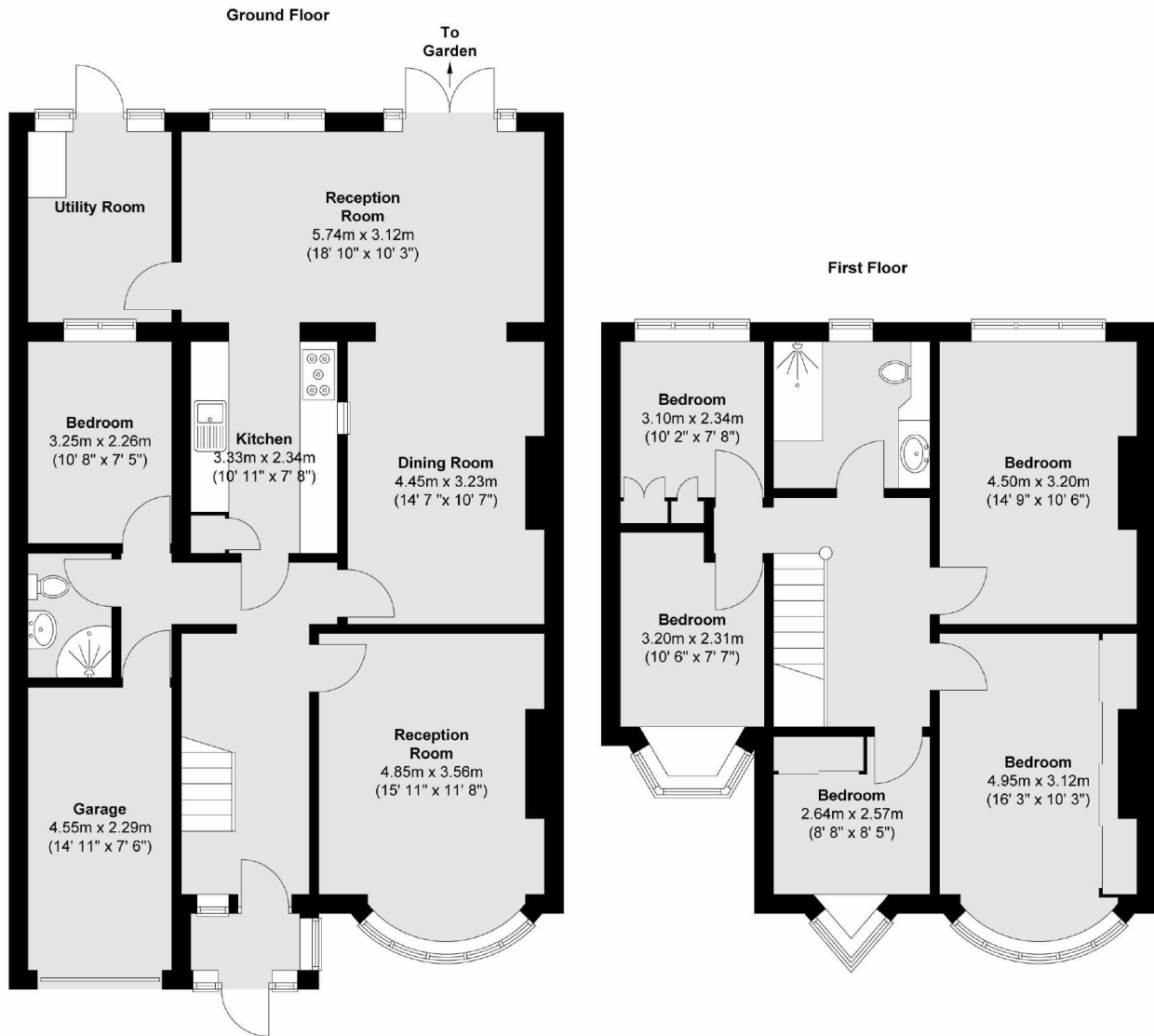

Total area (approx.) : 178 sq. m (1916 sq. ft)

### JACKSONS STREATHAM

1-3 De Montfort Parade,  
Streatham High Road,  
Sales: 020 8487 3179  
Lettings: 020 8487 3180

Energy Rating: D We aim to make our particulars both accurate and reliable. However they are not guaranteed; nor do they form part of an offer or contract. If you require clarification on any points then please contact us, especially if you're traveling some distance to view. Please note that appliances and heating systems have not been tested and therefore no warranties can be given as to their good working order.