



STREATHAM HIGH ROAD, SW16

£425,000

- Victorian mansion flat
- Two double bedrooms
- Excellent condition
- Close to Tooting Bec common
- Communal Garden
- Energy rating: C



2



1



1



## ABOUT THE HOME

A two bedroom Victorian Mansion Flat. This property is in excellent condition, has two double bedrooms and is in a central location, providing great access to transport links. The property further benefits from a communal garden, and parking for motorcycles & mopeds

The High is located on Streatham High Road and is close to Streatham Hill train station, offering regular services in to London Victoria via Balham and Clapham Junction. There are also numerous buses to Central London via Brixton. Extensive shopping options are also close by.







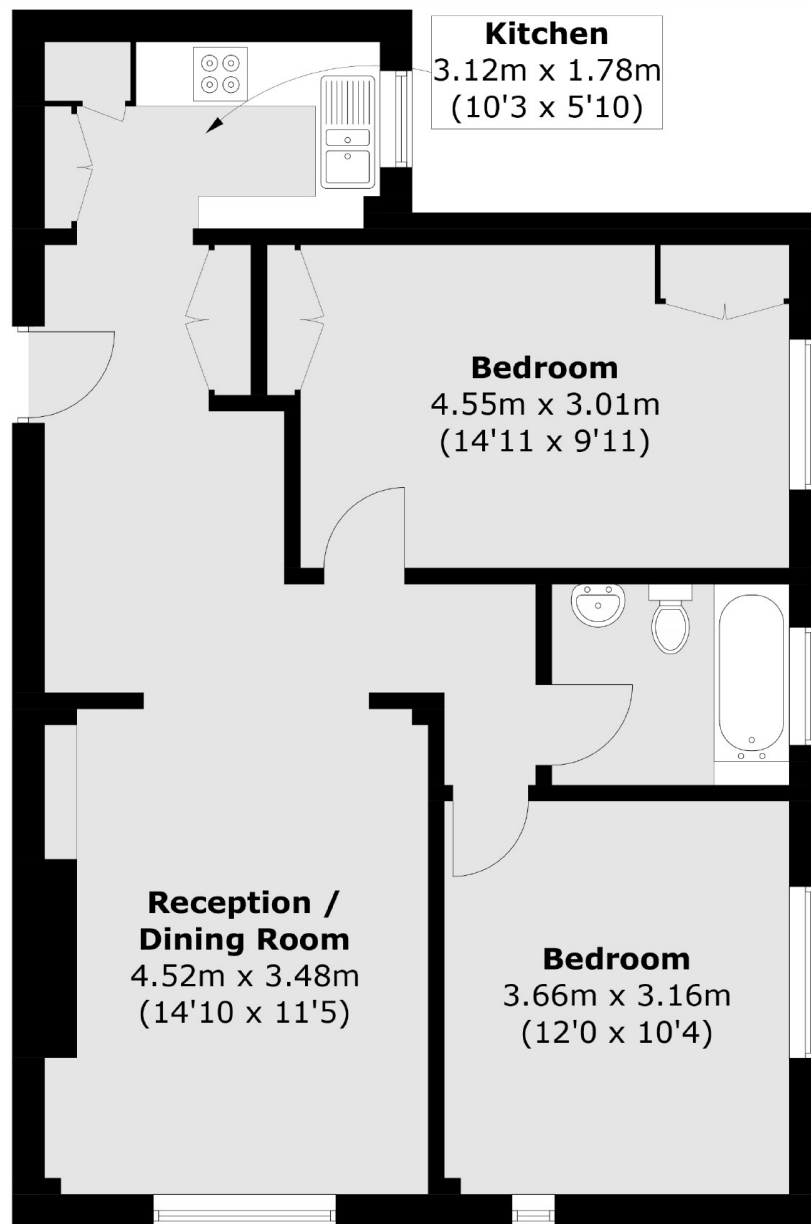

Total area (approx.): 67.3 sq. m (724.4 sq. ft)

#### **JACKSONS STREATHAM**

1-3 De Montfort Parade,  
Streatham High Road,  
Sales: 020 8487 3179  
Lettings: 020 8487 3180

Energy Rating: C We aim to make our particulars both accurate and reliable. However they are not guaranteed; nor do they form part of an offer or contract. If you require clarification on any points then please contact us, especially if you're traveling some distance to view. Please note that appliances and heating systems have not been tested and therefore no warranties can be given as to their good working order.