



## Streatham High Road, SW16

£2,150 PCM

A three bedroom apartment with a large roof terrace, in an excellent location close to transport and amenities of Streatham Hill.

- First Floor Flat
- Three Bedrooms
- Central Location
- Modern Bathroom
- Large Roof Terrace
- Close to Transport

For further information on the costs associated with renting a property, please pop into our office or visit our website.



Leigham Hall is a centrally located mansion building built in the 1930's. The apartment is within close proximity of Streatham Hill station, bus routes to Brixton and numerous amenities including restaurants and coffee shops.



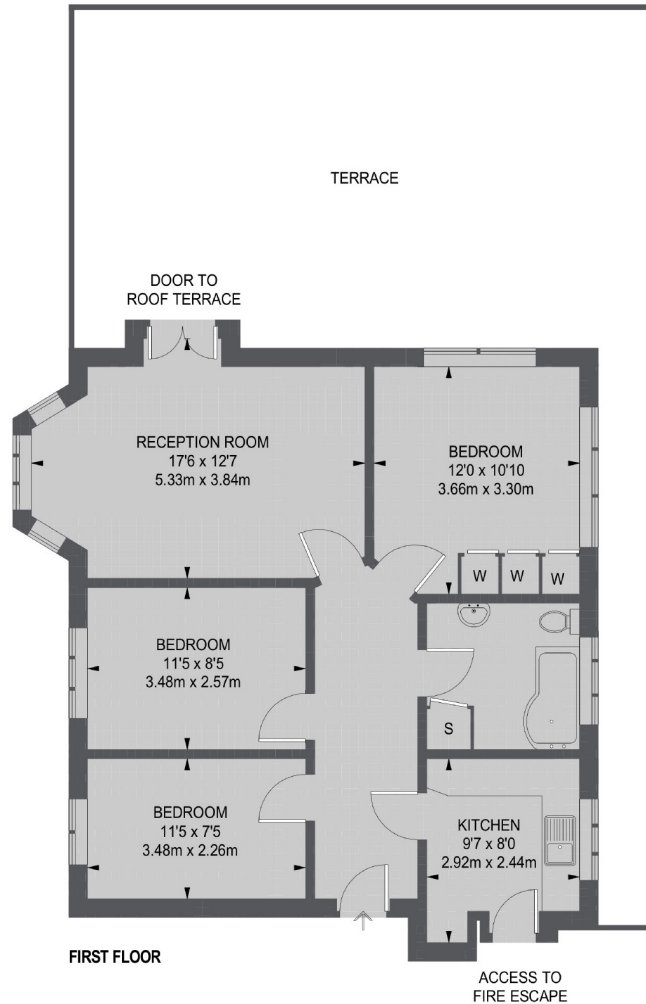

TOTAL APPROX. FLOOR AREA 768 SQ. FT. ( 71.36 SQ. M.)

Jacksons Streatham  
 1-3 De Montfort Parade  
 Streatham High Road  
 Streatham  
 London  
 SW16 1BU

Energy Rating: D We aim to make our particulars both accurate and reliable. However they are not guaranteed; nor do they form part of an offer or contract. If you require clarification on any points then please contact us, especially if you're traveling some distance to view. Please note that appliances and heating systems have not been tested and therefore no warranties can be given as to their good working order.