



PRENTIS ROAD, SW16

£650,000

- Victorian conversion
- Two double bedrooms
- Tooting Bec Common
- Off- street parking
- Large south facing Garden
- Energy rating: C





ABOUT THE HOME

A ground floor, Victorian conversion with a private rear garden, two double bedrooms and generous living space. Located on a popular road, ideally located for Streatham Hill, Balham and Brixton.

Prentis Road is an attractive tree line road located close to Tooting Bec Common and numerous shops, bars and restaurants on Streatham High Road. Commuters have regular links to the City including the Thameslink at Streatham, Streatham Hill Station and numerous bus routes via Balham and Brixton.





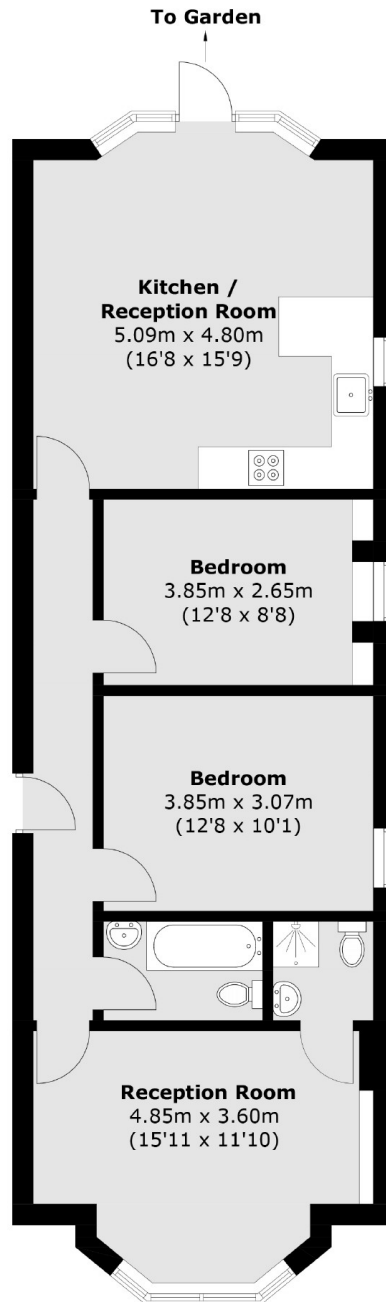

Total area (approx.): 76.4 sq. m (822.4 sq. ft)

JACKSONS STREATHAM

1-3 De Montfort Parade,
Streatham High Road,
Sales: 020 8487 3179
Lettings: 020 8487 3180

Energy Rating: C We aim to make our particulars both accurate and reliable. However they are not guaranteed; nor do they form part of an offer or contract. If you require clarification on any points then please contact us, especially if you're traveling some distance to view. Please note that appliances and heating systems have not been tested and therefore no warranties can be given as to their good working order.