



Montrell Road, SW2

£1,700 PCM

A well located two bedroom conversion flat with a shared garden.

- Two Bedrooms
- Ground Floor Flat
- Own Entrance
- Shared Garden
- Newly Decorated
- Close to Transport

For further information on the costs associated with renting a property, please pop into our office or visit our website.



Montrell Road is a quiet road located moments from Streatham Hill station and easily accessible to an array of bus routes as well as the many shops, bars and restaurants offered by Streatham High Road.



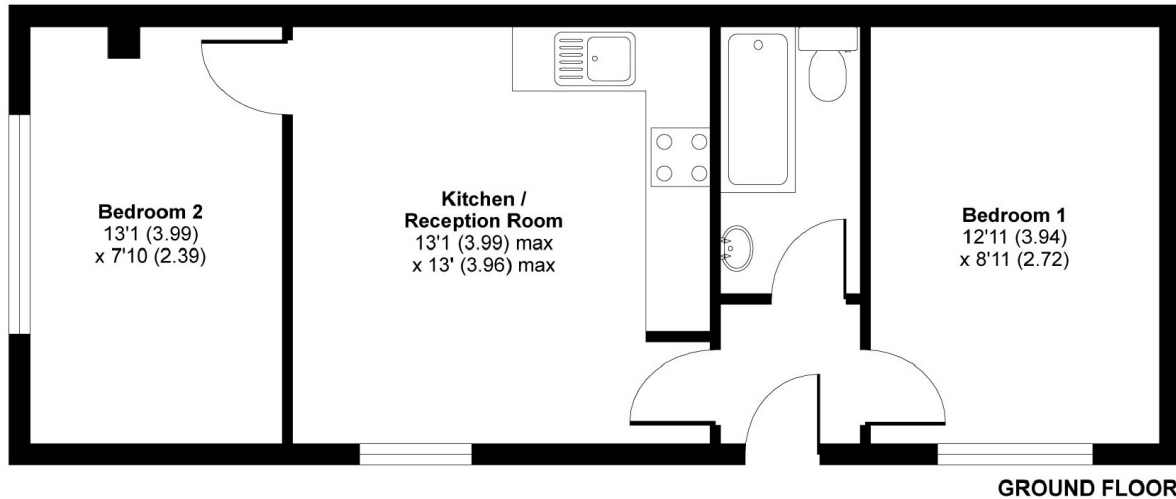

APPROX. GROSS INTERNAL FLOOR AREA 457 SQ FT 42.4 SQ METRES

No House Number, Property Address Here

Copyright nichecom.co.uk 2012 Produced for Jacksons the Independent Estate Agents REF : 305488

Jacksons Streatham
1-3 De Montfort Parade
Streatham High Road
Streatham
London
SW16 1BU

Energy Rating: D We aim to make our particulars both accurate and reliable. However they are not guaranteed; nor do they form part of an offer or contract. If you require clarification on any points then please contact us, especially if you're traveling some distance to view. Please note that appliances and heating systems have not been tested and therefore no warranties can be given as to their good working order.