



VALLEYFIELD ROAD, SW16

£770,000

- Three bedroom family home
- Off-street parking
- Large garden
- Original features
- Extension potential stpp
- Energy rating: D





ABOUT THE HOME

A Semi-Detached three bedroom family home located on a sought after residential road in Streatham. The property has a large south facing garden and off street parking.

Valleyfield Road is a very popular residential road predominantly made up of family homes located within close proximity to a number of outstanding schools, local amenities and transport links, including Streatham Rail, West Norwood, Streatham Hill and Streatham Common stations. Residents have easy access to Streatham Common and The Rookery in addition to a number of independent cafes, bars and restaurants. Valleyfield Road also offers eye opening panoramic views of the city.





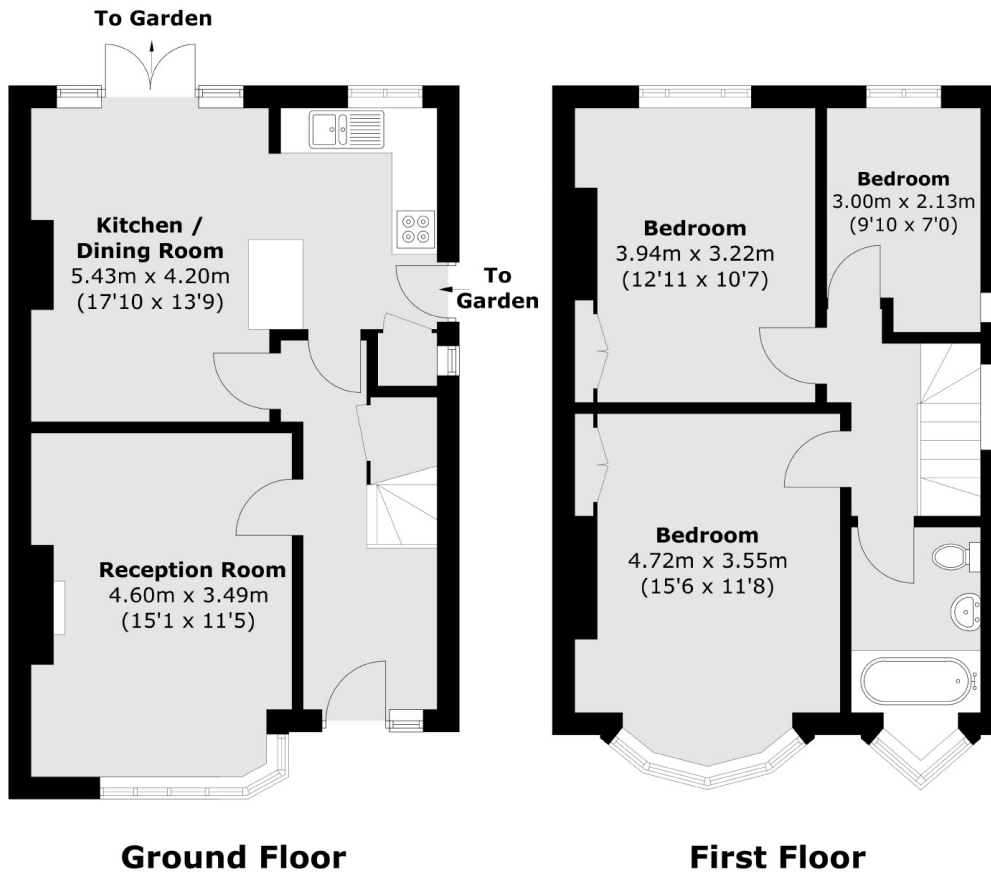

Total area (approx.): 92.5 sq. m (995.6 sq. ft)

JACKSONS STREATHAM

1-3 De Montfort Parade,
Streatham High Road,
Sales: 020 8487 3179
Lettings: 020 8487 3180

Energy Rating: D We aim to make our particulars both accurate and reliable. However they are not guaranteed; nor do they form part of an offer or contract. If you require clarification on any points then please contact us, especially if you're traveling some distance to view. Please note that appliances and heating systems have not been tested and therefore no warranties can be given as to their good working order.