



Tierney Road, SW2

£2,100,000

A semi detached period house on a beautiful residential road in Streatham Hill, boasting five double bedrooms, larger than average garden and benefits from having off-street parking.

- Large Victorian Family Home
- Semi-Detached
- Five Bedrooms
- Large Private Garden
- Off Street Parking
- Over 3000sqft



Further benefits include a large eat-in kitchen, two large reception rooms and the house retains many of its original Victorian features including marble fireplaces.

Tierney Road is well located near Streatham Hill. It offers excellent access to numerous bus routes to Central London. Streatham Hill Mainline, Brixton (Victoria line) and Clapham South (Northern line) underground station are all easily accessible. The restaurants and amenities of Streatham Hill and Brixton are also close by. There are numerous outstanding schools in the area including Dulwich which is very accessible.





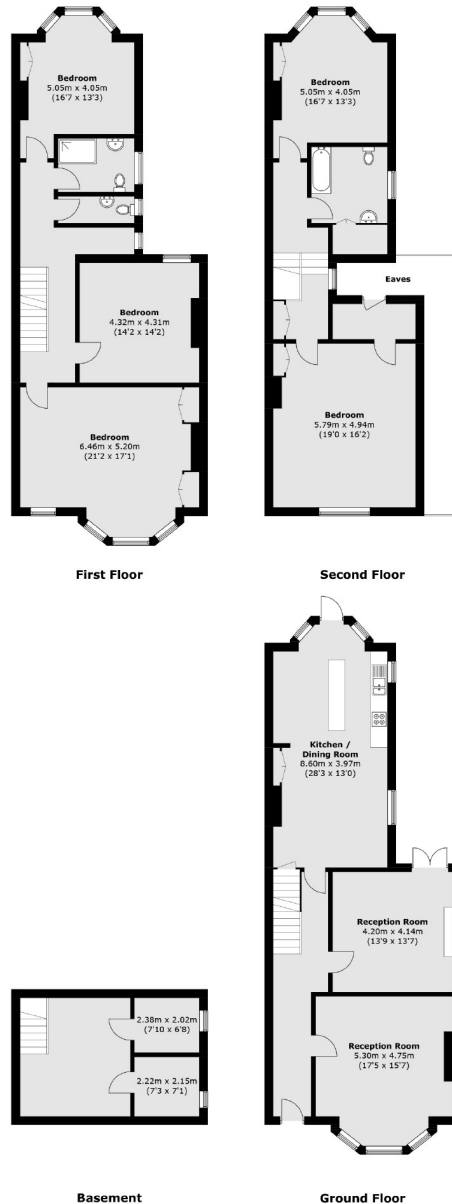

Total area (approx.): 281.6 sq. m (3,031.1 sq. ft)
(Excluding Eaves)

Jacksons Streatham
1-3 De Montfort Parade
Streatham High Road
Streatham
London
SW16 1BU

Energy Rating: D We aim to make our particulars both accurate and reliable. However they are not guaranteed; nor do they form part of an offer or contract. If you require clarification on any points then please contact us, especially if you're traveling some distance to view. Please note that appliances and heating systems have not been tested and therefore no warranties can be given as to their good working order.