



Streatham High Road, SW16

£2,200 PCM

A three bedroom apartment located on Streatham High Road, Ideal for three professional sharers.

- Three Good Sized Double Bedrooms
- Spacious Reception Room
- Modern Fitted Kitchen
- Excellent Storage

For further information on the costs associated with renting a property, please pop into our office or visit our website.



The High is located on Streatham High Road and is close to Streatham Hill train station, offering regular services in to London Victoria via Balham and Clapham Junction. There are also numerous buses to Central London via Brixton. Extensive shopping options are also close by.



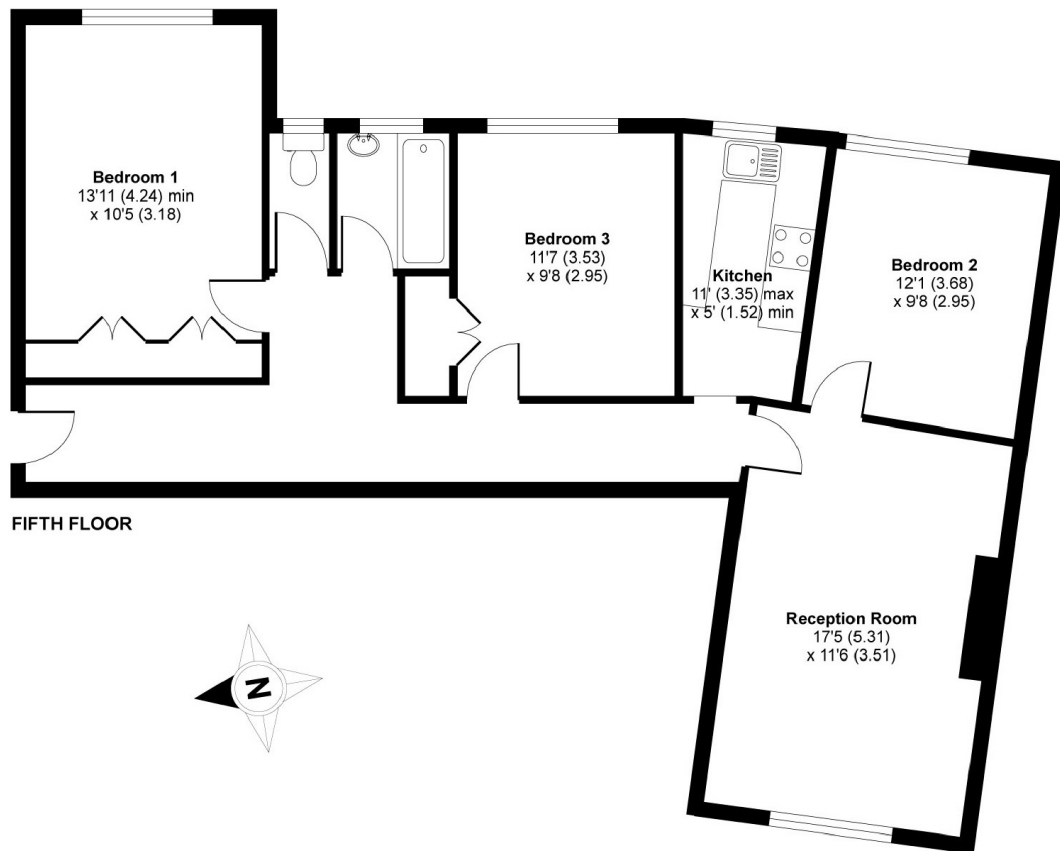

APPROX. GROSS INTERNAL FLOOR AREA 901 SQ FT 83.7 SQ METRES

The High, Streatham High Road, London, SW16

Copyright nichecom.co.uk 2014 Produced for Jacksons the Independent Estate Agents REF : 548262

Jacksons Streatham
1-3 De Montfort Parade
Streatham High Road
Streatham
London
SW16 1BU

Energy Rating: We aim to make our particulars both accurate and reliable. However they are not guaranteed; nor do they form part of an offer or contract. If you require clarification on any points then please contact us, especially if you're traveling some distance to view. Please note that appliances and heating systems have not been tested and therefore no warranties can be given as to their good working order.