



Thurlow Park Road, SE21

£2,300 PCM

Arranged over two floors is this large three bedroom first floor flat. This property also benefits from a communal garden.

- Spacious Reception Room
- Two Double Bedrooms
- Third Smaller Bedroom
- Split Level
- Communal Garden
- Close to West Dulwich Station

For further information on the costs associated with renting a property, please pop into our office or visit our website.



The property is conveniently located opposite West Dulwich train station which provides easy access to London Victoria. The many amenities of West Dulwich and Dulwich Village are also in close proximity.



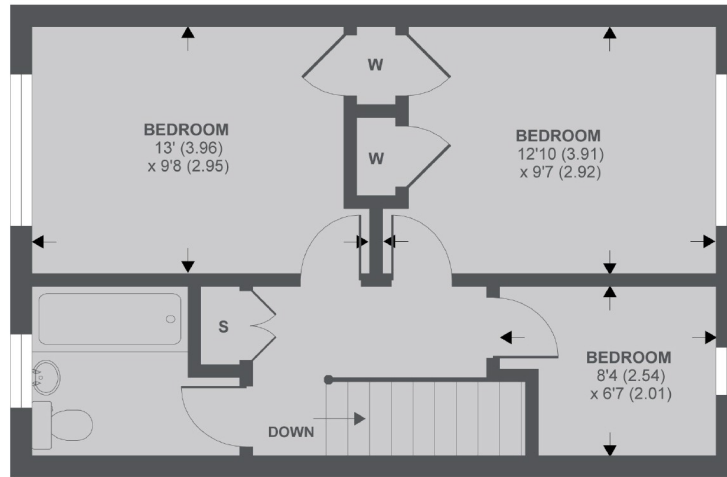

2nd Floor

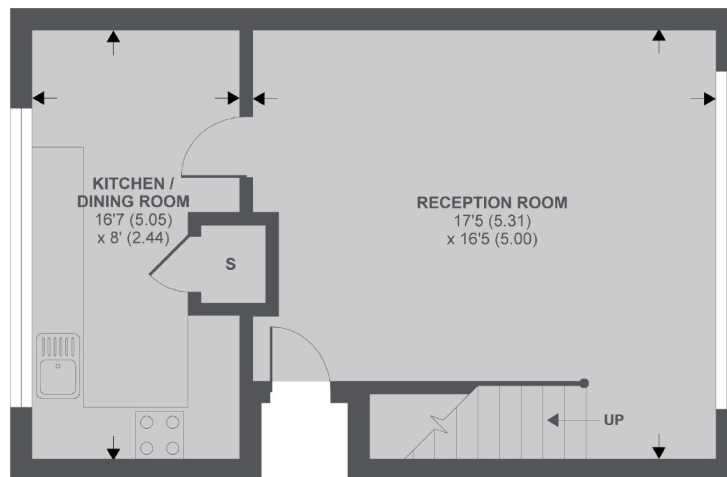

1st Floor

APPROX. GROSS INTERNAL FLOOR AREA 853 SQ FT 79.2 SQ METRES

Copyright nichecom.co.uk 2019 REF : 510745

Jacksons Streatham
1-3 De Montfort Parade
Streatham High Road
Streatham
London
SW16 1BU

Energy Rating: C We aim to make our particulars both accurate and reliable. However they are not guaranteed; nor do they form part of an offer or contract. If you require clarification on any points then please contact us, especially if you're traveling some distance to view. Please note that appliances and heating systems have not been tested and therefore no warranties can be given as to their good working order.