



Norfolk House Road, SW16

£495,000

A one bedroom Victorian conversion flat which has been recently refurbished to a high standard. The property is situated in the heart of Streatham Hill and also boasts a private south facing garden.

- Victorian Conversion Flat
- One Double Bedroom
- South Facing Garden
- Share of Freehold
- Recently Refurbished
- Potential To Extend



Norfolk House Road is a highly desirable tree lined road situated in the heart of Streatham Hill within reach of amenities from both Streatham High Road and Balham as well as being close to Tooting Bec Common. In addition there are a number of outstanding schools within catchment including Henry Cavendish Primary School. Commuters have easy access to numerous transport links including Streatham Hill station with regular trains to London Victoria, Thameslink services from Streatham Station and numerous bus routes to the City via Brixton.



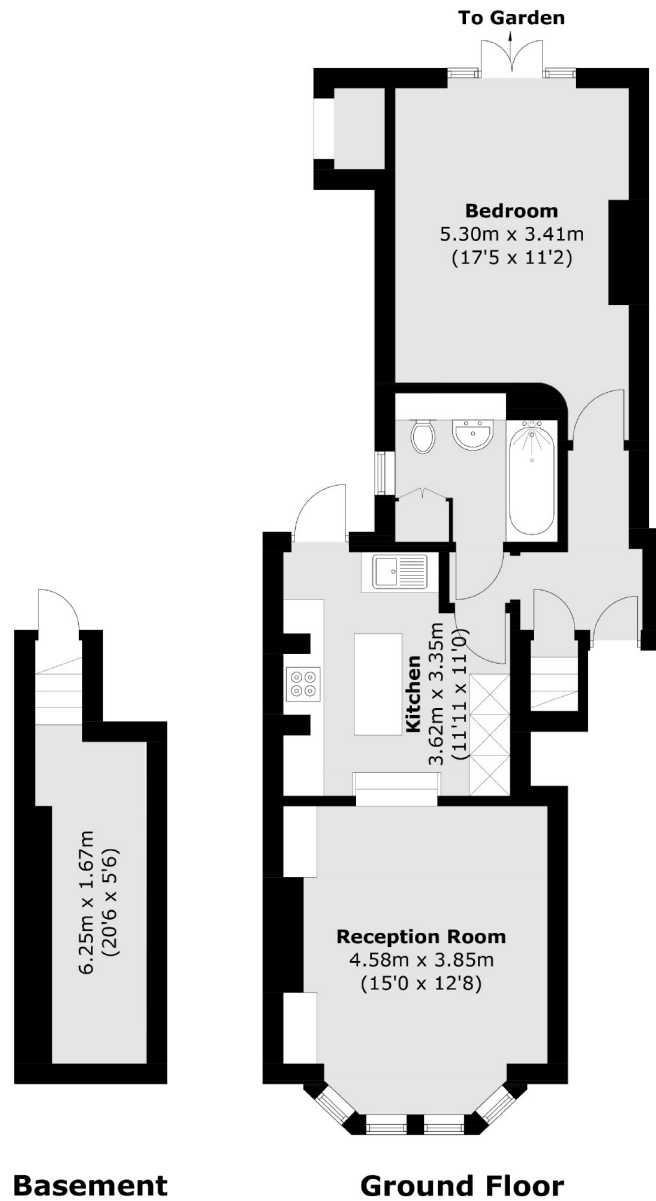

Total area (approx.): 65.6 sq. m (706.1 sq. ft)

Jacksons Streatham
1-3 De Montfort Parade
Streatham High Road
Streatham
London
SW16 1BU

Energy Rating: We aim to make our particulars both accurate and reliable. However they are not guaranteed; nor do they form part of an offer or contract. If you require clarification on any points then please contact us, especially if you're traveling some distance to view. Please note that appliances and heating systems have not been tested and therefore no warranties can be given as to their good working order.