



St. Julians Farm Road, SE27

£1,400,000

A lovely Victorian detached family home with a large rear kitchen extension on a popular residential road close to West Norwood train station.

- Detached Period Home
- Four Double Bedrooms
- Two Receptions
- Rear Kitchen Extension
- Off-street Parking
- Rear Garden Annex



St. Julians Farm Road is close to West Norwood Station with frequent services to London Bridge and Victoria. The shops, bars, restaurants and cafés along Knights Hill and Norwood Road are all close by.





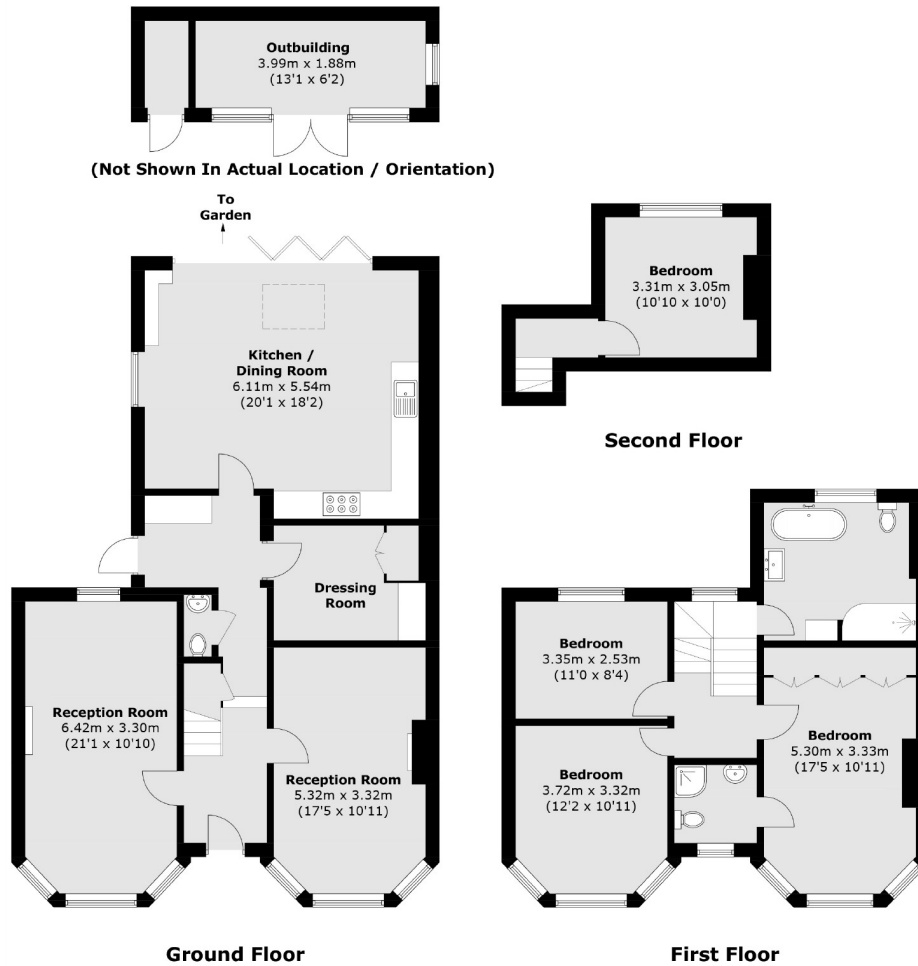

Total area (approx.): 166.8 sq. m (1,795.4 sq. ft)
Outbuilding: 12.0 sq. m (129.2 sq. ft)

Jacksons Streatham
1-3 De Montfort Parade
Streatham High Road
Streatham
London
SW16 1BU

Energy Rating: E We aim to make our particulars both accurate and reliable. However they are not guaranteed; nor do they form part of an offer or contract. If you require clarification on any points then please contact us, especially if you're traveling some distance to view. Please note that appliances and heating systems have not been tested and therefore no warranties can be given as to their good working order.