



## Tylecroft Road, SW16

£475,000

Presented in excellent condition, a bright and spacious two bedroom freehold cottage with rarely available period features and a private south facing garden, thoughtfully maintained by the current owners.

- Two Bedrooms
- Cottage
- Freehold
- Garden
- Excellent Condition
- Close to Norbury Station



Tylecroft Road is a popular residential road in Norbury only a short distance from Norbury High Street offering a range of shops, cafés and other amenities. Norbury station is nearby and offers regular links into both Victoria and London Bridge.





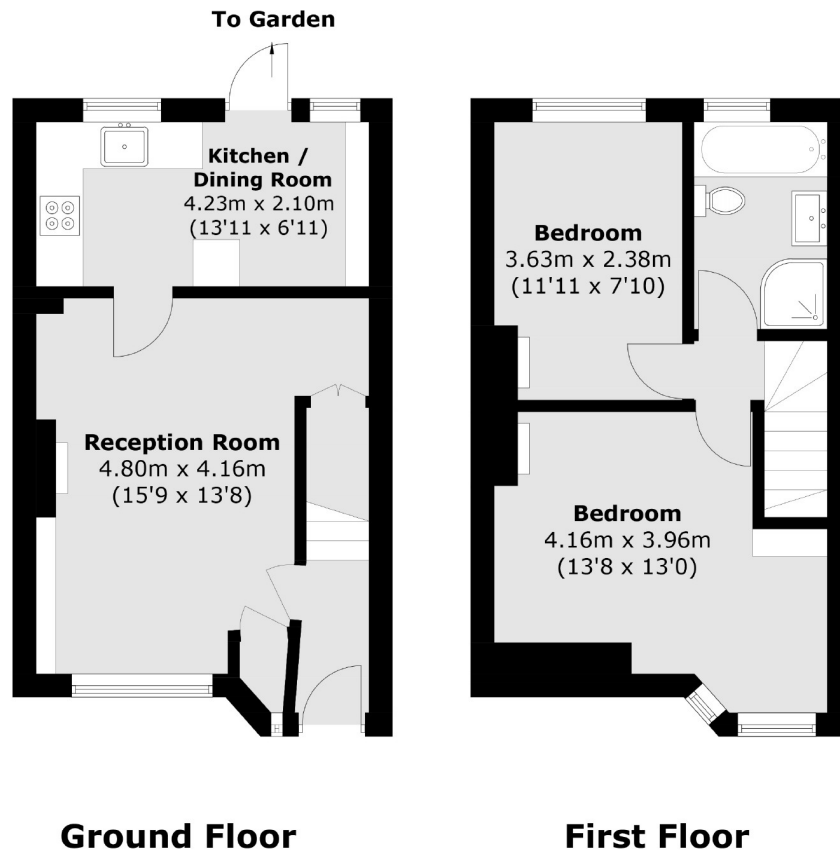

Total area (approx.): 61.6 sq. m (663.0 sq. ft)

Jacksons Streatham  
1-3 De Montfort Parade  
Streatham High Road  
Streatham  
London  
SW16 1BU

Energy Rating: D We aim to make our particulars both accurate and reliable. However they are not guaranteed; nor do they form part of an offer or contract. If you require clarification on any points then please contact us, especially if you're traveling some distance to view. Please note that appliances and heating systems have not been tested and therefore no warranties can be given as to their good working order.