



Streatham High Road, SW16

£450,000

A spacious three bedroom mansion flat in a beautiful art deco building located closely to transport links in Streatham Hill. This property includes a large reception/dining room and is in immaculate condition.

- Three Bedrooms
- Victorian Mansion Flat
- Communal Gardens
- Close Proximity To Station
- Excellent Condition
- Share Of Freehold



Streatham Court is a popular development set back from Streatham High Road offering easy access to both Streatham Hill Station and the local amenities.



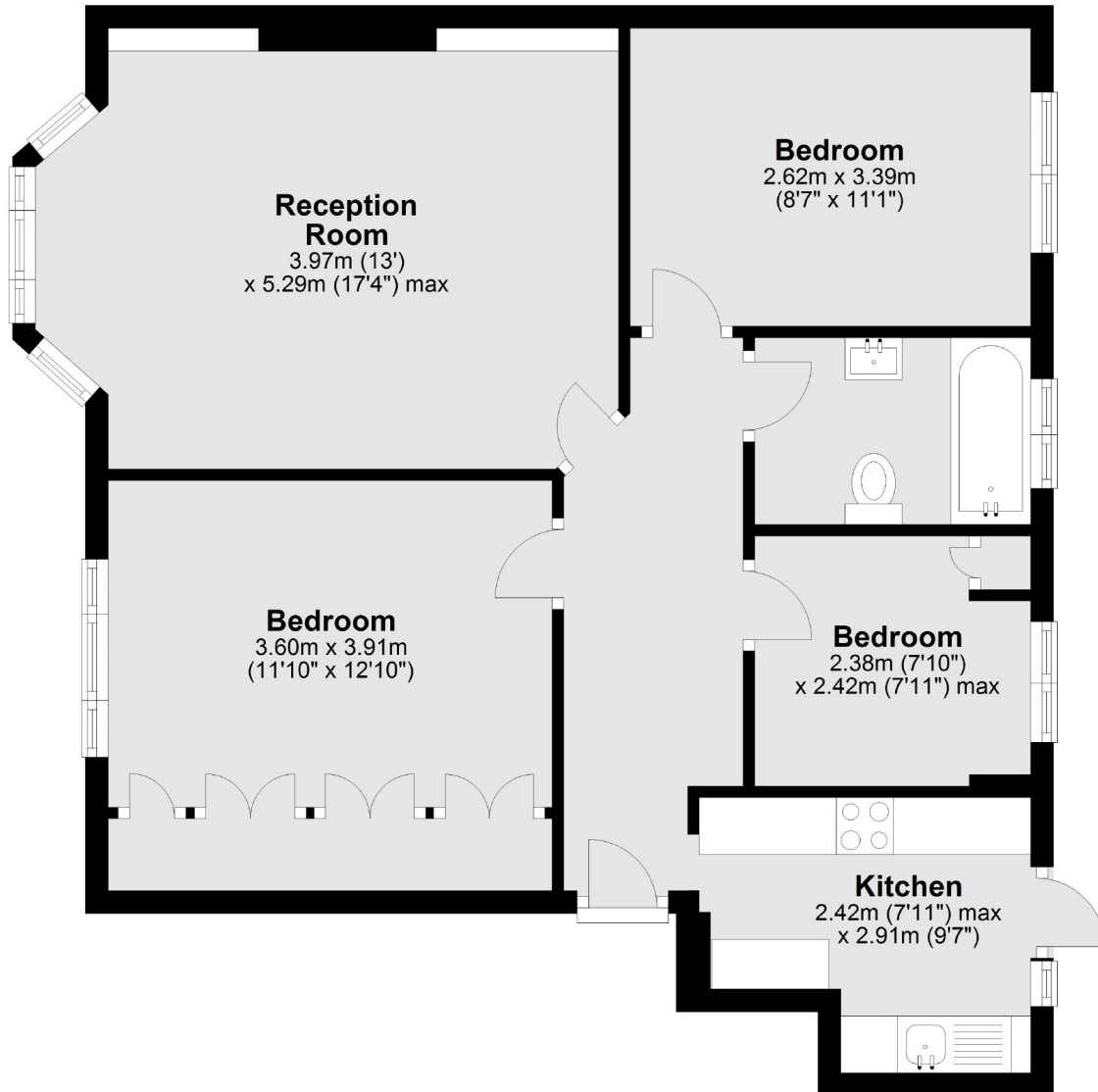

Total area: approx. 66.8 sq. metres (718.6 sq. feet)

Jacksons Streatham
1-3 De Montfort Parade
Streatham High Road
Streatham
London
SW16 1BU

Energy Rating: We aim to make our particulars both accurate and reliable. However they are not guaranteed; nor do they form part of an offer or contract. If you require clarification on any points then please contact us, especially if you're traveling some distance to view. Please note that appliances and heating systems have not been tested and therefore no warranties can be given as to their good working order.