



Valley Road, SW16

£250,000

A one bedroom flat. This property has a double bedroom, reception room and separate kitchen. It also benefits from having designated off-street parking, a communal garden and is within close proximity to Streatham Common.

- Period Converted Flat
- One Double Bedroom
- Share of Freehold
- Communal Garden
- Off-Street Parking
- Close to Streatham Common

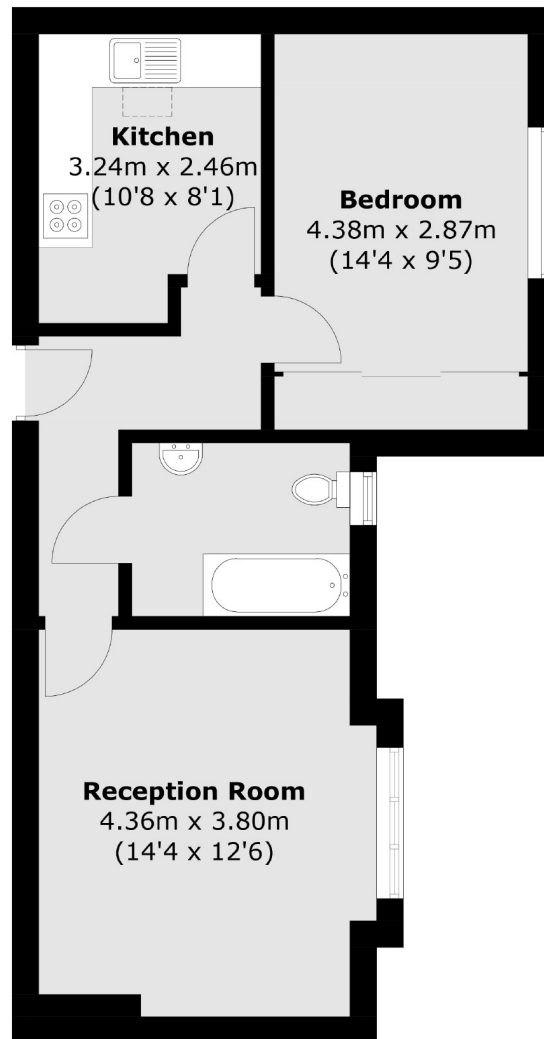

Total area (approx.): 48.4 sq. m (521.0 sq. ft)

Jacksons Streatham
1-3 De Montfort Parade
Streatham High Road
Streatham
London
SW16 1BU
020 8677 9900

Energy Rating: D We aim to make our particulars both accurate and reliable. However they are not guaranteed; nor do they form part of an offer or contract. If you require clarification on any points then please contact us, especially if you're traveling some distance to view. Please note that appliances and heating systems have not been tested and therefore no warranties can be given as to their good working order.