



The Mead

Darlington DL1 1EX

Price Range £130,000





This footer paragraph is an example only and should not be relied upon as complying with current legislation. These particulars, whilst believed to be accurate are set out as a general outline only for guidance and do not constitute any part of an offer or contract. Intending purchasers should not rely on them as statements of representation of fact, but must satisfy themselves by inspection or otherwise as to their accuracy. No person in this firms employment has the authority to make or give any representation or warranty in respect of the property.

The Mead

Darlington DL1 1EX



- Three Bedroom Property
- Council Tax Band B

- Location
- EPC Rating E

- Off Street Parking

This well presented three bedroom semi detached property comes to the market and is located in the ever popular Eastbourne area close to local shops and amenities and close to Darlington town centre. The property in our opinion would make an ideal family home.

In brief the property Comprises: Entrance Hall, lounge, dining room, kitchen, three bedrooms to the first floor and Family bathroom. Externally the property has a garden to the rear and off street parking to the front.

Viewing is recommended.

Porch

5'11" x 3'0" (1.810 x 0.930)

Upvc double glazed door to front.

Entrance Hall

11'9" x 5'11" (3.588 x 1.813)

Stairs to first floor

Reception Room One

13'5" x 11'11" (4.104 x 3.636)

Upvc double glazed bow window to front.

Reception Room Two

12'3" x 11'11" (3.744 x 3.651)

French doors to rear and storage cupboard.

Kitchen

14'7" x 6'2" (4.446 x 1.884)

Upvc double glazed window to rear and side, wall base and drawer units, ceramic sink, electric hob and oven. Space for fridge freezer and washing machine. Upvc door to side.

First Floor Landing

Stairs to fully boarded loft via drop down.

Bedroom One

12'4" x 11'10" (3.775 x 3.629)

Upvc double glazed window to front and electric heater.

Bedroom Two

10'7" x 8'10" (3.238 x 2.694)

Upvc double glazed window to front and electric heater.

Bedroom Three

8'3" x 7'4" (2.515 x 2.248)

Upvc double glazed window to front and electric heater.

Bathroom

11'10" x 6'3" (3.618 x 1.918)

Externally

Off street parking to front. Rear is laid to lawn.

Council Tax

Band B

Tenure

Freehold

Note

IMPORTANT NOTE TO PURCHASERS: We endeavour to make our sales particulars accurate and reliable, however, they do not constitute or form part of an offer or any contract and none is to be relied upon as statements of representation or fact. The services, systems and appliances listed in this specification have not been tested by us and no guarantee as to their operating ability or efficiency is given. All measurements have been taken as a guide to prospective buyers only, and are not precise. Floor plans where included are not to scale and accuracy is not guaranteed. If you require clarification or further information on any points, please contact us, especially if you are travelling some distance to view. Fixtures and fittings other than those mentioned are to be agreed with the seller. We cannot also confirm at this stage of marketing the tenure of this house

GROUND FLOOR

1ST FLOOR

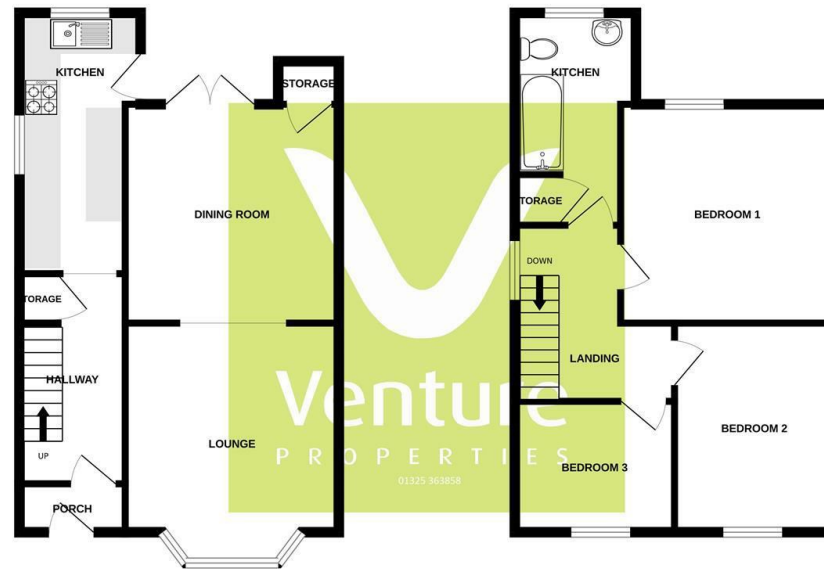

Whilst every attempt has been made to ensure the accuracy of the floorplan contained here, measurements of doors, windows, rooms and any other items are approximate and no responsibility is taken for any error, omission or mis-statement. This plan is for illustrative purposes only and should be used as such by any prospective purchaser. The services, systems and appliances shown have not been tested and no guarantee as to their operability or efficiency can be given.
Made with Metreplan ©2024

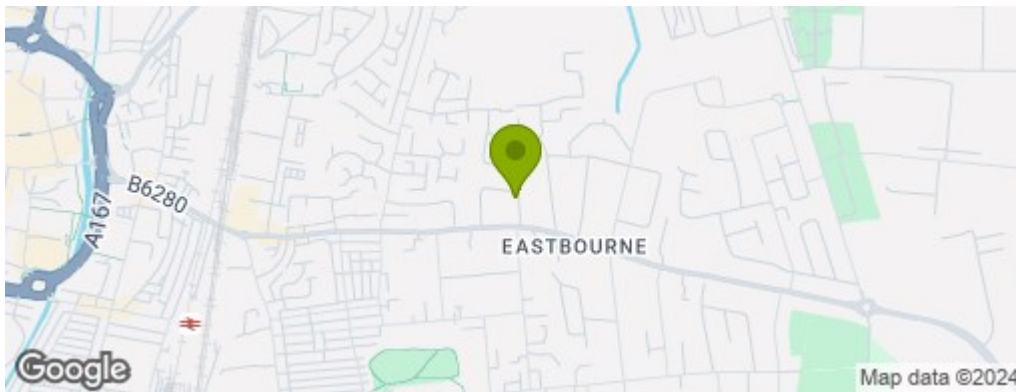

Property Information

01325 363858

45 Duke Street, Darlington, County Durham, DL3 7SD
sales@venturepropertiesuk.com