



**St. Pauls Terrace**

Darlington DL1 2HE

**£132,500**







This footer paragraph is an example only and should not be relied upon as complying with current legislation. These particulars, whilst believed to be accurate are set out as a general outline only for guidance and do not constitute any part of an offer or contract. Intending purchasers should not rely on them as statements of representation of fact, but must satisfy themselves by inspection or otherwise as to their accuracy. No person in this firms employment has the authority to make or give any representation or warranty in respect of the property.





This footer paragraph is an example only and should not be relied upon as complying with current legislation. These particulars, whilst believed to be accurate are set out as a general outline only for guidance and do not constitute any part of an offer or contract. Intending purchasers should not rely on them as statements of representation of fact, but must satisfy themselves by inspection or otherwise as to their accuracy. No person in this firms employment has the authority to make or give any representation or warranty in respect of the property.





# St. Pauls Terrace

Darlington DL1 2HE



- Two Bedroom Terraced Property
- Rear Yard

- Close to Amenities
- Council Tax Band A

- Ideal Investment Opportunity
- Epc Rating D

St. Pauls Terrace in Darlington, is a well presented three bedroom, mid terrace property, ideal for first time buyers or investors alike. Within easy reach of amenities, schools, retail park, green spaces and access to the A1 Motorway.

The property is tastefully decorated in neutral colours and benefits from Gas Central heating, Upvc Double Glazing and a modern and fresh Kitchen.

With its blend of character and practicality, this terraced house is sure to attract interest. Do not miss the chance to make this lovely home your own.

## Entrance Hall

Upvc door to front.

## Lounge

11'11 x 11'6 (3.63m x 3.51m)

Upvc double glazed bow window to front, deep coving to ceiling, brick fireplace with hearth, encasing log burning stove and radiator.

## Dining Room

12'4 x 11'6 (3.76m x 3.51m)

Upvc double glazed window to rear, radiator and laminate flooring.

## Kitchen

13'5 x 7'3 (4.09m x 2.21m)

Upvc double glazed window to side, fitted with modern white high gloss wall, base and drawer units. Composite sink with mixer tap, integrated electric hob with extractor over and oven. There is space for a washing machine and fridge freezer. Part tiled New York style tiled walls and tiled floor with spotlights to ceiling and door to rear.

## First Floor Landing

### Bedroom One

15'1 x 11'11 (4.60m x 3.63m)

Upvc double glazed window to front, deep coving to ceiling and radiator and cast iron fireplace.

### Bedroom Two

12'2 x 8'10 (3.71m x 2.69m)

Upvc double glazed window to rear, deep coving to ceiling, fireplace and radiator.

### Bedroom Three

7'3 x 6'10 (2.21m x 2.08m)

Upvc double glazed windows to rear and side with radiator. This room is currently set up as an office which is useful for people who work from home.

## Bathroom

Fitted bath with central mixer taps, shower over and screen. Low level w.c, wash hand basin with mixer tap and tiled walls.

## Externally

To the front is a gated forecourt.

To the rear is an enclosed paved yard with gated access to rear, storage shed and outside tap.

## Tenure

Freehold

## Property Details

Local Authority: Darlington

Council Tax Band: A

Annual Price: £1,581

Conservation Area: No

Flood Risk: Very low

Floor Area: 957 ft 2 / 89 m 2

Plot size: 0.02 acres

Mobile coverage

EE

Vodafone

Three

O2

Broadband

Basic

9 Mbps

Superfast

71 Mbps

Ultrafast

10000 Mbps

Satellite / Fibre TV Availability

BT

Sky

Virgin

## Note

IMPORTANT NOTE TO PURCHASERS: We endeavour to make our sales particulars accurate and reliable, however, they do not constitute or form part of an offer or any contract and none is to be relied upon as statements of representation or fact. The services, systems and appliances listed in this specification have not been tested by us and no guarantee as to their operating ability or efficiency is given. All measurements have been taken as a guide to prospective buyers only, and are not precise. Floor plans where included are not to scale and accuracy is not guaranteed. If you require clarification or further information on any points, please contact us, especially if you are travelling some distance to view. Fixtures and fittings other than those mentioned are to be agreed with the seller. We cannot also confirm at this stage of marketing the tenure of this house

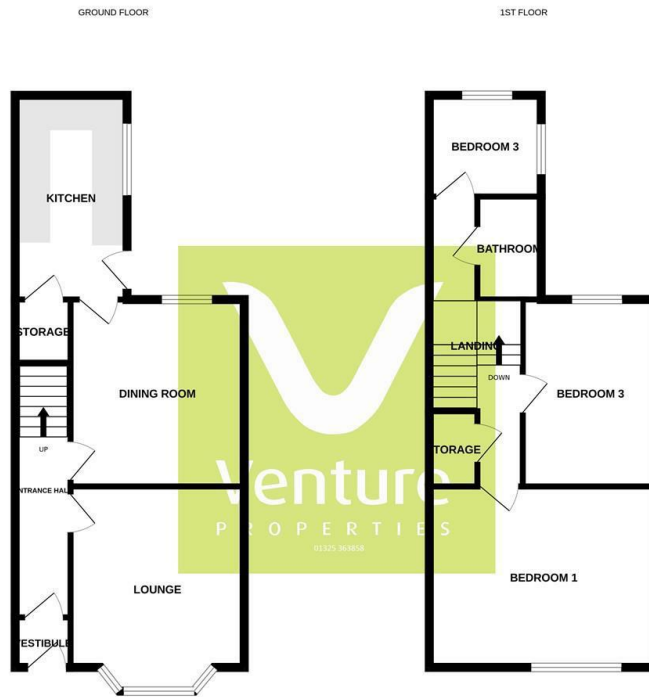

Whilst every attempt has been made to ensure the accuracy of the floorplan contained here, measurements of doors, windows, rooms and any other items are approximate and no responsibility is taken for any error, omission or mis-statement. This plan is for information purposes only and should be used as such by any prospective purchaser. The services, systems and appliances shown have not been tested and no guarantee as to their operability or efficiency can be given.  
Made with Metronix 02025

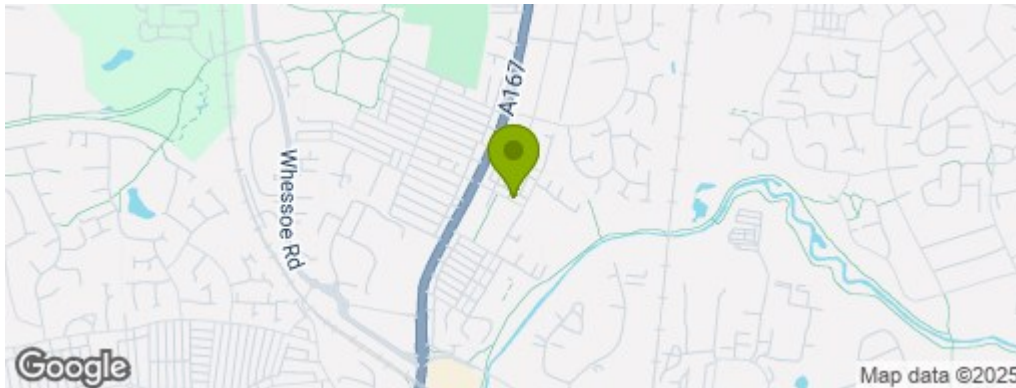

## Property Information

**01325 363858**

45 Duke Street, Darlington, County Durham, DL3 7SD  
sales@venturepropertiesuk.com