



Lowson Street

Darlington DL3 0EY

£149,950



Venture
PROPERTIES



This footer paragraph is an example only and should not be relied upon as complying with current legislation. These particulars, whilst believed to be accurate are set out as a general outline only for guidance and do not constitute any part of an offer or contract. Intending purchasers should not rely on them as statements of representation of fact, but must satisfy themselves by inspection or otherwise as to their accuracy. No person in this firms employment has the authority to make or give any representation or warranty in respect of the property.



This footer paragraph is an example only and should not be relied upon as complying with current legislation. These particulars, whilst believed to be accurate are set out as a general outline only for guidance and do not constitute any part of an offer or contract. Intending purchasers should not rely on them as statements of representation of fact, but must satisfy themselves by inspection or otherwise as to their accuracy. No person in this firms employment has the authority to make or give any representation or warranty in respect of the property.



Lowson Street

Darlington DL3 0EY



- Three Bedroom Terraced Property
- No Onward Chain

- Fully Refurbished
- EPC Rating C

- Original Features
- Council Tax Band A

This immaculately presented, updated and improved three bedroom mid terraced property comes to the market with no onward chain and is located in the Harrowgate Hill area of Darlington within easy reach of many amenities including schooling and retail parks. The property is in ready to move into condition and offers versatile flexible living space, gas central heating, upvc double glazing, two reception rooms, modern fitted kitchen and first floor bathroom.

The property benefits from LVT flooring, insulated internal walls, C rated EPC and original features.

Viewing is recommended.

Entrance Hall

Upvc door to front, staircase to first floor landing and radiator.

Lounge

14'5" x 12'1" (4.4 x 3.7)

Upvc double glazed bay window to front, electric fire in surround and radiator.

Dining Room

12'9" x 12'5" (3.9 x 3.8)

Upvc double glazed window to rear, electric fire in surround and radiator.

Kitchen

15'1" x 8'10" (4.6 x 2.7)

Upvc double glazed window to side, fitted with wall, base and drawer units, stainless steel sink with mixer tap and a four ring gas hob with eye level oven. There is space for a fridge freezer and washing machine, radiator and door to side.

Downstairs Cloaks

With w.c, wash hand basin, heated towel rail and storage cupboard.

First Floor Landing

With storage cupboard and access to loft.

Bedroom One

16'0" x 12'5" (4.9 x 3.8)

Upvc double glazed window to front, original fireplace and radiator.

Bedroom Two

12'5" x 9'10" (3.8 x 3)

Upvc double glazed window to rear and radiator.

Bedroom Three

10'5" x 8'10" (3.2 x 2.7)

Upvc double glazed window to rear and radiator.

Bathroom

Upvc double glazed obscure window to side, bath with shower over and screen, w.c, wash hand basin and heated towel rail.

Externally

To the rear is an enclosed yard with gated access.

Property Information

Local Authority

Darlington

Council Tax

Band:

A

Annual Price:

£1,506

Conservation Area

No

Flood Risk

No Risk

Floor Area

1,162 ft² / 108 m²

Plot size

0.02 acres

Mobile coverage

EE

Vodafone

Three

02

Broadband

Basic

5 Mbps

Superfast

53 Mbps

Ultrafast

1000 Mbps

Satellite / Fibre TV Availability

BT

Sky

Tenure

Freehold

Note

IMPORTANT NOTE TO PURCHASERS: We endeavour to make our sales particulars accurate and reliable, however, they do not constitute or form part of an offer or any contract and none is to be relied upon as statements of representation or fact. The services, systems and appliances listed in this specification have not been tested by us and no guarantee as to their operating ability or efficiency is given. All measurements have been taken as a guide to prospective buyers only, and are not precise. Floor plans where included are not to scale and accuracy is not guaranteed. If you require clarification or further information on any points, please contact us, especially if you are travelling some distance to view. Fixtures and fittings other than those mentioned are to be agreed with the seller. We cannot also confirm at this stage of marketing the tenure of this house

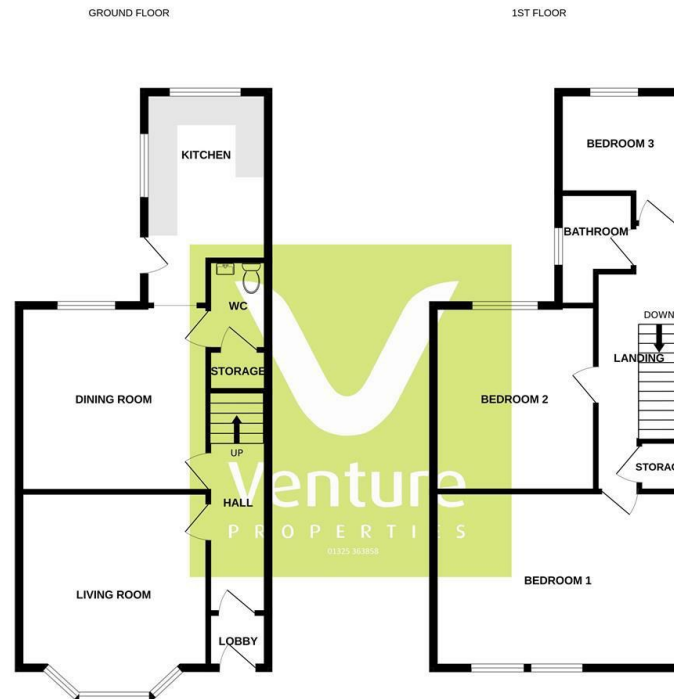

Whilst every attempt has been made to ensure the accuracy of the floorplan contained herein, measurements of doors, windows, rooms and any other items are approximate and no responsibility is taken for any error, omission or misstatement. This plan is for guidance purposes only and should be used as such by any prospective purchaser. The dimensions, square metres and approximate room sizes are given for information only and no guarantee as to their accuracy or efficiency can be given.
Made with Mapbox CSD25

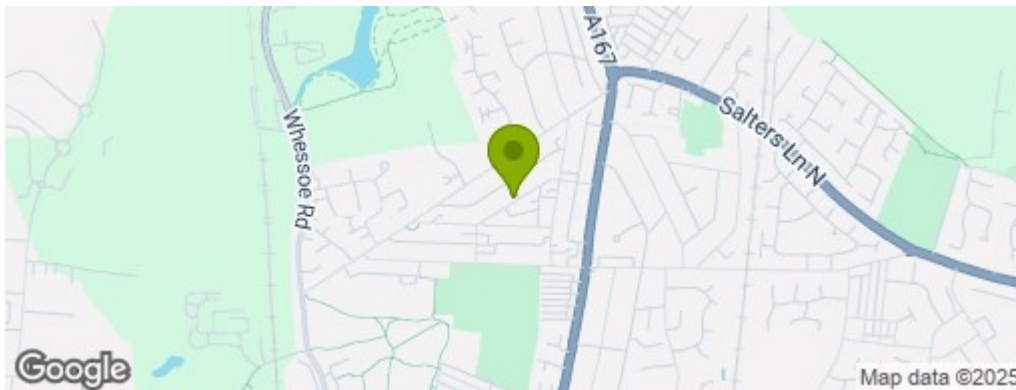

Property Information

01325 363858

45 Duke Street, Darlington, County Durham, DL3 7SD
sales@venturepropertiesuk.com