



Easson Road

Darlington DL3 6BB

£55,000





This footer paragraph is an example only and should not be relied upon as complying with current legislation. These particulars, whilst believed to be accurate are set out as a general outline only for guidance and do not constitute any part of an offer or contract. Intending purchasers should not rely on them as statements of representation of fact, but must satisfy themselves by inspection or otherwise as to their accuracy. No person in this firm's employment has the authority to make or give any representation or warranty in respect of the property.



This footer paragraph is an example only and should not be relied upon as complying with current legislation. These particulars, whilst believed to be accurate are set out as a general outline only for guidance and do not constitute any part of an offer or contract. Intending purchasers should not rely on them as statements of representation of fact, but must satisfy themselves by inspection or otherwise as to their accuracy. No person in this firm's employment has the authority to make or give any representation or warranty in respect of the property.



Easson Road

Darlington DL3 6BB



- Ideal Investment
- Attic Room
- EPC Grade TBC

- Three Bedroom Mid Terrace
- No Chain
- Priced To Sell

- Two Reception Rooms
- Close To Town Centre

Welcome to Easson Road, Darlington - a great location for this terraced house! This property boasts 2 reception rooms, 3 bedrooms, and 1 bathroom, offering ample space for a growing family or those who love to entertain.

Situated in a sought-after area, this three-bedroom mid-terrace home is a fantastic opportunity for those looking to put their own stamp on a property.

Although the property may need some tender loving care, it is priced to sell and is offered with no chain, making it an attractive option for those looking to make a smart investment. Don't miss out on the chance to transform this house into a beautiful home that reflects your style and personality.

Contact us today to arrange a viewing and envision the endless possibilities that this property on Easson Road has to offer.

Entrance Hallway

With stairs to the first floor.

Lounge

11'9" x 13'1" (3.6 x 4.0)

Situated to the front with central heating radiator and double glazed bay window.

Dining Room

11'9" x 12'9" (3.6 x 3.9)

Situated to the rear with double glazed window and central heating radiator.

Kitchen

6'2" x 12'5" (1.9 x 3.8)

Situated to the rear with a range of wall and floor units, contrasting worksurfaces, electric cooker point, window to rear elevation, rear back door and understairs store cupboard.

First Floor

With stairs to the attic room

Bedroom 1

12'5" x 9'2" (3.8 x 2.8)

Situated to the front with double glazed window and central heating radiator.

Bedroom 2

9'2" x 12'9" (2.8 x 3.9)

Situated to the rear with double glazed window and central heating radiator.

Bedroom 3

5'10" x 12'5" max (1.8 x 3.8 max)

Situated to the front with double glazed window and central heating radiator.

Bathroom/W.C

6'2" x 9'2" (1.9 x 2.8)

Situated to the rear with a suite comprising panelled bath, pedestal wash hand basin and low level W.C.

Attic Room

With central heating radiator and velux window to front and rear elevation.

Outside

The home has an enclosed yard to rear.

Note

IMPORTANT NOTE TO PURCHASERS: We endeavour to make our sales particulars accurate and reliable, however, they do not constitute or form part of an offer or any contract and none is to be relied upon as statements of representation or fact. The services, systems and appliances listed in this specification have not been tested by us and no guarantee as to their operating ability or efficiency is given. All measurements have been taken as a guide to prospective buyers only, and are not precise. Floor plans where included are not to scale and accuracy is not guaranteed. If you require clarification or further information on any points, please contact us, especially if you are travelling some distance to view. Fixtures and fittings other than those mentioned are to be agreed with the seller. We cannot also confirm at this stage of marketing the tenure of this house

Council Tax

Tenure

Freehold

Disclaimer

All services/appliances have not and will not be tested.

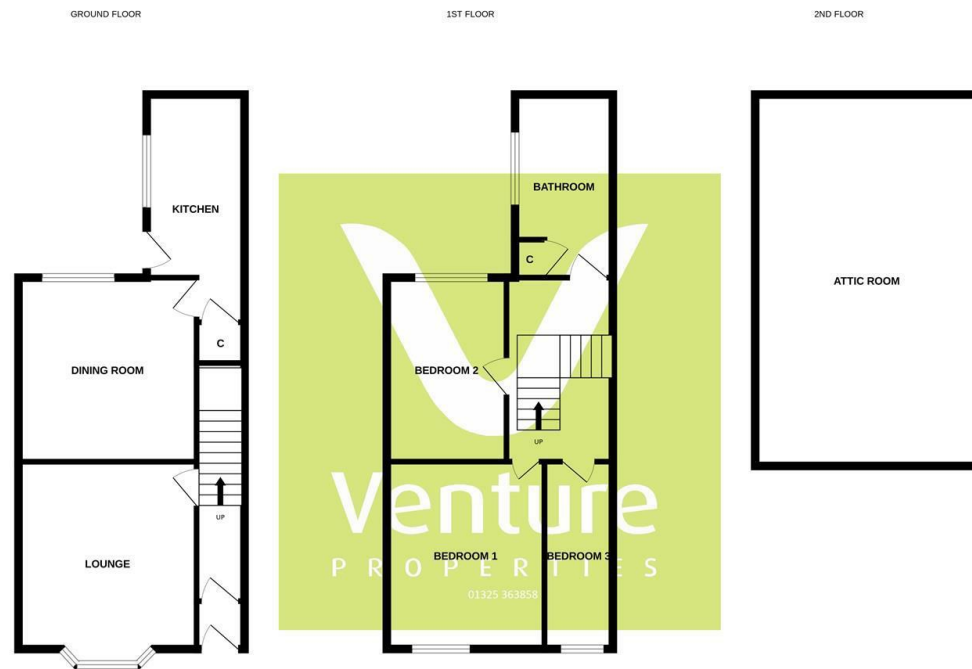

Whilst every attempt has been made to ensure the accuracy of the floorplan contained here, measurements of doors, windows, rooms and any other items are approximate and no responsibility is taken for any error, omission or mis-statement. This plan is for illustrative purposes only and should be used as such by any prospective purchaser. The services, systems and appliances shown have not been tested and no guarantee as to their operability or efficiency can be given.

Made with Metrepro ©2024.

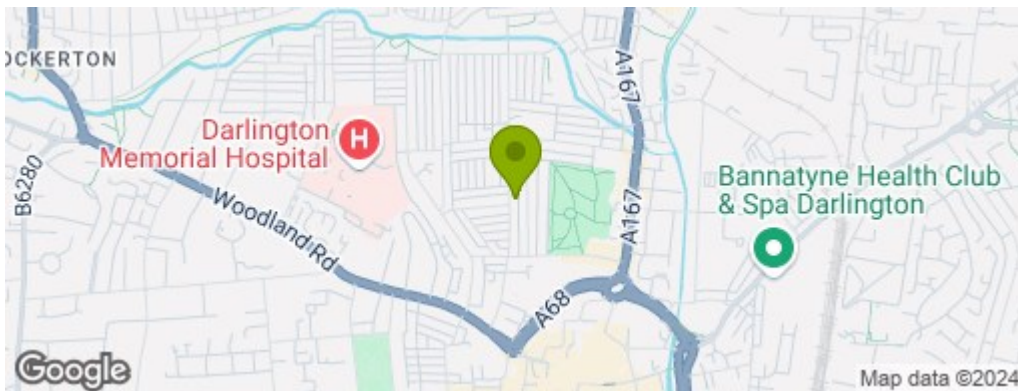

Property Information

01325 363858

45 Duke Street, Darlington, County Durham, DL3 7SD
sales@venturepropertiesuk.com