



Beaconsfield Street

Darlington DL3 6EP

Offers In The Region Of £75,000





This footer paragraph is an example only and should not be relied upon as complying with current legislation. These particulars, whilst believed to be accurate are set out as a general outline only for guidance and do not constitute any part of an offer or contract. Intending purchasers should not rely on them as statements of representation of fact, but must satisfy themselves by inspection or otherwise as to their accuracy. No person in this firm's employment has the authority to make or give any representation or warranty in respect of the property.



This footer paragraph is an example only and should not be relied upon as complying with current legislation. These particulars, whilst believed to be accurate are set out as a general outline only for guidance and do not constitute any part of an offer or contract. Intending purchasers should not rely on them as statements of representation of fact, but must satisfy themselves by inspection or otherwise as to their accuracy. No person in this firm's employment has the authority to make or give any representation or warranty in respect of the property.



Beaconsfield Street

Darlington DL3 6EP



- Two Bedroom Terraced Property
- No Onward Chain

- Close to Darlington Memorial Hospital
- Council Tax Band A

- Two Reception Rooms
- Epc Rating D

Welcome to this charming two-bedroom terrace home located on Beaconsfield Street in the sought-after Denes area of Darlington. This property is perfect for those looking to invest or step into their first home without any onward chain.

Upon entering, you are greeted by a cosy reception room, with a separate dining room ideal for relaxing or entertaining guests. The house boasts two well-appointed bedrooms, offering comfortable living spaces for individuals or small families. The bathroom provides convenience and completes the layout of this lovely home.

The location of this property is nestled in the popular Denes area of Darlington. Residents can enjoy the peaceful surroundings while still being close to local amenities, schools, and transport links.

Whether you are looking to start your property investment journey or searching for your first home, this two-bedroom terrace house offers a fantastic opportunity. Don't miss out on the chance to own a property in this desirable location. Contact us today to arrange a viewing and make this house your new home!

Entrance

Upvc door to front and radiator.

Lounge

13'11 x 11'11 (4.24m x 3.63m)

Upvbc double glazed window to front, fireplace with electric inset fire.

Dining Room

7'10 x 11'11 (2.39m x 3.63m)

Upvc double glazed window to rear, under stairs storage and radiator.

Kitchen

12'10 x 6'05 (3.91m x 1.96m)

Upvc double glazed windows to rear and side. There is also a door to the side.

Fitted with Cream wall, base and drawer units, stainless steel sink with mixer tap. There is also space for a cooker, washing machine and fridge.

Bedroom One

11'00 x 11'11 (3.35m x 3.63m)

Upvc double glazed window to front and radiator.

Bedroom Two

7'11 x 7'00 (2.41m x 2.13m)

Upvc double glazed window to rear and radiator.

Bathroom

Upvc double glazed window, Fitted with panelled bath and shower over, low level w/c, wash hand basin in vanity and heated towel rail.

Externally

To the rear is a gated enclosed yard.

Council Tax

Band A

Tenure

Freehold

Note

IMPORTANT NOTE TO PURCHASERS: We endeavour to make our sales particulars accurate and reliable, however, they do not constitute or form part of an offer or any contract and none is to be relied upon as statements of representation or fact. The services, systems and appliances listed in this specification have not been tested by us and no guarantee as to their operating ability or efficiency is given. All measurements have been taken as a guide to prospective buyers only, and are not precise. Floor plans where included are not to scale and accuracy is not guaranteed. If you require clarification or further information on any points, please contact us, especially if you are travelling some distance to view. Fixtures and fittings other than those mentioned are to be agreed with the seller. We cannot also confirm at this stage of marketing the tenure of this house

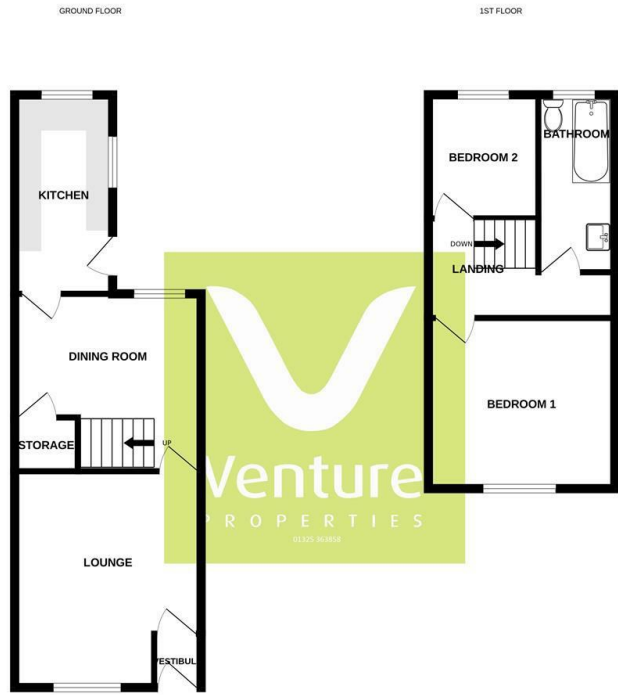

Whilst every attempt has been made to ensure the accuracy of the floorplan contained here, measurements of doors, windows, rooms and any other items are approximate and no responsibility is taken for any error, omission or mis-statement. This plan is for that given purpose only and should be used as such by any prospective purchaser. The services, systems and appliances shown here are for information only and no guarantee as to their operability or efficiency can be given. Made with iMagine CS2024

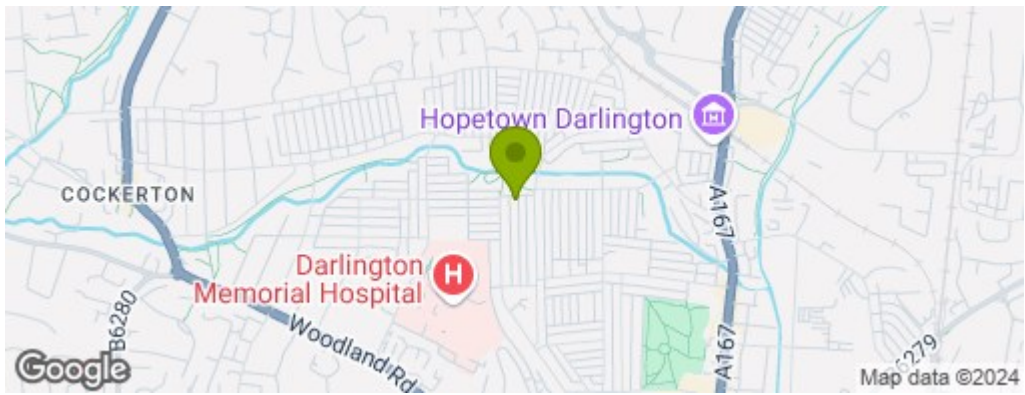

Property Information

01325 363858

45 Duke Street, Darlington, County Durham, DL3 7SD
sales@venturepropertiesuk.com