



**Mallard Road**

Darlington DL1 1BN

**Offers Over £130,000**





This footer paragraph is an example only and should not be relied upon as complying with current legislation. These particulars, whilst believed to be accurate are set out as a general outline only for guidance and do not constitute any part of an offer or contract. Intending purchasers should not rely on them as statements of representation of fact, but must satisfy themselves by inspection or otherwise as to their accuracy. No person in this firm's employment has the authority to make or give any representation or warranty in respect of the property.

# Mallard Road

Darlington DL1 1BN



- Semi-Detached
- Front and Rear Gardens

- Two Bedrooms
- Council Tax Band A

- Eastbourne Location
- Epc Rating D

This well presented two bedroom mature semi detached property is in ready to move into condition. The property has a well appointed lounge, open plan kitchen/dining room, two bedrooms to the first floor with a stylish bathroom. Externally the property has gardens to the front and rear with off street parking. The property is located in the Eastbourne area of Darlington within easy reach of many amenities including popular schools, shops and the railway station.

Viewing is recommended.

## Entrance Hall

Door to side, staircase to first floor landing, storage cupboard and radiator.

## Lounge

14'10 x 10'4 (4.52m x 3.15m)

Upvc double glazed window to front and radiator.

## Kitchen/Diner

27'7 x 10'5 (8.41m x 3.18m)

Two double glazed windows to rear, fitted with wall, base and drawer units and stainless steel sink. There is space for cooker, dishwasher, washing machine and tumble dryer. Under stairs storage and radiator.

## First Floor Landing

Access to loft via drop down ladder.

## Bedroom One

12'10 x 11'6 (3.91m x 3.51m)

Upvc double glazed window to front, fitted wardrobes and radiator.

## Bedroom Two

13'9 x 8'5 (4.19m x 2.57m)

Upvc double glazed window to rear and radiator.

## Bathroom

Upvc double glazed obscure window to rear, fitted bath with shower over and screen. W/c, wash hand basin and radiator.

## Externally

To the front there is

## Council Tax

Band A

## Tenure

Freehold

## Note

IMPORTANT NOTE TO PURCHASERS: We endeavour to make our sales particulars accurate and reliable, however, they do not constitute or form part of an offer or any contract and none is to be relied upon as statements of representation or fact. The services, systems and appliances listed in this specification have not been tested by us and no guarantee as to their operating ability or efficiency is given. All measurements have been taken as a guide to prospective buyers only, and are not precise. Floor plans where included are not to scale and accuracy is not guaranteed. If you require clarification or further information on any points, please contact us, especially if you are travelling some distance to view. Fixtures and fittings other than those mentioned are to be agreed with the seller. We cannot also confirm at this stage of marketing the tenure of this house

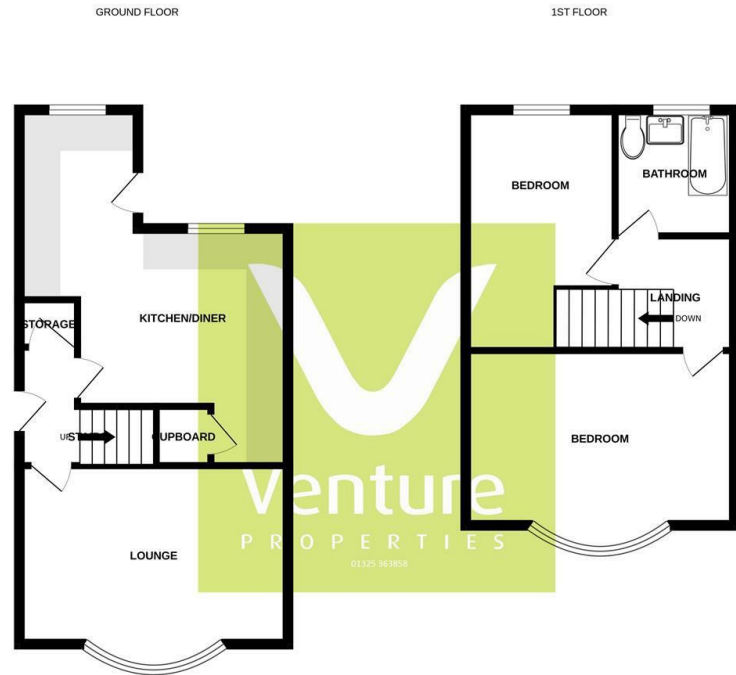

Whilst every attempt has been made to ensure the accuracy of the floorplan contained here, measurements of walls, windows, doors and any other items are approximate and no responsibility is taken for any error, omission or mis-statement. This plan is for illustrative purposes only and should be used as such by any prospective purchaser. The services, systems and appliances shown have not been tested and no guarantee as to their operability or efficiency can be given.  
Made with Metreps ©2024

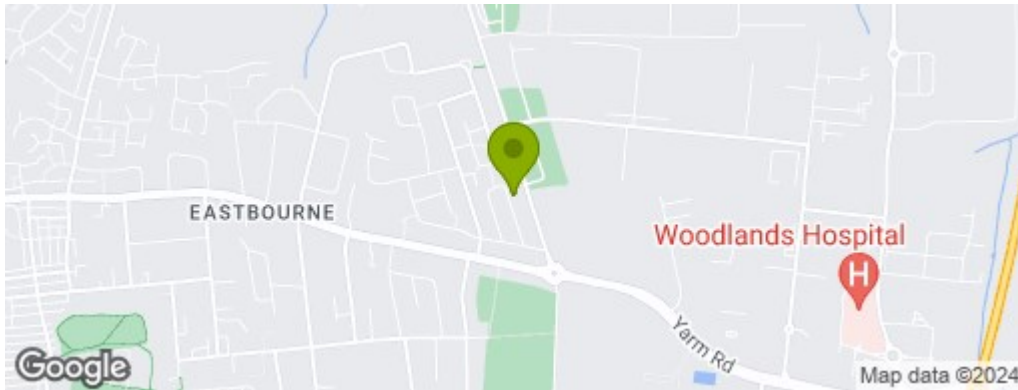

## Property Information

**01325 363858**

45 Duke Street, Darlington, County Durham, DL3 7SD  
sales@venturepropertiesuk.com