



VENTURE  
PLATINUM

Beckside Mews | Darlington  
£260,000



We offer to the market this three bedroom stone detached property located in the sort of village of Staindrop. The property is located within a quiet residential development overlooking the river with views of the close by Raby Castle, the property offers spacious living accommodation of two floors and briefly comprises entrance porch, lounge, dining room, kitchen, ground floor cloakroom. To the first floor you will find three bedrooms and a family bathroom. There is also an attached garage and an enclosed courtyard view is recommended

Stanhope has a thriving community and boasts both an Ofsted Outstanding primary and secondary school, a number of shops, cafes and tea rooms making it an ideal place to live and its famous for the medieval Raby Castle to the North of the village.

Porch

Lounge 5.46 x 4.14 (17'10" x 13'6")

Dining Room 4.1 x 3.15 (13'5" x 10'4")

Kitchen 5.5 x 3.6 (18'0" x 11'9")

Downstairs W/C

Bedroom One 3.63 x 2.74 (11'10" x 8'10".13'1")

Bedroom Two 3.2 x 3.15 (10'5" x 10'4")

Bedroom Three 2.64 x 2.6 (8'7" x 8'6")

Bathroom

Externally

Council Tax

Band D

Tenure

The Property is Freehold

Note

IMPORTANT NOTE TO PURCHASERS: We endeavour to make our sales particulars accurate and reliable, however, they do not constitute or form part of an offer or any contract and none is to be relied upon as statements of representation or fact. The services, systems and appliances listed in this specification have not been tested by us and no guarantee as to their operating ability or efficiency is given. All measurements have been taken as a guide to prospective buyers only, and are not precise. Floor plans where included are not to scale and accuracy is not guaranteed. If you require clarification or further information on any points, please contact us, especially if you are travelling some distance to view. Fixtures and fittings other than those mentioned are to be agreed with the seller. We cannot also confirm at this stage of marketing the tenure of this house











# 1 Beckside Mews | Darlington

GROUND FLOOR  
1146 sq.ft. (106.4 sq.m.) approx.

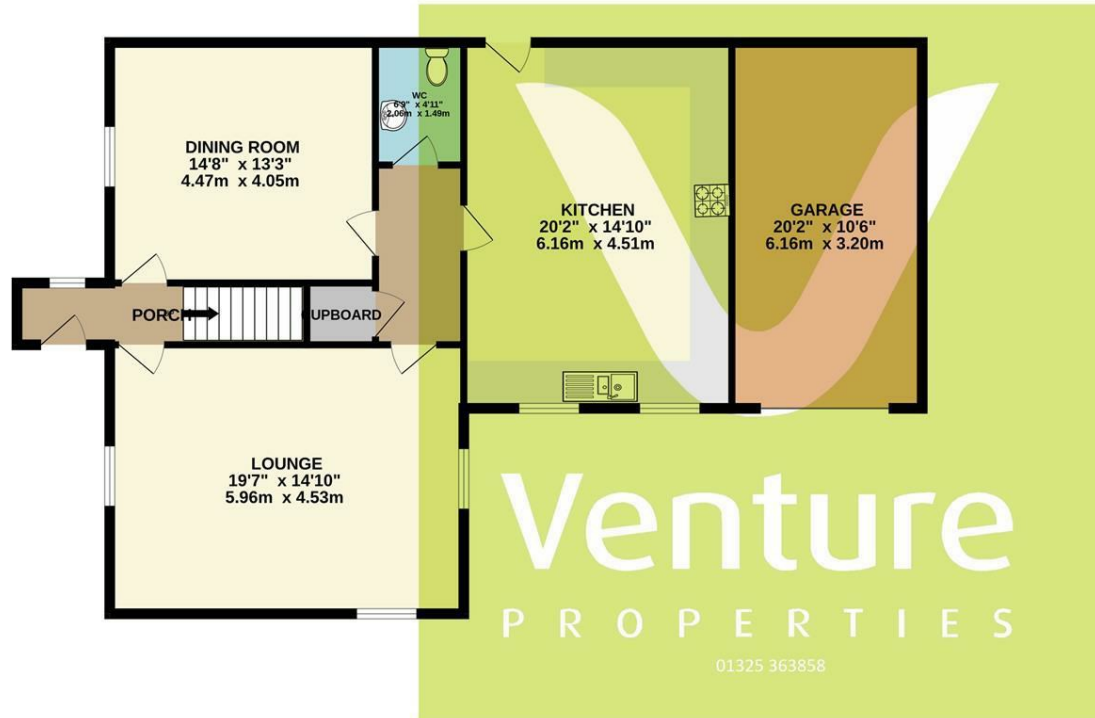

1ST FLOOR  
568 sq.ft. (52.8 sq.m.) approx.



TOTAL FLOOR AREA : 1714 sq.ft. (159.2 sq.m.) approx.

Whilst every attempt has been made to ensure the accuracy of the floorplan contained here, measurements of doors, windows, rooms and any other items are approximate and no responsibility is taken for any error, omission or mis-statement. This plan is for illustrative purposes only and should be used as such by any prospective purchaser. The services, systems and appliances shown have not been tested and no guarantee as to their operability or efficiency can be given.  
Made with Metropix ©2024

IMPORTANT: we would like to inform prospective purchasers that these sales particulars have been prepared as a general guide only. A detailed survey has not been carried out, nor the services, appliances and fittings tested. Room sizes should not be relied upon for furnishing purposes and are approximate. If floor plans are included, they are for guidance only and illustration purposes only and may not be to scale. If there are any important matters likely to affect your decision to buy, please contact us before viewing the property.

45 Duke Street, Darlington, County Durham,  
DL3 7SD

01325 363858  
[www.venturepropertiesuk.com](http://www.venturepropertiesuk.com)